

# Memo

**Date** 1 May 2024

To: Phill Reid, Manager Aucklandwide

From: Ewen Patience – Planner

**Subject: Plan Modification: Clause 20A modification to Auckland Unitary Plan – Corrections to Schedule 10, D13 Notable Trees Overlay, AUP**

Corrections are required to the Auckland Unitary Plan (operative in Part) 2016 (the AUP).

I seek your approval of this plan modification pursuant to clause 20A, First Schedule, Resource Management Act 1991 and Chapter D13 Notable Trees Overlay of the AUP(OP).

You have delegated authority, as a tier four manager, to make a decision to correct a minor error to an operative plan under clause 20A. Schedule 2A of the Auckland Council Combined Chief Executives Delegation Register authorises all powers, functions, and duties under RMA’s first schedule (except clause 17 which cannot be delegated) to tier four positions.

D13.4 Activity table of the AUP enables the automatic update of Schedule 10 Notable Trees Schedule under the following circumstances:



- a) Subdivision altering legal description of one or more trees
- b) Resource consent authorising the removal of one or more trees and the tree has been physically removed
- c) Resource consent for, or authorisation of, removal of tree as a result of emergency works (storm damage/disease/other).

In this case the modification relates to: Subdivision altering legal description of one or more trees.

<b>Rule or Section of Unitary Plan</b>	Chapter D13 Notable Trees Overlay -specifically D13.4- Activity Table; Schedule 10 Notable Trees Schedule: Tree ID 103 (2 Norfolk Pines)
<b>Subject Site</b>	18 Walker Road, Point Chevalier
<b>Current Legal Description</b>	Lot 16 Blk I DP 8345
<b>Nature of change</b>	<p>A Clause 20A modification is required in accordance with D13.4 to automatically update Schedule 10 of the AUP for the following reason:</p> <ul style="list-style-type: none"> <li>- As advised by the GIS team following the regular updating of the cadastral mapping data received from LINZ, a subdivision of the property has occurred and the legal description of the two trees has changed.</li> </ul> <p>The change corrects an error in the legal descriptions and addresses of two notable trees at 18 Walker Road (ID 103, Norfolk Island Pines). This error has arisen from the granting of resource consents to develop and</p>

	<p>subdivide the property (LUC60389885; SUB60389884). The trees are to be corrected in Schedule 10 so that they are located at 18D and 18E Walker Road (lots 4 and 3) respectively rather than at 18 Walker Road (the parent property).</p> <p>It is noted that the mapped locations of the trees have been corrected by way of a prior Clause 20A modification (24 April 2024) so that the trees are not at 18C and 18D but (correctly shown) at 18D and 18E Walker Road – refer Attachment 2.</p>																					
<b>Effect of change</b>	<p>(Subdivision) The effect of the modification is nil as the modification is authorised by the provisions of D13.4 AUP and the trees remain. The legal descriptions require updating as set out below. Two new entries to Schedule 10 are required with the existing entry (ID 103 for two trees) to be deleted.</p> <p>The landowner/s will be advised of the AUP modification once approved (and as soon as the new owner/address is in the Council system).</p>																					
<b>Changes required to be made (text/in-text diagrams)</b>	<p>Amend Schedule 10 Notable Tree Schedule of the AUP as follows:</p> <ul style="list-style-type: none"> <li><u>Delete</u> existing ID 103 (2 trees) and <u>add</u> the following two entries:</li> </ul> <table border="1" style="width: 100%; border-collapse: collapse;"> <thead> <tr> <th style="text-align: center;">ID</th> <th style="text-align: center;">Botanical Name</th> <th style="text-align: center;">Common Name</th> <th style="text-align: center;">Number of Trees</th> <th style="text-align: center;">Location/Street Address</th> <th style="text-align: center;">Locality</th> <th style="text-align: center;">Legal Description</th> </tr> </thead> <tbody> <tr> <td style="text-align: center;">3007</td> <td style="text-align: center;">Araucaria heterophylla</td> <td style="text-align: center;">Norfolk Island Pine</td> <td style="text-align: center;">1</td> <td style="text-align: center;">Walker Road 18D</td> <td style="text-align: center;">Pt Chevalier</td> <td style="text-align: center;">LOT 4 DP 580684, 1/5 SH LOT 6 580684</td> </tr> <tr> <td style="text-align: center;">3008</td> <td style="text-align: center;">Araucaria heterophylla</td> <td style="text-align: center;">Norfolk Island Pine</td> <td style="text-align: center;">1</td> <td style="text-align: center;">Walker Road 18E</td> <td style="text-align: center;">Pt Chevalier</td> <td style="text-align: center;">LOT 3 DP 580684, 1/5 SH LOT 6 580684</td> </tr> </tbody> </table>	ID	Botanical Name	Common Name	Number of Trees	Location/Street Address	Locality	Legal Description	3007	Araucaria heterophylla	Norfolk Island Pine	1	Walker Road 18D	Pt Chevalier	LOT 4 DP 580684, 1/5 SH LOT 6 580684	3008	Araucaria heterophylla	Norfolk Island Pine	1	Walker Road 18E	Pt Chevalier	LOT 3 DP 580684, 1/5 SH LOT 6 580684
ID	Botanical Name	Common Name	Number of Trees	Location/Street Address	Locality	Legal Description																
3007	Araucaria heterophylla	Norfolk Island Pine	1	Walker Road 18D	Pt Chevalier	LOT 4 DP 580684, 1/5 SH LOT 6 580684																
3008	Araucaria heterophylla	Norfolk Island Pine	1	Walker Road 18E	Pt Chevalier	LOT 3 DP 580684, 1/5 SH LOT 6 580684																
<b>Changes to be made to maps</b>	No changes are required to the GIS viewer (AUP Maps)																					
<b>Attachments</b>	<p>Any further relevant information/evidence to help the decision maker (if necessary):</p> <ul style="list-style-type: none"> <li>- Attachment 1: Map indicating the subdivision of the property</li> <li>- Attachment 2: Map indicating relocation of trees previously approved (24 April 2024)</li> <li>- Attachment 3: Corrected text</li> </ul>																					

<p><b>Prepared by:</b> Ewen Patience - Planner</p>	
<p><b>Signature:</b></p> 	

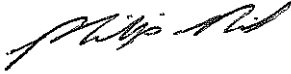
<p><b>Data or map/s or prepared by:</b> NA Geospatial Specialist</p>	<p><b>Reviewed by:</b> Lee-Ann Lucas Acting Team Leader</p>
<p><b>Signature:</b></p> 	<p><b>Signature:</b></p> 
<p><b>Decision:</b> I agree to authorise the Clause 20A modification using my delegated authority</p> <p>Phill Reid Manager Aucklandwide Date: 1 May 2024</p>	
<p><b>Signature:</b></p> 	

**Attachment 1:** Map indicating the subdivision of the property – 18 Walker Road, Point Chevalier



**Attachment 2:** Map indicating relocation of trees previously approved (24 April 2024)

*Refer to PDF that follows:*

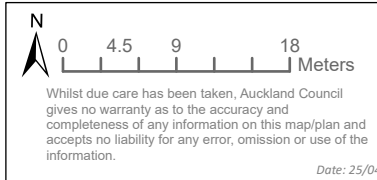
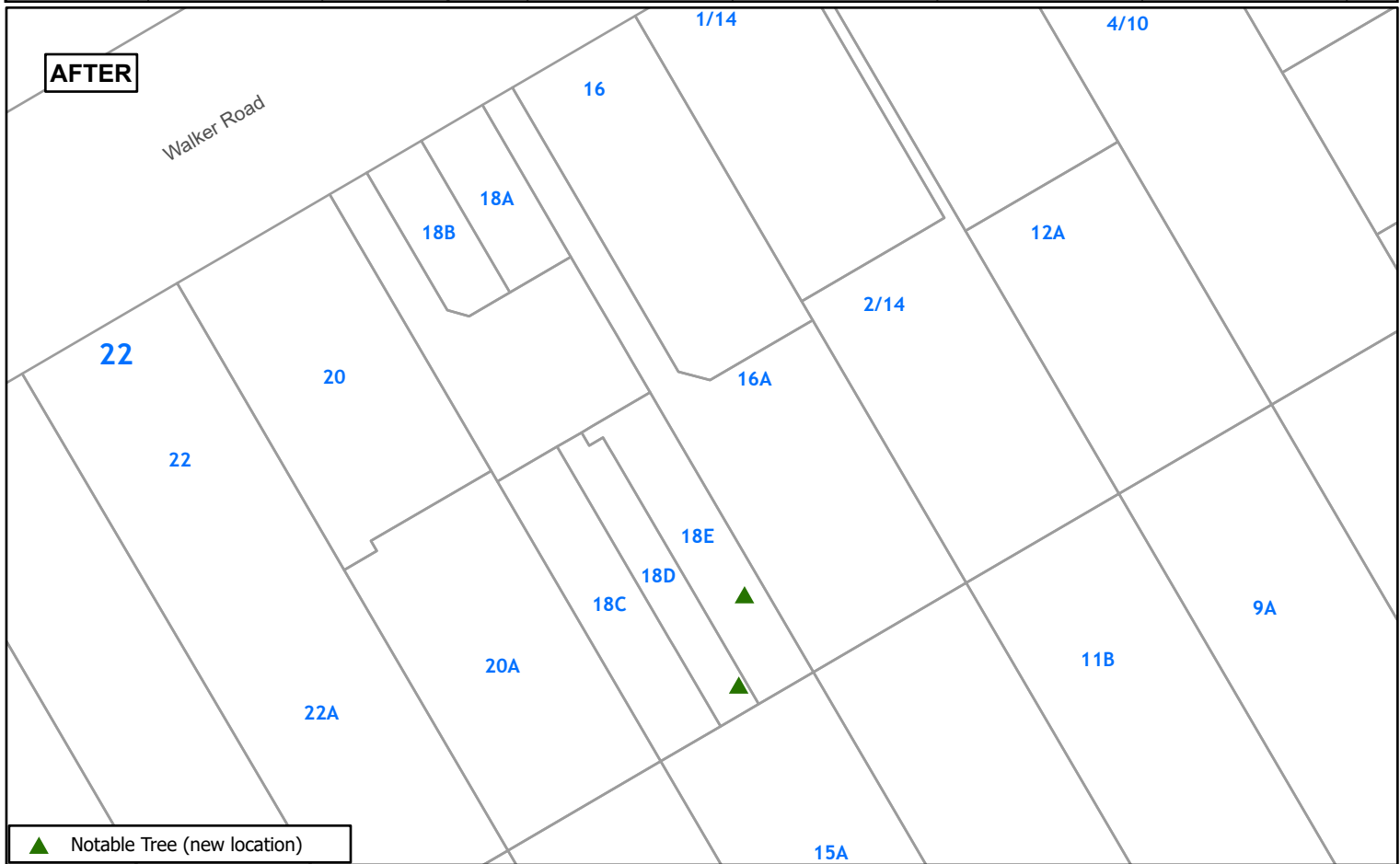
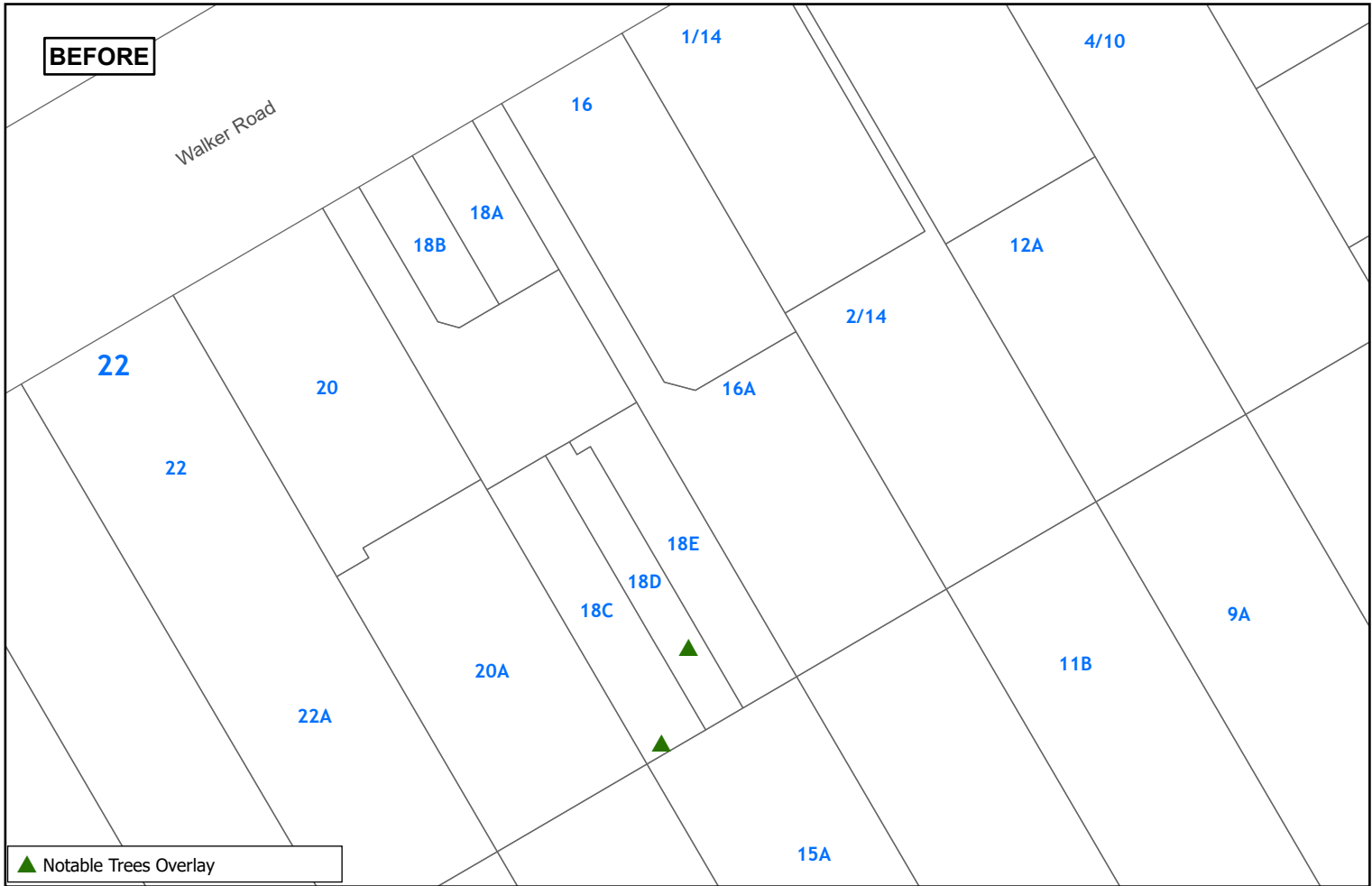

## Notable Trees Overlay (relocating tree locations as consent plan)

## **Attachment 3: Corrected text**

## Isthmus

ID	Botanical Name	Common Name	Number of Trees	Location/Street Address	Locality	Legal Description
205	<i>Vitex lucens</i>	Puriri		Akiraho Street 32	Mt Eden	Lot 22 DP 1252
967	<i>Quercus robur</i>	English Oak	1	Aldred Road 38	Remuera	Lot 6 DP 18117
915	<i>Metrosideros excelsa</i>	Pōhutukawa	4	Alexis Avenue 13	Mt Albert	Lot 1 DP 363566
916	<i>Dacrydium cupressinum</i>	Rimu	1	Alexis Avenue 13A	Mt Albert	Lot 2 DP 363566
831	<i>Metrosideros excelsa</i>	Pōhutukawa		Alford Street 76	Waterview	Lot 49 DP 18011
626	<i>Phoenix canariensis</i>	Phoenix Palm	2	Alfred Street 9,	Onehunga	Lot 2 DP 197172
978	<i>Metrosideros excelsa</i>	Pōhutukawa	1	Allendale Road 13	Mt Albert	Lot 1 DP 12629
919	<i>Metrosideros excelsa</i>	Pōhutukawa	1	Allendale Road 26	Mt Albert	Lot 2 DP 3280
920	<i>Dacrydium cupressinum</i>	Rimu	1	Allendale Road 38	Mount Albert	Lot 2 DP 18511
921	<i>Metrosideros excelsa</i>	Pōhutukawa	1	Allendale Road 42	Mount Albert	Lot 4 DP 18511
256	<i>Metrosideros excelsa</i>	Pōhutukawa	1	Allendale Road 44	Mount Albert	Lot 7 DP 144577
258	<i>Phoenix canariensis</i>	Phoenix Palm	2	Allendale Road 1/44	Mount Albert	
259	<i>Phoenix canariensis</i>	Phoenix Palm	2	Allendale Road 2/44	Mount Albert	Lot 2 DP 144577
979	<i>Vitex lucens</i>	Puriri	1	Allendale Road 69	Mount Albert	Lot 9 DP 13255
221	<i>Metrosideros excelsa</i>	Pōhutukawa	1	Almorah Place 16 (overhangs 10 Almorah Place and right of way access to 12 Almorah Place)	Epsom	Lot 1 DP 327766
876	<i>Metrosideros excels,</i> <i>Quercus robur</i>	Pōhutukawa, English Oak	2	Almorah Place 20	Newmarket	Lot 5 DP 23313
207	<i>Podocarpus totara</i>	Totara	1	Almorah Place 22	Epsom	Lot 4 DP 211537
807	<i>Metrosideros excelsa</i>	Pōhutukawa	1	Almorah Road 21	Epsom	Pt Allotment 33 SECT 6 SBRs OF Auckland
875	<i>Dacrydium cupressinum</i>	Rimu	1	Almorah Road 33	Epsom	Lot 1 DP 16707
805	<i>Corynocarpus laevigatus</i>	Karaka		Alpers Avenue 27A	Epsom	Lot 1 DP 209544
713	<i>Dacrydium cupressinum</i>	Rimu	1	Alverston Street 31	Waterview	Lot 22 SECT 5 DEEDS 7
832	<i>Metrosideros excelsa</i>	Pōhutukawa	1	Alverston Street 63	Waterview	Lot 4 DP 5072
455	<i>Podocarpus totara</i>	Totara	1	Amy Street 9	Ellerslie	Lot 1 DP 49369
454	<i>Metrosideros excelsa</i>	Pōhutukawa	1	Amy Street 12	Ellerslie	Lot 1 DP 164358
449	<i>Metrosideros excelsa</i>	Pōhutukawa	1	Amy Street 17 & 17A (between)	Ellerslie	Lot 2 DP 46476
447	<i>Podocarpus totara</i>	Totara	1	Amy Street 19	Ellerslie	Lot 1 DP 71266
446	<i>Podocarpus totara</i>	Totara	2	Amy Street 21	Ellerslie	Pt Lot 118 DEEDS
445	<i>Podocarpus totara</i>	Totara	2	Amy Street 23	Ellerslie	Lot 1 DP 164996
456	<i>Quercus robur</i>	English Oak	1	Amy Street 17/50	Ellerslie	Lot 1 DP 83339
3003	<i>Metrosideros excelsa</i>	Pōhutukawa	1	Angle Street 27-29	Te Papapa	Lot 1 DP 19312, Lot 2 DP 19930, Lot 3 DP 19930
708	<i>Metrosideros excelsa</i>	Pōhutukawa	1	Apihai Street 5	Orakei	Lot 2 DP 59108
309	<i>Agathis australis,</i> <i>Metrosideros excelsa</i>	Kauri, Pōhutukawa	Group	Aratonga Avenue (road reserve, whole street)	One Tree Hill	

## Isthmus

ID	Botanical Name	Common Name	Number of Trees	Location/Street Address	Locality	Legal Description
46	<i>Quercus robur</i>	English Oak	1	Ardmore Road 79 & Wanganui Avenue 82	Ponsonby	Lot 61 Blk 2 DP 3661
47	<i>Liquidambar orientalis</i>	Liquidambar	1	Argyle Street 73	Herne Bay	Pt Lot 3 DP 36494
725	<i>Agathis australis, Rhopalostylis sapida</i>	Kauri, Nikau Palm (3)	4	Arney Crescent 4	Remuera	Lot 1 DP 61166
939	<i>Metrosideros excelsa</i>	Pōhutukawa	2	Arney Road 1	Remuera	Lot 1 DP 49896
778	<i>Ulmus glabra 'horizontalis'</i>	Weeping Wych elm	1	Arney Road 9	Remuera	Lot 2 DP 49896
878	<i>Quercus robur</i>	English Oak	1	Arney Road 16	Remuera	Lot 1 DP 43486
880	<i>Agathis australis</i>	Kauri	1	Arney Road 50	Remuera	Pt Allotment 8 SBRS OF Auckland
225	<i>Metrosideros excelsa</i>	Pōhutukawa	1	Arney Road 92	Remuera	Lot 1 DP 48878
833	<i>Araucaria heterophylla (2), Podocarpus totara</i>	Norfolk Island Pine (2), Totara	3	Arney Road 139	Remuera	Lot 1 DP 48287
450	<i>Metrosideros excelsa</i>	Pōhutukawa	1	Arron Street 15	Ellerslie	Lot 1 DP 44557
448	<i>Quercus robur</i>	English Oak	1	Arthur Street 21B	Ellerslie	Lot 3 DP 211288
779	<i>Metrosideros excelsa</i>	Pōhutukawa	1	Arthur Street 43	Freemans Bay	Pt Allotment 19 SECT 8 SBRS OF Auckland
605	<i>Metrosideros excelsa</i>	Pōhutukawa	1	Arthur Street 75	Onehunga	Lot 2 DP 32277
610	<i>Metrosideros excelsa</i>	Pōhutukawa	1	Arthur Street 93	Onehunga	Lot 11 SECT 5 DEEDS 1387
627	<i>Metrosideros excelsa, Meryta sinclairii, Corynocarpus laevigatus</i>	Pōhutukawa, Puka, Karaka (8)	10	Arthur Street 122	Onehunga	Pt Allotment 7 SECT 19 VILL OF Onehunga
929	<i>Metrosideros robust, Quercus robur</i>	Northern Rata, English Oak	2	Ascot Avenue 3-9	Remuera	Lot 13 DP 279
819	<i>Vitex lucens</i>	Puriri	1	Ascot Avenue 10	Remuera	Lot 1 DP 63737
820	<i>Sequoia sempervirens, Cedrus atlantica</i>	Coast Redwood, Atlas Cedar	2	Ascot Avenue 24	Remuera	Lot 1 DP 33608
821	<i>Metrosideros excelsa</i>	Pōhutukawa	1	Ascot Avenue 34	Remuera	Lot 1 DP 82368
340	<i>Phoenix canariensis, Metrosideros excelsa, Araucaria heterophylla, Quercus robur</i>	Phoenix Palm (63), Pōhutukawa (1), Norfolk Island Pine (2), Oaks (20)	86	Ascot Avenue 80-100	Greenlane	, Lot 2 DP 406738, Lot 8 DP 515118, Lot 1 DP 195894
272	<i>Quercus ilex</i>	Holm Oak	1	Ashton Road 22	Mt Eden	Pt Lot 59 DP 1648
273	<i>Metrosideros excelsa</i>	Pōhutukawa	1	Ashton Road 24	Mt Eden	Pt Lot 58 DP 1648
409	<i>Nothofagus menziesii</i>	Silver Beech	1	Atarangi Road 23	Greenlane	Lot 2 DP 452893
550	<i>Metrosideros excelsa</i>	Pōhutukawa	1	Athens Road 4	Onehunga	Lot 1 DP 332193
545	<i>Vitex lucens</i>	Puriri	1	Athens Road 66-68	Onehunga	Pt Lot 27 DP 4720
143	<i>Pinus radiata Sequoiadendron giganteum, Araucaria heterophylla, Ulmus americana, Agathis robusta</i>	Radiata Pine (3), Giant Redwood/Wellingtonia, Norfolk Island Pine, American or White Elm, Queensland Kauri	7	Auckland Domain	Parnell	Pt Auckland Domain Survey Office Plan 13
654	<i>Ficus macrophylla</i>	Moreton Bay Fig	2	Avenue Road 70	Otahuhu	Lot 1 DP 38107
660	<i>Metrosideros excelsa</i>	Pōhutukawa	2	Avenue Road East 169	Otahuhu	Lot 7 DP 54684
242	<i>Quercus robur, Liquidambar styraciflua</i>	English Oak, Liquidambar	2	Avondale Road 103	Avondale	Lot 2 DP 122114



## Isthmus

ID	Botanical Name	Common Name	Number of Trees	Location/Street Address	Locality	Legal Description
676	<i>Carya illinoensis</i>	Pecan	2	Avondale Road 117	Avondale	Lot 16 DP 499026
114	<i>Sophora microphylla</i>	Kowhai	1	Baildon Road 39	Grey Lynn	Lot 6 Blk 51 DP 1720
457	<i>Metrosideros excelsa</i>	Pōhutukawa	1	Ballin Street 7	Ellerslie	Lot 5 DP 30960
895	<i>Metrosideros excelsa</i>	Pōhutukawa	1	Balmoral Road 46-48	Balmoral	Pt Lot 2 DP 43585
268	<i>Vitex lucens</i>	Puriri	1	Balmoral Road 148	Mt Eden	Lot 1 DP 169129
262	<i>Arecastrum romanzoffianum</i> , <i>Phoenix canariensis</i>	Queen Palm (2), Phoenix Palm (2)	4	Balmoral Road 173 (reserve – Potters Park)	Balmoral	Pt Allotment 107 SECT 10 SBRS OF Auckland
741	<i>Metrosideros excelsa</i>	Pōhutukawa	1	Balmoral Road 257	Sandringham	Lot 1 DP 80281
267	<i>Platanus acerifolia</i>	Plane Tree	1	Balmer Lane 5A (reserve – Paddington Green)	Balmoral	Lot 58 DP 95600
379	<i>Washingtonia filifera</i> <i>Phoenix canariensis</i> <i>Corynocarpus laevigatus</i>	Washington Palm (2), Phoenix Palm, Karaka	4	Banff Avenue 3	Epsom	Lot 3 DP 8506
749	<i>Metrosideros excelsa</i>	Pōhutukawa	2	Bank Street 8	Mount Eden	Lot 41 DP 4583
462	<i>Metrosideros excelsa</i>	Pōhutukawa	1	Barrack Road 128	Mt Wellington	Lot 25 DP 71671
812	<i>Araucaria heterophylla</i>	Norfolk Island Pine	1	Bassett Road 2	Remuera	Lot 3 DP 23743
811	<i>Metrosideros excelsa</i>	Pōhutukawa	1	Bassett Road 14	Remuera	Lot 1 DP 23743
893	<i>Magnolia grandiflora</i>	Southern Magnolia	1	Bassett Road 42	Remuera	Lot 1 DP 50702
227	<i>Podocarpus totara</i>	Totara	2	Bassett Road 133A	Remuera	Lot 2 DP 452524
900	<i>Podocarpus totara</i> , <i>Dacrydium Cupressinum</i>	Totara , Rimu	14	Batkin Road 1/26	New Windsor	Lot 4 DP 65815
355	<i>Podocarpus totara</i>	Totara	17	Batkin Road 28A	New Windsor	Lot 2 DP 470165
609	<i>Metrosideros excelsa</i>	Pōhutukawa	2	Beachcroft Avenue 96	Onehunga	Pt Allotment 2 SECT 20 VILL OF Onehunga
501	<i>Metrosideros excelsa</i>	Pōhutukawa	1	Beckenham Avenue 4a	Royal Oak	Lot 2 DP 180980
881	<i>Podocarpus totara</i>	Totara	1	Bell Road 83	Remuera	Lot 1 DP 17355
882	<i>Podocarpus totara</i>	Totara	1	Bell Road 85	Remuera	Lot 2 DP 17355
719	<i>Metrosideros excelsa</i>	Pōhutukawa	1	Bellevue Road 69A	Mount Eden	Lot 1 DP 186116
863	<i>Metrosideros excelsa</i>	Pōhutukawa	2	Benson Road 49	Remuera	Lot 1 DP 161789
236	<i>Rhus succedanea</i>	Wax Tree	1	Benson Road 79,	Remuera	Lot 1 DP 188826
894	<i>Vitex lucens</i>	Puriri	1	Benson Road 93	Remuera	Lot 2 DP 64010
366	<i>Prunus serrulata</i>	Japanese Cherry	Group	Bingley Avenue (road reserve)	Epsom	
144	<i>Vitex lucens</i>	Puriri	1	Birdwood Crescent 21	Parnell	Lot 2 DP 399655
354	<i>Metrosideros excelsa</i>	Pōhutukawa	1	Blockhouse Bay Road 186	Blockhouse Bay	Lot 3 DP 37992
603	<i>Pinus radiata</i>	Pine	8	Blockhouse Bay Road 572-578 (reserve – Avondale South Domain)	Blockhouse Bay	Pt Allotment 361 PSH OF Waikomiti
604	<i>Vitex lucens</i>	Puriri	1	Blockhouse Bay Road 615	Blockhouse Bay	Lot 3 DP 73347
764	<i>Metrosideros excelsa</i>	Pōhutukawa	1	Bollard Avenue 55	New Windsor	Lot 7 DP 15922

## Isthmus

ID	Botanical Name	Common Name	Number of Trees	Location/Street Address	Locality	Legal Description
353	<i>Quercus robur</i>	English Oak	1	Bollard Avenue 56	New Windsor	Pt Section 30 Methuen HAM
200	<i>Metrosideros excelsa, Vitex lucens, Alectryon excelsus, Rhopalostylis sapida</i>	Pōhutukawa (4), Puriri (3), Titoki (2), Nikau Palm	10	Bourne Street 9	Mt Eden	Lot 1 DP 27230
901	<i>Metrosideros robusta</i>	Northern Rata, Pōhutukawa, Kahikatea, Totara		Bowling Avenue 17	Epsom	Lot 2 DP 41998
362	<i>Araucaria heterophylla</i>	Norfolk Island Pine	1	Bowling Avenue 18	Epsom	Lot 2 DP 18239
521	<i>Podocarpus totara</i>	Totara	1	Boyd Avenue 1	Royal Oak	Lot 1 DP 199575
1005	<i>Metrosideros excelsa</i>	Pōhutukawa	1	Bracken Avenue 28	Epsom	Lot 1 DP 112155
798	<i>Metrosideros excelsa</i>	Pōhutukawa	2	Bridgewater Road 23	Parnell	Lot 1 DP 58422
213	<i>Metrosideros excelsa, Hymenosporum flavum</i>	Pōhutukawa, Australian Frangipani	2	Brightside Road 3	Epsom	Lot 1 DP 188920
898	<i>Vitex lucens</i>	Puriri	1	Brightside Road 6	Epsom	Lot 5 DP 3541
363	<i>Araucaria heterophylla, Metrosideros excelsa</i>	Norfolk Island Pine, Pōhutukawa	2	Buckley Road 17	Epsom	Lot 11 DP 4533
48	<i>Metrosideros excelsa</i>	Pōhutukawa	1	Buller Street 1/2A	Freemans Bay	Lot 2 DP 60348
248	<i>Quercus robur</i>	English Oak	1	Burch Street 10	Mt Albert	Lot 5 DP 114455
139	<i>Metrosideros excelsa</i>	Pōhutukawa	1	Burleigh Street 2-10	Grafton	Part Allot 2 Sec 6 SBR/SOF Auckland
874	<i>Quercus robur</i>	English Oak		Burwood Crescent 5	Parnell	Lot 1 DP 48686
504	<i>Dacrydium cupressinum</i>	Rimu	1	Campbell Road 30	One Tree Hill	Lot 21 DEEDS 142
522	<i>Metrosideros excelsa</i>	Pōhutukawa	1	Campbell Road 36	One Tree Hill	Lot 1 DP 386535
503	<i>Agathis australis</i>	Kauri	2	Campbell Road 38	One Tree Hill	Lot 4 DP 4949
502	<i>Metrosideros excelsa</i>	Pōhutukawa	2	Campbell Road 61	One Tree Hill	Lot 1 DP 37574
551	<i>Dacrydium cupressinum</i>	Rimu	1	Campbell Road 72	One Tree Hill	Lot 87 DP 15669
537	<i>Podocarpus totara</i>	Totara	1	Campbell Road 103	One Tree Hill	Lot 1 DP 43152
552	<i>Vitex lucens, Lagunaria patersonii</i>	Puriri, Norfolk Island Hibiscus	2	Campbell Road 113	One Tree Hill	Pt Lot 14 DP 3646
413	<i>Metrosideros excelsa</i>	Pōhutukawa	2	Campbell Road 116	One Tree Hill	Lot 65 DP 15669
411	<i>Fagus sylvatica 'pupurea'</i>	Copper Beech	1	Campbell Road 162	Greenlane	Lot 42 DP 16295
410	<i>Ulmus glabra 'camper-down'</i>	Weeping Elm	1	Campbell Road 164	Greenlane	Lot 41 DP 16295
407	<i>Cupressus macrocarpa horizontalis aurea, Quercus robur, Araucaria bidwillii, Araucaria heterophylla</i>	Golden Macrocarpa, English Oak, Bunya Bunya Pine, Norfolk Island Pine	4	Campbell Road 187	Greenlane	Lot 1 DP 59046
404	<i>Agathis australis</i>	Kauri	1	Campbell Road 194F	One Tree Hill	Lot 6 DP 434590
408	<i>Vitex lucens</i>	Puriri	1	Campbell Road 193-195	Greenlane	Pt Lot 2 DP 19430
412	<i>Liquidambar styraciflua</i>	Liquidambar	1	Campbell Road 196	Greenlane	Lot 6 DP 18843
426	<i>Vitex lucens</i>	Puriri	1	Campbell Road 214	Greenlane	Lot 1 DP 48848
441	<i>Metrosideros excelsa</i>	Pōhutukawa	1	Campbell Road 257A	Greenlane	Lot 2 DP 328424
763	<i>Metrosideros excelsa</i>	Pōhutukawa	1	Canal Road 54	Avondale	Lot 2 DP 49577
631	<i>Metrosideros excelsa</i>	Pōhutukawa	1	Captain Springs Road 130	Te Papapa	Lot 1 DP 65373
180	<i>Metrosideros excelsa</i>	Pōhutukawa	1	Cardigan Street 42	Morningside	Lot 1 DP 148357

## Isthmus

ID	Botanical Name	Common Name	Number of Trees	Location/Street Address	Locality	Legal Description
789	<i>Vitex lucens</i>	Puriri	1	Cardwell Street 61	Onehunga	Lot 51 Deeds Reg 011, Lot 50 Deeds Reg O11
801	<i>Metrosideros excelsa</i>	Pöhutukawa	1	Carlton Gore Road 27	Newmarket	Lot 1 DP 91349
142	<i>Celtis australis, Quercus robur, Cedrus deodara</i>	Nettle Tree, English Oak (4), Himalayan Cedar	6	Carlton Gore Road 53 (reserve)	Newmarket	Lot 9 DP 19010
715	<i>Vitex lucens</i>	Puriri	1	Carrick Place 12	Mt Eden	Lot 9 DP 182
173	<i>Alectryon excelsus, Erythrina crista-galli, Jacaranda mimosifolia, Ginkgo biloba</i>	Titoki, Brazilian Coral (3), Jacaranda, Maidenhair Tree	6	Carrington Road 1	Point Chevalier	Lot 4 DP 314949
724	<i>Metrosideros excelsa</i>	Pöhutukawa	1	Castle Drive 2	Epsom	Lot 1 DP 60772
452	<i>Araucaria heterophylla</i>	Norfolk Island Pine	1	Cawley Street 20	Ellerslie	Lot 1 DP 56730
886	<i>Dacrydium cupressinum; Corynocarpus laevigatus; Podocarpus totara; Agathis australis; Vitex lucens</i>	Rimu, Karaka, Totara, Kauri, Puriri (2)	6	Cedar Road 16	Epsom	Lot 4 DP 17763
930	<i>Agathis australis</i>	Kauri	1	Cedar Road 23	Mount Eden	Lot 2 DP 52183
834	<i>Araucaria araucana</i>	Monkey Puzzle	1	Charlton Avenue 4	Mount Eden	Lot 22 DP 7130
656	<i>Podocarpus totara</i>	Totara	1	Church Street 118	Otahuhu	Allotment 9 SECT 7 VILL OF Otahuhu
655	<i>Metrosideros excelsa</i>	Pöhutukawa	2	Church Street 123-141	Otahuhu	Lot 1 DP 187921
628	<i>Metrosideros excelsa</i>	Pöhutukawa	1	Church Street 125	Onehunga	Lot 1 DP 89948
618	<i>Quercus robur</i>	English Oak	2	Church Street 130	Onehunga	Lot 1 DP 321652
620	<i>Metrosideros excelsa</i>	Pöhutukawa	3	Church Street 208A	Onehunga	Lot 2 DP 44961
872	<i>Metrosideros excelsa,</i>	Pöhutukawa	1	Clarendon Road 43 & 47	St Heliers	Lot 2 DP 79406
392	<i>Metrosideros excelsa</i>	Pöhutukawa	1	Claude Road 1-3	Epsom	Lot 2 DP 3293
380	<i>Vitex lucens</i>	Puriri	1	Claude Road 6	Epsom	Lot 2 DP 40909
382	<i>Metrosideros excelsa</i>	Pöhutukawa	1	Claude Road 17	Epsom	Lot 3 DP 12435
383	<i>Metrosideros robusta, Dacrydium cupressinum</i>	Rata,Rimu	2	Claude Road 23A	Epsom	Lot 1 DP 184261
402	<i>Metrosideros excelsa</i>	Pöhutukawa	1	Claude Road 23B	Epsom	Lot 2 DP 184261
384	<i>Vitex lucens</i>	Puriri	1	Claude Road 26	Epsom	Lot 1 DP 430211
385	<i>Phoenix canariensis</i>	Phoenix Palm	2	Claude Road 37	Epsom	Lot 2 DP 9494
54	<i>Cupressus macrocarpa, Metrosideros excelsa</i>	Macrocarpa (2), Pöhutukawa	3	Clifton Road 2-12	Herne Bay	Lot 32 ALLT 4 Section 8 SBRS OF Auckland
50	<i>Metrosideros excelsa</i>	Pöhutukawa	1	Clifton Road 22	Herne Bay	Section 3 SO 63118
49	<i>Metrosideros excelsa</i>	Pöhutukawa	4	Clifton Road 28A	Herne Bay	Lot 2 DP 190939
191	<i>Vitex lucens</i>	Puriri	1	Clive Road 24	Mount Eden	Lot 3 DP 18407
189	<i>Vitex lucens, Ficus macrophylla Platanus acerifolia Vitex lucens</i>	Puriri Grove, Moreton Bay Fig, Plane Tree, Puriri	4	Clive Road, (reserve - Puriri Grove; Mt Eden Domain, Memorial to Norman Kirk)	Mount Eden	Pt Allotment 1A SECT 6 SBRS OF Auckland
315	<i>Metrosideros excelsa</i>	Pöhutukawa	1	Clonbern Road 51	Remuera	Lot 1 DP 28236

## Isthmus

ID	Botanical Name	Common Name	Number of Trees	Location/Street Address	Locality	Legal Description
487	<i>Quercus robur</i>	English Oak	1	Coates Crescent 32	Panmure	Lot 226 DP 46408
711	<i>Vitex lucens</i>	Puriri	1	Colchester Avenue 24	Glendowie	Lot 284 DP 20612
992	<i>Quercus falcata</i>	Southern Red Oak	1	Connaught Street 90	Green Bay	Lot 1 DP 45710
755	<i>Agathis australis</i>	Kauri	1	Corbett-Scott Avenue 3	Epsom	Lot 1 DP 99132
835	<i>Metrosideros excelsa</i>	Pōhutukawa	1	Corbett Scott Avenue 4	Epsom	Lot 1 DP 32581
406	<i>Sequoia sempervirens</i>	Redwood	6	Cornwall Park (near kiosk)	Epsom	Pt Allotment 11 SECT 12 SBRS OF Auckland
403	<i>Beilschmiedia tarairi</i>	Taraire	23	Cornwall Park (Park boundary, southern side Greenlane Road West)	Greenlane	Pt Allotment 10 SECT 12 SBRS OF Auckland
367	<i>Olea europaea</i>	Olive Grove (approx 200)	Group	Cornwall Park (adjacent to Claude & Crescent Roads)	Greenlane	Pt Allotment 9 SECT 12 SBRS OF Auckland
824	<i>Liriodendron tulipifera</i>	Tulip tree	1	Coronation Road 9	Epsom	Lot 1 DP 53493
887	<i>Metrosideros excelsa</i>	Pōhutukawa		Coronation Road 31	Epsom	Lot 2 DP 46076
476	<i>Metrosideros excelsa, Vitex lucens</i>	Pōhutukawa, Puriri	2	Court Crescent 30	Panmure	Lot 153 DP 21465
488	<i>Metrosideros excelsa</i>	Pōhutukawa	1	Court Crescent 39	Panmure	Lot 76 DP 21465
601	<i>Quercus robur, Vitex lucens</i>	English Oak, Puriri	2	Cove Lane 3	Mt Wellington	Lot 23 DP 150834
386	<i>Metrosideros excelsa</i>	Pōhutukawa	1	Crescent Road 18	Epsom	Lot 3 DP 18376
825	<i>Dacrydium cupressinum</i>	Rimu	1	Crescent Road, 29	Epsom	Lot 1 DP 147518
973	<i>Vitex lucens</i>	Puriri	1	Cromwell Street 1	Mount Eden	Lot 49 DP 1927
106	<i>Agathis australis</i>	Kauri	1	Cumberland Avenue 8	Westmere	Lot 166 DP 17365
71	<i>Metrosideros excelsa</i>	Pōhutukawa	1	Curran Street 9	Herne Bay	Lot 1 DP 36627
72	<i>Quercus robur</i>	English Oak	1	Curran Street 50	Herne Bay	Pt Allotment 9 SECT 8 SBRS OF Auckland
940	<i>Araucaria heterophylla</i>	Norfolk Island Pine	1	Denbigh Avenue 56 Mount Roskill	Mount Roskill	Lot 2 DP 196013
335	<i>Metrosideros excelsa</i>	Pōhutukawa	3	Derry Street 1	Greenlane	Lot 1 DP 128278
743	<i>Metrosideros excelsa</i>	Pōhutukawa	1	Dexter Avenue 27	Mount Eden	Lot 47 DP 4665
744	<i>Dacrydium cupressinum</i>	Rimu	1	Dexter Avenue 42	Mount Eden	Lot 31 DP 4665
687	<i>Araucaria heterophylla</i>	Norfolk Island Pine	1	2-8 Dilworth Terrace	Parnell	Lot 1 DP 97009
746	<i>Dacrydium cupressinum</i>	Rimu	1	Disraeli Street 1	Mount Eden	Pt Lot 1 DP 4311
926	<i>Dacrydium cupressinum</i>	Rimu	1	Disraeli Street 18	Mount Eden	Lot 5 DP 4763
972	<i>Metrosideros excelsa</i>	Pōhutukawa	1	Domain Drive 12A	Parnell	Lot 1 DP 201994
478	<i>Metrosideros excelsa</i>	Pōhutukawa	8	Domain Road (corner Lagoon Drive, frontage)	Panmure	Pt Allotments 63, 77, 78 & 79 SECT 2 VILL OF Panmure
186	<i>Quercus suber</i>	Cork Oak	2	Dominion Road 114	Mt Eden	Lot 1 DP 121009
185	<i>Metrosideros excelsa</i>	Pōhutukawa	2	Dominion Road 136	Mt Eden	Pt Allotment 9 SECT 10 SBRS OF Auckland
948	<i>Araucaria heterophylla</i>	Norfolk Island Pine	1	Dominion Road 242a	Mount Eden	Lot 2 DP 19805
261	<i>Metrosideros excelsa</i>	Pōhutukawa	2	Dominion Road 443	Mt Eden	Pt Allotment 132 SECT 10 SBRS OF Auckland
269	<i>Cedrus deodara</i>	Cedar	2	Dominion Road 488	Mt Eden	Section 16 SO
767	<i>Alectryon excelsus</i>	Titoki	1	Dominion Road 968	Mount Roskill	Section 4 SO 447335

## Isthmus

ID	Botanical Name	Common Name	Number of Trees	Location/Street Address	Locality	Legal Description
944	<i>Quercus spp</i>	Oak	1	Dominion Road 1356-1358	Mount Roskill	Pt Lot 340 DP 19327
917	<i>Araucaria heterophylla</i>	Norfolk Island Pine	1	Douglas Avenue 20	Mt Albert	Lot 49 DP 18011
918	<i>Podocarpus totara</i>	Totara	4	Douglas Road 24	Mount Eden	Lot 15 DP 8789
780	<i>Metrosideros excelsa</i>	Pōhutukawa	1	Douglas Street 39	Ponsonby	Lot 1 DP 137330
736	<i>Podocarpus totara</i>	Totara	1	Duart Avenue 24	Mt Albert	Lot 4 DP 20125
483	<i>Quercus robur</i>	English Oak	1	Dunkirk Road 14- 50 (reserve - Mt Wellington War Memorial Reserve)	Panmure	Pt Lot 286 DP 39428
444	<i>Araucaria heterophylla</i>	Norfolk Island Pine	1	Eaglehurst Road 30-34	Ellerslie	Lot 2 DP 153772
453	<i>Syzygium floribundum, Metrosideros excelsa</i>	Weeping Lilly Pilly, Pōhutukawa	2	Eaglehurst Road 36	Ellerslie	Lot 1 DP 167980
862	<i>Cedrus deodara, Cupressus cashmeriana</i>	Himalayan Cypress, Bhutan Cedar	2	Edgerley Avenue 18	Epsom	Lot 1 DP 108492
2980	<i>Metrosideros excelsa</i>	Pōhutukawa	1	Eglinton Avenue 8	Mt Eden	Pt Lot 9 DP 6701
458	<i>Metrosideros excelsa</i>	Pōhutukawa	1	Ellerslie Park Road 12	Ellerslie	Lot 9 DP 6989
265	<i>Metrosideros excelsa, Vitex lucens, Knightia excelsa, Podocarpus totara</i>	Pōhutukawa, Puriri, Rewarewa, Totara (2)	5	Ellerton Road 43	Mt Eden	Pt Lot 97 DP 4583
903	<i>Vitex lucens, Metrosideros excelsa</i>	Puriri (2), Pōhutukawa	3	Empire Road 60	Epsom	Pt Lot 24 DP 2722
864	<i>Dacrydium cupressinum</i>	Rimu	1	Epsom Avenue 17	Epsom	Lot 97 DP 4065
817	<i>Dacrydium cupressinum</i>	Rimu	1	Epsom Avenue 28	Epsom	Lot 4 DP 5072
284	<i>Metrosideros excelsa, Vitex lucens, Podocarpus totara, Corynocarpus laevigatus, Fagus sylvatica, Juglans ailantifolia, Quercus rubra, Ficus macrophylla, Vitex lucens</i>	Group A, Pōhutukawa (Avenue of 31). Group B, Pōhutukawa (4), Puriri (3), Totara (3), Group C, Pōhutukawa (4). Group D, Totara (2), Karaka. Group E, Copper Beech, Japanese Walnut, Red Oak, Moreton Bay Fig, Group F, Puriri, (located on road reserve)	53	Epsom Avenue 74	Epsom	Section 2 SO 67900
293	<i>Agathis robusta, Araucaria bidwillii, Platanus acerifolia</i>	South Queensland Kauri, Bunya Bunya Pine, London Plane (2)	4	Erin Street 2	Epsom	Lot 1 DP 156942
974	<i>Metrosideros excelsa</i>	Pōhutukawa	3	Esplanade Road 50	Mount Eden	Pt Lot 15 DEEDS
194	<i>Jacaranda mimosifolia</i>	Jacaranda	1	Esplanade Road 64	Mt Eden	Pt Lot 36 DP 1903
734	<i>Podocarpus totara</i>	Totara	1	Fairlands Avenue 12	Waterview	Lot 110 DP 17586
280	<i>Vitex lucens</i>	Puriri	1	Fairview Road 10	Mt Eden	Lot 1 DP 46047
906	<i>Vitex lucens, Podocarpus totara, Metrosideros excelsa, Corynocarpus laevigatus</i>	Puriri (2), Totara, Pōhutukawa, Karaka	5	Felix Street 7	Te Papapa	Lot 1 DP 79610
571	<i>Metrosideros excelsa, Vitex lucens</i>	Pōhutukawa, Puriri	2	Felix Street 37 (corner May Road)	Te Papapa	Lot 1 DP 56118
570	<i>Vitex lucens</i>	Puriri	1	Felix Street 39-41	Te Papapa	Lot 2 DP 56118
934	<i>Podocarpus totara</i>	Totara	1	Fergusson Avenue 9	Sandringham	Lot 8 DP 18996

## Isthmus

ID	Botanical Name	Common Name	Number of Trees	Location/Street Address	Locality	Legal Description
923	<i>Metrosideros excelsa</i>	Pōhutukawa	1	Fergusson Avenue 33	Sandringham	Lot 20 DP 18996
399	<i>Metrosideros excelsa</i>	Pōhutukawa	1	Fern Ave 7	Epsom	Lot 3 DP 44512
902	<i>Dacrydium cupressinum</i>	Rimu	1	Ferryhill Road 28	Mount Eden	Lot 68 DP 16969
714	<i>Quercus robur</i>	English Oak	1	Finch Street 48	Western Springs	Lot 1 DP 52992
607	<i>Araucaria heterophylla</i>	Norfolk Island Pine	1	Forbes Street 1	Onehunga	Lot 2 DP 17594
520	<i>Phoenix canariensis</i>	Phoenix Palm	1	Forbes Street 30A	Onehunga	Lot 13 DP 18272
69	<i>Platanus acerifolia</i>	London Plane (approx. 112)	Group	Franklin Road (road reserve – whole street)	Ponsonby	
617	<i>Quercus robur, Castanea sativa</i>	English Oak, Sweet Chestnut	2	Galway Street 89-97	Onehunga	Lot 2 DP 321652
553	<i>Ginkgo biloba</i>	Ginkgo	1	Galway Street 118	Onehunga	IOT 3 pt Lot 4 SEC 5 ONEHUNGA VILLAGE L62068
629	<i>Platanus acerifolia</i>	London Plane	3	Galway Street (road reserve outside #43)	Onehunga	
387	<i>Fagus sylvatica 'pupurea'</i>	Copper Beech	1	Gardner Road 3	Epsom	Lot 2 DP 65728
105	<i>Quercus robur</i>	English Oak	1	Garnet Road 81	Westmere	Pt Allotment 5 SECT 9 SBRS OF Auckland
42	<i>Metrosideros excelsa</i>	Pōhutukawa	1	Garnet Road (road reserve outside #224)	Grey Lynn	LOT 18 DP 14279
630	<i>Quercus robur</i>	English Oak	1	Gerrard Beeson Place (road reserve at end of street)	Onehunga	
146	<i>Quercus robur</i>	English Oak	1	Gibraltar Crescent 5	Parnell	
686	<i>Sequoia sempervirens</i>	Coast Redwood	3	Gibraltar Crescent 55-77	Parnell	Lot 13 DP 338490
861	<i>Metrosideros excelsa</i>	Pōhutukawa	1	Gilgit Road 8	Epsom	Lot 2 DP 13616
892	<i>Metrosideros excelsa</i>	Pōhutukawa	1	Gillies Avenue 66-68	Epsom	Pt Allotment 22 SECT 6 SBRS OF Auckland
1002	<i>Vitex lucens, Podocarpus totara, Taxodium distichum</i>	Puriri (4), Totara, Swamp Cypress	6	Gillies Avenue 74	Epsom	Lot 1 DP 313509
998	<i>Camellia; Phoenix canariensis; Vitex lucens; Coprosma; Knightia excelsa; Corynocarpus laevigatus; Creepers sp.; Banana Palm; Avocado; Celery creeper; Quercus ilex, Vitex lucens; Macropiper; Howea forsteriana; Ponga Fern sp.; Livingstonia Palm; Corynocarpus laevigatus; Melicytus ramiflorus; Bleeding heart tree; Agathis australis; Podocarpus totara; Phoenix canariensis; Rhopalostylis sapida; Ironleaf; Ferns sp.; Agapanthus; Flax sp.; Coprosma, cupressus torulosa, Fagus sylvatica "Atropurpurea", Libocedrus plumosa, Corynocarpus laevigatus, Phoenix canariensis, Drimys winteri, Cordyline australis</i>	Camellia, Phoenix palm, Puriri, Coprosma, Rewarewa, Karaka, Creepers sp., Banana Palm, Avocado, Celery creeper, Holm Oak, Puriri, Macropiper, Kentia Palm, Ponga Fern, Livingstonia Palm, Karaka, Mahoe, Bleeding heart tree, Kauri, Totara, Phoenix palm, Nikau Palm, Ironleaf, Ferns, Agapanthus, Flax sp., Coprosma, Himalayan Cypress, Copper Beech, Kawaka, Phoenix Palm, Winter's Bark, Cabbage tree		Gillies Avenue 76	Epsom	Lot 2 DP 313509
214	<i>Stenocarpus sinuatus</i>	Australian Firewheel Tree	1	Gillies Avenue 147	Epsom	Lot 3 DP 52878
289	<i>Podocarpus totara, Quercus robur, Photinia serrulata</i>	Totara, English Oak, Chinese Hawthorn	3	Gillies Avenue 161	Epsom	Lot 2 DP 31498

## Isthmus

ID	Botanical Name	Common Name	Number of Trees	Location/Street Address	Locality	Legal Description
2962	<i>Crytocarya obovate</i>	Australian Laurel	1	Gillies Avenue, 183	Epsom	Lot 10 DP 14375
291	<i>Jacaranda mimosifolia</i>	Jacaranda	1	Gillies Avenue 187, Epsom (Rocklands Hall)	Epsom	Lot 11 DP 14375
682	<i>Araucaria heterophylla</i>	Norfolk Island Pine	1	Gladstone Road 12-20	Parnell	Lot 1 DP 67880
147	<i>Metrosideros excelsa</i>	Pōhutukawa	1	Gladstone Road 53	Parnell	Lot 2 DP 30461
89	<i>Metrosideros excelsa</i>	Pōhutukawa	2	Gladstone Road 112	Parnell	Lot 1 DP 181652
87	<i>Metrosideros excelsa</i> , <i>Kunzea ericoides</i>	Pōhutukawa, Kanuka	2	Gladstone Road (reserve - Sir Dove Myer Robinson Park)	Parnell	Pt Allotment 5 SECT 2 SBRS OF Auckland
908	<i>Podocarpus totara</i>	Totara	1	Glanville Terrace 22	Parnell	Lot 1 DP 65583
663	<i>Quercus robur</i>	English Oak (Avenue of 27)	Group	Golf Avenue 41	Otahuhu	Pt Land Claim 269A Fairburns Grant
932	<i>Agathis australis</i>	Kauri	1	Golf Road 4	Epsom	Lot 5 DP 38768
904	<i>Vitex lucens</i>	Puriri	1	Golf Road 19	Epsom	Lot 21 DP 4200
388	<i>Metrosideros excelsa</i>	Pōhutukawa	1	Golf Road 20	Epsom	Lot 3 DP 31418
368	<i>Metrosideros excelsa</i>	Pōhutukawa	1	Golf Road 24	Epsom	Pt DP 9571
369	<i>Metrosideros excelsa</i>	Pōhutukawa	5	Golf Road 28	Epsom	Lots 2 & 3 DP 33921
389	<i>Agathis australis</i>	Kauri	1	Golf Road (road reserve next to #31)	Epsom	
469	<i>Metrosideros excelsa</i>	Pōhutukawa	1	Gollan Road 6	Mt Wellington	Lot 187 DP 19355
140	<i>Metrosideros excelsa</i>	Pōhutukawa	2	Grafton Road 110	Grafton	Lot 1 DP 143678
884	<i>Podocarpus totara</i>	Totara	1	Grand View Drive 21a	Remuera	Lot 1 DP 197598
737	<i>Araucaria heterophylla</i>	Norfolk Island Pine	1	Grande Avenue 22 Mt Albert	Mt Albert	Lot 42 DP 17682
957	<i>Rhopalostylis sapida</i>	Nikau	1	Grange Road 5	Mount Eden	Lot 31 DP 1985
946	<i>Metrosideros excelsa</i>	Pōhutukawa		Grange Road 17	Mt Eden	Pt Lot 3 DP 30497
982	<i>Metrosideros excelsa</i>	Pōhutukawa	4	Grange Road 28	Mt Eden	Lot 3 DP 10586
126	<i>Metrosideros excelsa</i> , <i>Quercus robur</i> , <i>Quercus palustris</i>	Pōhutukawa (2), English Oak (3), Pin Oak	6	Great North Road 64-68	Newton	Lot 1 DP 201282
730	<i>Cupressus macrocarpa</i> , <i>Populus spp</i>	Macrocarpa, Poplar (3)	4	Great North Road, 1817	Avondale	Lot 1 DP 514556
351	<i>Sophora microphylla</i> , <i>Quercus robur</i> , <i>Metrosideros excelsa</i> , <i>Vitex lucens</i> , <i>Alectryon excelsus</i> , <i>Podocarpus totara</i>	Kowhai, English Oak Pōhutukawa (3), Puriri (4), Titoki, Totara (2)	Group	Great North Road 1910-1940	Avondale	Pt Allotment 64 PSH OF Titirangi
316	<i>Podocarpus totara</i>	Totara	2	Great South Road 171D and 171E	Greenlane	Lot 9 DP 404208, Lot 4 DP 432064
317	<i>Agathis australis</i>	Kauri	1	Great South Road 211	Greenlane	Pt Lot 1 DP 3855
421	<i>Podocarpus totara</i> , <i>Alectryon excelsus</i> , <i>Phoenix canariensis</i>	Totara, Titoki, Phoenix Palm (2)	4	Great South Road 337	Ellerslie	Pt Lot 18 DP 16452
427	<i>Eucalyptus ficifolia</i>	Red Flowering Gum	1	Great South Road 417- 419	Ellerslie	Lot 1 DP 170991
428	<i>Podocarpus totara</i> , <i>Litsea calicularis</i> , <i>Ilex aquifolium</i> , <i>Alectryon excelsus</i> , <i>Metrosideros excelsa</i> , <i>Populus nigra 'italica'</i>	Totara (3), Mangeao, Holly, Titoki, Pōhutukawa (2), Lombardy Poplar	9	Great South Road 421-455A,	Penrose	Pt Lot 2 DP 15722
425	<i>Quercus robur</i>	English Oak	1	Great South Road 473	Penrose	Pt Lot 9 DP 2317
665	<i>Metrosideros excelsa</i>	Pōhutukawa	1	Great South Road 560	Otahuhu	Lot 1 DP 74303

## Isthmus

ID	Botanical Name	Common Name	Number of Trees	Location/Street Address	Locality	Legal Description
442	<i>Agathis australis</i>	Kauri	2	Great South Road 620	Greenlane	Pt Lot 6 DP 8117
669	<i>Araucaria heterophylla</i>	Norfolk Island Pine	2	Great South Road 623	Otahuhu	Lot 1 DP 172615
634	<i>Phoenix canariensis, Metrosideros excelsa</i>	Phoenix Palm, Pōhutukawa (2)	3	Great South Road 1048-1050	Mt Wellington	Lot 12 DP 168505
638	<i>Platanus acerifolia</i>	London Plane	4	Great South Road 1066	Mount Wellington	Lot 1 DP 168170
337	<i>Podocarpus totara</i>	Totara	1	Green Lane East 64	Remuera	Lot 3 DP 13322
339	<i>Podocarpus totara</i>	Totara	1	Green Lane East 66	Greenlane	Lot 2 DP 13322
338	<i>Metrosideros excelsa</i>	Pōhutukawa	1	Green Lane East 68	Greenlane	Lot 1 DP 186577
688	<i>Quercus robur</i>	Common Oak	3	Green Lane East 90	Greenlane	Lot 1 DP 192625
333	<i>Metrosideros excelsa, Quercus robur, Phoenix canariensis, Agathis australis</i>	Pōhutukawa (2), English Oak, Phoenix Palm, Kauri	5	Green Lane West 193	Greenlane	Pt Allotment 10 SECT 12 SBRS OF Auckland
390	<i>Quercus ilex, Metrosideros excelsa</i>	Holm Oak, Pōhutukawa	2	Green Lane West 216	Greenlane	Lot 1 DP 372468
518	<i>Araucaria heterophylla</i>	Norfolk Island Pine	1	Grey Street 43	Onehunga	Pt Lot 9 DP 14032
540	<i>Vitex lucens</i>	Puriri	1	Grey Street 77-83	Onehunga	Allotment 2 SECT 5 VILL OF Onehunga
304	<i>Quercus robur</i>	English Oak	1	Griffin Avenue 13 (reserve)	Epsom	Lot 1 DP 66311
70	<i>Sequoia sempervirens</i>	Redwood	1	Gwilliam Place (road reserve at end of cul-de-sac)	Freemans Bay	
74	<i>Dacrydium cupressinum, Vitex lucens</i>	Rimu Puriri	2	Hackett Street 38	St Marys Bay	Lot 1 DP 373646
73	<i>Phoenix canariensis</i>	Phoenix Palm	1	Hackett Street 51	St Marys Bay	Lot 1 DEEDS Blue E
299	<i>Araucaria heterophylla</i>	Norfolk Island Pine	2	Halifax Avenue 28B	Epsom	Lot 2 DP 413830
692	<i>Platanus acerifolia</i>	London Plane	53	Hakanoa Street (road reserve – whole street)	Grey Lynn	
52	<i>Phoenix canariensis</i>	Phoenix Palm	4	Hamilton Road 3	Herne Bay	Pt Lot 2 DP 1364
693	<i>Magnolia grandiflora, Podocarpus totara</i>	Southern Magnolia (2), Totara	3	Hamilton Road 17	Herne Bay	Lot 2 DP 95603
51	<i>Metrosideros excelsa</i>	Pōhutukawa	1	Hamilton Road 61	Herne Bay	Lot 1 DEEDS 1228
913	<i>Podocarpus totara</i>	Totara	1	Hapua Street 21	Remuera	Lot 12 DP 37678
810	<i>Podocarpus totara; Kunzea ericoides</i>	Kanuka, Totara		Hapua Street 25A	Remuera	Lot 2 DP 190332
836	<i>Vitex lucens</i>	Puriri	1	Harcourt Street 4	Grey Lynn	Lot 9 Blk 12 DP 329
873	<i>Metrosideros excelsa</i>	Pōhutukawa	1	Harcourt Street 15	Grey Lynn	Lot 22 Blk 11 DP 329
468	<i>Vitex lucens</i>	Puriri	1	Harding Avenue 27	Mt Wellington	Lot 1 DP 311779
463	<i>Ulmus procera</i>	Elm	1	Harris Road 5	Mt Wellington	Lot 33 DP 19356
927	<i>Agathis australis</i>	Kauri	1	Henley Road 53	Mount Eden	Lot 34 DP 8591
128	<i>Platanus acerifolia</i>	Plane Tree	4	Hepburn Street (road reserve outside #3-9)	Freemans Bay	
925	<i>Agathis Australis</i>	Kauri	1	Herbert Road 12	Mt Eden	Lot 2 DP 53673



## Isthmus

ID	Botanical Name	Common Name	Number of Trees	Location/Street Address	Locality	Legal Description
823	<i>Corynocarpus laevigatus</i>	Karaka	1	Heywood Crescent 6	Epsom	Lot 12 DP 8087
781	<i>Metrosideros excelsa</i>	Pöhutukawa	1	Hillsborough Road 40	Hillsborough	Lot 2 DP 187772
496	<i>Araucaria heterophylla</i>	Norfolk Island Pine	1	Hillsborough Road 50	Three Kings	Lot 1 DP 210872
774	<i>Metrosideros excelsa</i>	Pöhutukawa	1	Hillsborough Road 67	Hillsborough	Pt Lot 1 DP 27166
497	<i>Quercus ilex, Araucaria cunninghamii, Ficus macrophylla, Lagunaria patersonia, Cedrus atlantica, Araucaria bidwillii, Liriodendron tulipifera, Araucaria heterophylla, Agathis robusta</i>	Holm Oak(2), Hoop Pine, Moreton Bay Fig, Norfolk Is. Hibiscus, Atlas Cedar, Bunya Bunya Pine, Tulip Tree, Norfolk Island Pine, Queensland Kauri	10	Hillsborough Road 72A	Mt Roskill	Pt Lot 2 DP 380498
612	<i>Metrosideros excelsa</i>	Pöhutukawa	2	Hill Street 46,	Onehunga	Pt Lot 7 DEEDS O 20
613	<i>Metrosideros excelsa</i>	Pöhutukawa	1	Hill Street 52	Onehunga	Lot 2 DEEDS O 20
544	<i>Agathis australis</i>	Kauri	1	Hoheria Road 5	Onehunga	Lot 1 DP 390834
813	<i>Agathis australis</i>	Kauri	1	Homai Street 3	Remuera	Lot 1 DP 41639
1010	<i>Phoenix canariensis</i>	Phoenix Palm	1	Hopetoun Street 3	Freemans Bay	Lot 40 DEEDS City 44
206	<i>Quercus robur</i>	English Oak	1	Horoeka Avenue 1, Mount Eden	Mount Eden	Lot 1 DP 463513
202	<i>Metrosideros excelsa</i>	Pöhutukawa	2	Horoeka Avenue 14	Mt Eden	Lot 1 DP 373540
137	<i>Araucaria heterophylla, Quercus robur, Metrosideros excelsa</i>	Norfolk Island Pine, English Oaks, Pöhutukawa		Howe Street 14-16	Freemans Bay	Pt Section 55 Auckland CITY
138	<i>Platanus acerifolia</i>	London Planes (approx. 80)	Group	Howe Street (road reserve – whole street), Freemans Bay (avenue of trees, whole street)	Freemans Bay	
633	<i>Populus nigra 'italica,' Platanus acerifolia</i>	Poplar (22), London Planes (7)	31	Hugo Johnston Drive (road reserve - O'Rorke Road Ext.)	Penrose	
174	<i>Metrosideros excelsa</i>	Pöhutukawa	1	Huia Road 9	Pt Chevalier	Lot 184 DP 9764
141	<i>Vitex lucens</i>	Puriri	1	Huntly Avenue 24	Grafton	Lot 21 DP 2098
513	<i>Quercus cerris</i>	Turkey Oak	1	Inkerman Street 16A-24	Onehunga	Lot 1 DP 94577
512	<i>Vitex lucens</i>	Puriri	1	Inkerman Street 20	Onehunga	Lot 2 DP 29607
524	<i>Metrosideros excelsa</i>	Pöhutukawa	1	Inkerman Street 30A	Onehunga	Lot 1 DP 38685
525	<i>Juglans regia</i>	Walnut	2	Inkerman Street 33	Onehunga	Lot 10 DEEDS 676
509	<i>Agathis australis</i>	Kauri	2	Inkerman Street 39	Onehunga	Lot 3 DEEDS 676
465	<i>Metrosideros excelsa</i>	Pöhutukawa	4	Ireland Road 28A	Panmure	Lot 2 DP 61417
466	<i>Araucaria heterophylla</i>	Norfolk Island Pine	1	Ireland Road 38	Panmure	Lot 2 DP 43084
470	<i>Agathis australis</i>	Kauri	1	Ireland Road 2/115	Panmure	Lot 1 DP 116257
471	<i>Metrosideros excelsa</i>	Pöhutukawa	1	Ireland Road (road reserve outside #37)	Panmure	
495	<i>Platanus acerifolia</i>	London Plane	1	James Preston Avenue 1	Mt Roskill	Lot 1481 DP 18564
472	<i>Metrosideros excelsa</i>	Pöhutukawa	1	Jellicoe Road 7-9	Mt Wellington	Section 1 SO 458625

## Isthmus

ID	Botanical Name	Common Name	Number of Trees	Location/Street Address	Locality	Legal Description
464	<i>Metrosideros excelsa</i>	Pōhutukawa	1	Jellicoe Road (road reserve outside #60)	Mt Wellington	
733	<i>Taxus baccata fastigiata</i> , <i>Podocarpus totara</i>	Irish Yew		Jerram Street 3	Mount Albert	Lot 180 DP 18860
694	<i>Vitex lucens</i>	Puriri	1	Jervois Road 141	Herne Bay	Lot 4 DP 44370
55	<i>Metrosideros excelsa</i>	Pōhutukawa	1	Jervois Road 272	Herne Bay	Lot 2 DP 201632
782	<i>Vitex lucens</i>	Puriri	1	John Street 120	Ponsonby	Lot 31 DEEDS P 17
244	<i>Quercus robur</i> , <i>Metrosideros excelsa</i>	English Oak, Pōhutukawa	2	Jomac Place 1	Avondale	Lot 25 DP 437082
555	<i>Liriodendron tulipifera</i>	Tulip Tree	1	Jordan Avenue 3	Onehunga	Lot 5 DP 48904
554	<i>Quercus palustris</i> , <i>Populus nigra 'italica'</i>	Pin Oak (2), Lombardy Poplar (2)	4	Jordan Avenue 9	Onehunga	Lot 2 DP 190524
88	<i>Metrosideros excelsa</i> <i>Cupressus macrocarpa</i> <i>Quercus robur</i>	Pōhutukawa, Macrocarpa, English Oak	3	Judge Street 12	Parnell	Pt Allotment 3 SECT 2 SBRS OF Auckland
871	<i>Sequoiadendron giganteum</i>	Giant Redwood/ Wellingtonia	1	Judges Bay Road 11	Parnell	Lot 1 DP 50033
691	<i>Araucaria bidwillii</i> , <i>Cinnamomum camphora</i>	Bunya Bunya Pine, Camphor Laurel	2	Judges Bay Road 7,	Parnell	Lot 2 DP 50033
928	<i>Vitex lucens</i>	Puriri	1	Kakariki Avenue 9	Mount Eden	Lot 4 DP 53122
423	<i>Quercus robur</i> , <i>Metrosideros excelsa</i>	English Oak, Pōhutukawa	2	Kalmia Street 12	Ellerslie	Lot 24 DP 11823
429	<i>Metrosideros excelsa</i>	Pōhutukawa	2	Kalmia Street 22	Ellerslie	Lot 2 DP 74166
237	<i>Quercus robur</i>	English Oak	4	Kelvin Road 17A	Remuera	Pt Lot 6 DP 43876
430	<i>Metrosideros excelsa</i>	Pōhutukawa	1	Kentucky Street 8	Ellerslie	Lot 18 DP 7074
723	<i>Metrosideros excelsa</i>	Pōhutukawa	1	Khyber Pass Road 373	Newmarket	Lot 1 DP 69520
2959	<i>Quercus robur</i>	English oak	1	Kimberley Road, 9B	Epsom	Lot 4 DP 494092
303	<i>Vitex lucens</i>	Puriri	1	Kimberley Road 11A	Epsom	Lot 2 DP 494092
984	<i>Dacrycarpus dacrydioides</i>	Kahikatea	1	Kimberley Road 26	Epsom	Pt Lot 8 DP 2332
484	<i>Vitex lucens</i>	Puriri	1	Kings Road 65	Panmure	Lot 1 DP 61805
485	<i>Ficus macrophylla</i>	Moreton Bay Fig	1	Kings Road 85	Panmure	Lot 1 DP 595108
489	<i>Platanus acerifolia</i> , <i>Quercus rubra</i>	London Plane Tree, Red Oak	2	Kings Road 87	Panmure	Lot 2 DP 392912
486	<i>Podocarpus totara</i> <i>Metrosideros excelsa</i>	Totara, Pōhutukawa	2	Kings Road 89	Panmure	Lot 1 DP 392912
766	<i>Metrosideros excelsa</i>	Pōhutukawa	1	Kingsford Road 14	Balmoral	Lot 7 DP 22984
116	<i>Corymbia ficifolia</i>	Red Flowering Gum	1	Kingsley Street 2	Grey Lynn	Lot 1 A 938
750	<i>Vitex lucens</i>	Puriri	1	Kingsview Road 6A	Mount Eden	Lot 2 DP 367922
969	<i>Metrosideros excelsa</i>	Pōhutukawa		Kingsview Road 27	Mount Eden	Lot 6 DP 37471
924	<i>Dacrycarpus dacrydioides</i>	Kahikatea		Kingsway Avenue 55	Sandringham	Lot 104 DP 5019
837	<i>Metrosideros excelsa</i>	Pōhutukawa	1	Kirk Street 21	Arch Hill	Pt Allotment 14 SECT 7 SBRS OF Auckland
738	<i>Agathis australis</i>	Kauri	1	Kitenui Avenue 56	Mount Albert	Lot 74 DP 11225
838	<i>Metrosideros excelsa</i>	Pōhutukawa	1	Kitenui Avenue 84	Mount Albert	Lot 8 DP 19399
981	<i>Podocarpus totara</i>	Totara	1	Kiwitea Street 1-5	Sandringham	Lot 1 DP 85017

## Isthmus

ID	Botanical Name	Common Name	Number of Trees	Location/Street Address	Locality	Legal Description
166	<i>Quercus robur</i>	English Oak	1	Kohimarama Road 65 (reserve)	Kohimarama	Lot 1 DP 28945
165	<i>Araucaria heterophylla</i>	Norfolk Island Pine	2	Kohimarama Road 177	Kohimarama	Lot 27 DP 27807
318	<i>Quercus canariensis</i> , <i>Agathis australis</i>	Algerian Oak, Kauri	2	Korau Road 7	Greenlane	Lot 16 DP 25557
312	<i>Ulmus glabra</i>	Elm	1	Korau Road 14	Greenlane	Lot 23 DP 25557
311	<i>Ulmus glabra</i>	Elm	1	Korau Road 16	Greenlane	Lot 22 DP 25557
498	<i>Cinnamomum camphora</i> , <i>Quercus cerris</i>	Camphor Laurel, Turkey Oak (2)	3	Korma Road 30	Royal Oak	Lot 3 DP 327333
43	<i>Vitex lucens</i>	Puriri	1	Kotare Avenue 3A	Westmere	Lot 1 DP 120050
709	<i>Metrosideros excelsa</i>	Pōhutukawa	1	Kurahaupo Street 45	Orakei	Lot 296 DP 58659
670	<i>Vitex lucens</i>	Puriri	2	Kuranui Place 5B	Otahuhu	Pt Section 2 Blk VI Otahuhu SD
342	<i>Metrosideros excelsa</i>	Pōhutukawa	1	Ladies Mile 112	Ellerslie	Lot 28 DP 7838
341	<i>Metrosideros excelsa</i> , <i>Ulmus glabra</i>	Pōhutukawa, (2) Wych Elm	3	Ladies Mile 118	Ellerslie	Part Lot 30 DP 7838, Lot 31 DP 7838
431	<i>Metrosideros excelsa</i>	Pōhutukawa	1	Ladies Mile 170	Ellerslie	Lot 1 DP 324725
432	<i>Metrosideros excelsa</i>	Pōhutukawa	1	Ladies Mile 170D	Ellerslie	Lot 1 DP 140735
490	<i>Metrosideros excelsa</i>	Pōhutukawa	8	Lagoon Drive 36-46	Panmure	Allotment 45 SECT 2 VILL OF Panmure
989	<i>Metrosideros excelsa</i>	Pōhutukawa	1	Landscape Road 5	Mount Eden	Eden
961	<i>Metrosideros excelsa</i>	Pōhutukawa	1	Landscape Road 7	Epsom	Lot 19 DP 6826
962	<i>Metrosideros excelsa</i>	Pōhutukawa	1	Landscape Road 8	Epsom	Lot 3 DP 19644
783	<i>Metrosideros excelsa</i>	Pōhutukawa	1	Landscape Road 9	Mount Eden	Lot 2 DP 53440
987	<i>Metrosideros excelsa</i>	Pōhutukawa	1	Landscape Road 11	Epsom	Lot 1 DP 53440
943	<i>Agathis australis</i>	Kauri	1	Landscape Road 13	Mount Eden	Lot 1 DP 99091
988	<i>Araucaria cunninghamii</i>	Hoop Pine	1	Landscape Road 14	Mount Eden	Pt Lot 1 DP 7015
839	<i>Quercus robur</i>	English Oak	1	Levonias Street 23	Western Springs	Allotment 52 SECT 5 SBRS OF Auckland
391	<i>Metrosideros excelsa</i>	Pōhutukawa	1	Lewin Road 1A	Epsom	Lot 37 DP 4280
378	<i>Vitex lucens</i>	Puriri	1	Lewin Road 6	Epsom	Lot 3 DP 17113
931	<i>Agathis australis</i>	Kauri	1	Lewin Road 16	Epsom	Pt Lot 23 DP 7434
377	<i>Vitex lucens</i> , <i>Phoenix canariensis</i>	Puriri, Phoenix Palm (3)	4	Lewin Road 19	Epsom	Lot 2 DP 33754
241	<i>Fraxinus excelsior</i> 'aurea'	Golden Ash	1	Line Road 50	Glen Innes	Lot 39 DP 42355
365	<i>Metrosideros excelsa</i>	Pōhutukawa	1	Liverpool Street 27	Epsom	Lot 3 DP 42495
364	<i>Vitex lucens</i> , <i>Podocarpus totara</i> , <i>Picea abies</i> , <i>Ilex aquifolium</i> , <i>Quercus robur</i> , <i>Cedrus deodara</i> , <i>Chamaecyparis lawsoniana</i>	Puriri (3), Avenue of trees including: Puriri (5), Totara (3), Spruce, Holly, English Oak (2), Cedar, False Cypress	17	Liverpool Street 40	Royal Oak	Lot 1 DP 8648
257	<i>Vitex lucens</i> , <i>Phoenix canariensis</i>	Puriri, Phoenix Palm (2)	3	Lloyd Avenue 39	Mt Albert	Lot 1 DP 44143
170	<i>Metrosideros excelsa</i>	Pōhutukawa	2	Long Drive 106	St Heliers	Lot 2 DP 46553
91	<i>Phoenix canariensis</i>	Phoenix Palm	3	Long Drive (road reserve on intersection with Tamaki Drive)	St Heliers	
910	<i>Vitex lucens</i>	Puriri	1	Lovelock Avenue 16	Mt Eden	Lot 3 DP 34578

## Isthmus

ID	Botanical Name	Common Name	Number of Trees	Location/Street Address	Locality	Legal Description
815	<i>Dacrycarpus dacrydioides</i>	Kahikatea	1	Lucerne Road 16	Remuera	Pt Lot 13 DP 7525
659	<i>Livistona australis</i>	Australian Fan Palm	1	Luke Street East 101	Otahuhu	Lot 2 DP 46434
434	<i>Metrosideros excelsa, Cephalotaxus fortunei</i>	Pöhutukawa, Prince Albert's Yew	2	Main Highway 58-66	Ellerslie	Lot 2 DP 89318
433	<i>Metrosideros excelsa</i>	Pöhutukawa	1	Main Highway 80	Ellerslie	Lot 5 DP 28602
422	<i>Metrosideros excelsa Podocarpus totara</i>	Pöhutukawa, Totara (2)	2	Main Highway 88	Ellerslie	Lot 1 DP 28602
451	<i>Alectryon excelsus, Metrosideros excelsa</i>	Titoki, Pöhutukawa	2	Main Highway 217	Ellerslie	Pt Lot 33 DEEDS 870
460	<i>Quercus palustris</i>	Pin Oak	2	Malabar Drive 22	Ellerslie	Lot 9 DP 70028
549	<i>Metrosideros excelsa, Vitex lucens, Dacrydium cupressinum</i>	Pöhutukawa, Puriri (2), Rimu	4	Onehunga Mall 71-73	Onehunga	Lot 1 DP 131091
619	<i>Quercus robur, Podocarpus totara, Vitex lucens, Cupressus sempervirens, Metrosideros excelsa</i>	English Oaks (3), Totara (2), Puriri (2), Cypress (3), Pöhutukawa	14	Onehunga Mall 184	Onehunga	Allotment 9 SECT 18 VILL OF Onehunga
536	<i>Metrosideros excelsa, Podocarpus totara</i>	Pöhutukawa, Totara	2	Onehunga Mall 424	Onehunga	Lot 2 DP 30696
541	<i>Podocarpus totara</i>	Totara	1	Onehunga Mall 472	Onehunga	Lot 5 DP 18742
667	<i>Abies koreana, Araucaria bidwillii, Phoenix canariensis</i>	Korean Fir, Bunya-Bunya Pine, Phoenix Palm	3	Mangere Road 28	Otahuhu	Lot 2 DP 172615
668	<i>Ficus macrophylla</i>	Moreton Bay Fig	1	Mangere Road 74	Otahuhu	Pt Lot 3 DP 2854
662	<i>Phoenix canariensis</i>	Phoenix Palm	1	Mangere Road 141	Otahuhu	Lot 1 DP 115649
897	<i>Fagus sylvatica "Atropurpurea"</i>	Copper Beech	1	Manukau Road 218	Epsom	Lot 1 DP 17756
297	<i>Araucaria heterophylla</i>	Norfolk Island Pine	1	Manukau Road 219,	Epsom	Lot 2 DP 16336
302	<i>Quercus robur, Quercus canariensis</i>	English Oak (6), Algerian Oak	7	Manukau Road 243-257 (reserve)	Epsom	Lot 2 DP 12978
865	<i>Magnolia grandiflora</i>	Southern Magnolia	2	Manukau Road 244	Epsom	Lot 2 DP 31391
818	<i>Washingtonia sp</i>	Palm	1	Manukau Road 311	Epsom	Pt Lot 17 DP 2332
866	<i>Metrosideros excelsa</i>	Pöhutukawa	2	Manukau Road 317	Epsom	Lot 2 DP 2332
393	<i>Metrosideros excelsa</i>	Pöhutukawa	2	Manukau Road 495	Epsom	Lot 4 DP 15437
394	<i>Metrosideros excelsa</i>	Pöhutukawa	1	Manukau Road 524-528	Epsom	Lot 1 DP 122273
395	<i>Metrosideros excelsa</i>	Pöhutukawa	1	Manukau Road 533	Epsom	Lot 1 DP 70216
371	<i>Vitex lucens</i>	Puriri	4	Manukau Road 574	Onehunga	Lot 7 DP 4200
397	<i>Metrosideros excelsa</i>	Pöhutukawa	1	Manukau Road 621	Royal Oak	Lot 1 DP 115337
523	<i>Metrosideros excelsa, Vitex lucens</i>	Pöhutukawa, Puriri	2	Manukau Road 663	Royal Oak	Pt Lot 24 DP 15460
511	<i>Alectryon excelsus</i>	Titoki	1	Manukau Road 834-836	Onehunga	Lot 5 DP 4120
527	<i>Vitex lucens</i>	Puriri	1	Manukau Road 835	Onehunga	Lot 1 DP 52871
514	<i>Populus nigra 'italica'</i>	Lombardy Poplar	1	Manukau Road 1/861	Onehunga	Lot 1 DP 152598
319	<i>Metrosideros excelsa</i>	Pöhutukawa	2	Marewa Road 11-15A	Greenlane	Lots 1, 2 & 3DP 211353
290	<i>Agathis robusta</i>	South Queensland Kauri	1	Margot Street 44	Epsom	Lot 1 DP 393716
305	<i>Metrosideros excelsa</i>	Pöhutukawa	1	Margot Street 70	Epsom	Lot 9 DP 6930

## Isthmus

ID	Botanical Name	Common Name	Number of Trees	Location/Street Address	Locality	Legal Description
306	<i>Dacrydium cupressinum</i>	Rimu	1	Margot Street 76	Epsom	Lot 5 DP 190272
1008	<i>Metrosideros excelsa</i>	Pōhutukawa	1	Marine Parade 56	Herne Bay	Lot 1 DP 143720
784	<i>Metrosideros excelsa</i>	Pōhutukawa	1	Marine Parade 71	Herne Bay	Lot 1 DP 40738
785	<i>Vitex lucens</i>	Puriri	1	Mariri Road 11	Onehunga	Lot 2 DP 86786
556	<i>Metrosideros excelsa</i>	Pōhutukawa	1	Mariri Road 65	Onehunga	Lot 1 DP 52668
294	<i>Araucaria heterophylla</i> , <i>Metrosideros excelsa</i>	Norfolk Island Pine, Pōhutukawa	2	Market Road 130	Epsom	Pt Allotment 19 SECT 11 SBRS OF Auckland
963	<i>Dacrydium cupressinum</i>	Rimu	1	Marsden Avenue 8	Balmoral	Lot 15 DEEDS 252
361	<i>Metrosideros excelsa</i>	Pōhutukawa	1	Marsden Avenue 26	Balmoral	Lot 33 DEEDS 252
359	<i>Corynocarpus laevigatus</i> , <i>Vitex lucens</i> , <i>Quercus</i> <i>robur</i> , <i>Metrosideros</i> <i>excelsa</i>	Karaka (2), Puriri (3), English Oak, Pōhutukawa	7	Marsden Avenue 92	Balmoral	Lot 4 DP 176682
343	<i>Metrosideros excelsa</i>	Pōhutukawa	1	Marua Road 93	Ellerslie	Lot 1 DP 442020
868	<i>Vitex lucens</i>	Puriri	1	Masons Avenue 1	Herne Bay	Lot 63 DP 2477
786	<i>Quercus coccinea</i>	Scarlet Oak	1	Masons Avenue 13	Herne Bay	Lot 57 DP 2477
657	<i>Quercus robur</i>	English Oak	1	Mason Avenue 18	Otahuhu	Lot 4 DP 506432
658	<i>Quercus frainetto</i>	Hungarian Oak	1	Mason Avenue 45	Otahuhu	Pt Lot 28 DP 19736
440	<i>Cedrus deodara</i>	Himalayan Cedar	1	Matai Road 2	Greenlane	Pt Lot 13 DP 3855
644	<i>Metrosideros excelsa</i>	Pōhutukawa	1	Mataroa Road 4	Mt Wellington	Lot 1 DP 45593
970	<i>Metrosideros excelsa</i>	Pōhutukawa	1	Matipo Street 11	Balmoral	Lot 6 DP 9091
264	<i>Agathis australis</i> , <i>Podocarpus elatus</i>	Kauri, Brown Pine	2	Matipo Street 27	Balmoral	PT LOTS 24 25 DP 6793
416	<i>Fagus sylvatica purpurea</i>	Copper Beech	1	Maungakiekie Avenue 1	One Tree Hill	Lot 178 DP 18124
933	<i>Vitex lucens</i> , <i>Metrosideros</i> <i>excelsa</i>	Puriri (2); Pōhutukawa	3	Maungakiekie Avenue 2A One Tree Hill	One Tree Hill	Lot 175 DP 18124
414	<i>Fagus sylvatica</i>	Beech	1	Maungakiekie Avenue 20	One Tree Hill	Lot 164 DP 18124
415	<i>Podocarpus totara</i>	Totara	1	Maungakiekie Avenue 64	One Tree Hill	Lot 142 DP 18124
860	<i>Metrosideros excelsa</i>	Pōhutukawa	5	Maungawhau Road 31	Newmarket	Pt Lot 7 DP 10962
808	<i>Vitex lucens</i> , <i>Alectryon</i> <i>excelsus</i>	Puriri, Titoki	2	Maungawhau Road 32	Newmarket	Pt Lot 15 DP 10962
572	<i>Vitex lucens</i> , <i>Metrosideros</i> <i>excelsa</i> , <i>Cedrus deodara</i> , <i>Ficus macrophylla</i>	Puriri (3), Pōhutukawa, Cedar, Moreton Bay Fig	6	Maurice Road 17	Penrose	Lot 1 DP 342337
360	<i>Quercus ilex</i> , <i>Quercus</i> <i>robur</i>	Holm Oak (5), English Oak (3)	8	McCullough Avenue (road reserve between #73 & 89)	Mt Roskill	
247	<i>Metrosideros excelsa</i> , <i>Vitex</i> <i>lucens</i> , <i>Magnolia</i> <i>grandiflora</i> , <i>Washingtonia</i> <i>filifera</i>	Pōhutukawa, Puriri, Magnolia (2), Washington Palm (2)	6	McLean Street 1-3	Mount Albert	Lot 1 DP 95136
914	<i>Liriodendron tulipifera</i>	Tulip Tree	1	Mead Street 18	Avondale	
243	<i>Ulmus x hollandica</i> , <i>Fraxinus ornus</i>	Dutch Elm, Flowering Ash	2	Mead Street (road reserve outside #34 & 33)	Avondale	
235	<i>Alnus cordata</i>	Italian Alder	1	Meadowbank Road 93	Meadowbank	Lot 40 DP 20034
941	<i>Vitex lucens</i>	Puriri	1	Merivale Ave 12	Epsom	Pt Lot 1 DP 12548
990	<i>Vitex lucens</i>	Puriri	1	Merivale Avenue 14 & 16 & 18	Epsom	Lot 2 DP 138966
956	<i>Vitex lucens</i>	Puriri	1	Merivale Avenue 38	Epsom	Lot 2 DEEDS 257
175	<i>Metrosideros excelsa</i>	Pōhutukawa	1	Miller Street 45	Pt Chevalier	Lot 19 DP 15610
278	<i>Liquidambar styraciflua</i>	Liquidambar	4	Milton Road 59a	Mt Eden	Lot 2 DP 52422
777	<i>Dacrydium cupressinum</i> , <i>Podocarpus totara</i>	Rimu, Totara	2	Mitchell Street 8	Blockhouse Bay	Lot 1 DP 54442

## Isthmus

ID	Botanical Name	Common Name	Number of Trees	Location/Street Address	Locality	Legal Description
776	<i>Vitex lucens</i> , <i>Quercus robur</i>	Puriri (2), English Oak	3	Mitchell Street 14	Blockhouse Bay	Lot 3 DP 54442
542	<i>Metrosideros excelsa</i>	Pōhutukawa	1	Moana Avenue 51	Onehunga	Lot 1 DP 207357
546	<i>Metrosideros excelsa</i>	Pōhutukawa	1	Moana Avenue 71	Onehunga	Lot 3 DP 13653
538	<i>Phoenix canariensis</i>	Phoenix Palm	1	Moana Avenue 78	Onehunga	Lot 2 DP 31207
57	<i>Metrosideros excelsa</i>	Pōhutukawa	1	Moirā Street 2	Ponsonby	Lot 52A DP 47434
130	<i>Metrosideros excelsa</i> , <i>Metrosideros robusta</i>	Pōhutukawa (4), Rata	5	Monmouth Street 15-19	Grey Lynn	Pt Lot 17 DP 14426
436	<i>Araucaria heterophylla</i>	Norfolk Island Pine	1	Morrin Street 10	Ellerslie	Lot 1 DP 439810
435	<i>Metrosideros excelsa</i>	Pōhutukawa	1	Morrin Street 38-40	Ellerslie	Lot 1 DP 171910
896	<i>Metrosideros excelsa</i>	Pōhutukawa	2	Morvern Road 8	Epsom	Lot 57 DP 19597
942	<i>Dacrydium cupressinum</i>	Rimu	1	Morvern Road 12	Epsom	Lot 55 DP 19597
806	<i>Vitex lucens</i>	Puriri	1	Mountain Road 24	Epsom	Lot 101 DP 588571
467	<i>Cupressus macrocarpa</i>	Macrocarpa	1	Mountain Road 32-66 (reserve)	Mount Wellington	Pt Allotment 56 SECT 12 SBRS OF Auckland
474	<i>Metrosideros excelsa</i>	Pōhutukawa	2	Mountain Road 36	Mt Wellington	Allotment 201 SECT 12 SBRS OF Auckland
911	<i>Metrosideros excelsa</i>	Pōhutukawa	1	Mountain Road 40	Epsom	Pt Lot 1 DP 30367
215	<i>Vitex lucens</i> , <i>Quercus robur</i>	Puriri, English Oak	2	Mountain Road 55-85	Epsom	Pt Allotment 106 SECT 6 SBRS OF Auckland
952	<i>Podocarpus totara</i>	Totara	1	Mountain Road 84	Epsom	Lot 1 DP 55587
209	<i>Davidia involuclrata</i> , <i>Agathis palmerstonii</i> , <i>Juglans regia</i> , <i>Sequoiadendron giganteum</i> , <i>Podocarpus hallii</i>	Chinese Dove Tree, North Queensland Kauri, Walnut Tree (3), Giant Redwood/ Wellingtonia, Halls Totara	8	Mountain Road 119 & Glenfell Place 14	Epsom	Allotment 195 SECT 6 SBRS OF Auckland, Pt Lot 1 DP 4122
216	<i>Araucaria heterophylla</i>	Norfolk Island Pine	1	Mountain Road (road reserve outside #51A Owens Road)	Epsom	
842	<i>Vitex lucens</i>	Puriri	1	Mountain View Road 4	Western Springs	Lot 4 DP 43058
841	<i>Metrosideros excelsa</i>	Pōhutukawa	1	Mountain View Road 9	Western Springs	Lot 1 DP 203958
980	<i>Ulmus procera</i>	English Elm	1	Mt Albert Road 36	Mount Albert	Lot 2 DP 34873
253	<i>Sequoia sempervirens</i> , <i>Cryptomeria japonica</i> , <i>Ilex aquifolium</i>	California Redwood (2), Japanese Cedar (2), Holly	5	Mt Albert Road 100	Mount Albert	Lot 3 DP 51530
986	<i>Vitex lucens</i>	Puriri	1	Mt Albert Road 182	Sandringham	Lot 17 DP 10465
964	<i>Metrosideros excelsa</i>	Pōhutukawa	1	Mt Albert Road 469	Three Kings	Lot 1 DP 13706
965	<i>Vitex lucens</i>	Puriri	1	Mt Albert Road 477	Mount Roskill	Lot 1 DP 20459
905	<i>Metrosideros excelsa</i>	Pōhutukawa	1	Mt Albert Road 518	Mount Roskill	Lot 7 DP 19634
966	<i>Metrosideros excelsa</i>	Pōhutukawa	1	Mt Albert Road 520	Mount Roskill	Lot 1 DP 29111
775	<i>Metrosideros excelsa</i>	Pōhutukawa	1	Mt Albert Road 525A	Three Kings	Lot 1 DP 51017
3001	<i>Metrosideros excelsa</i> , <i>Metrosideros kermadecensis</i>	Pōhutukawa and kermadec Pōhutukawa	Group	Mount Albert Road 560; Mount Eden Road 1011	Three Kings	SECT 4 SO 531896; SECT 3 SO 531896

## Isthmus

ID	Botanical Name	Common Name	Number of Trees	Location/Street Address	Locality	Legal Description
499	<i>Ficus obliqua</i> , <i>Vitex lucens</i> , <i>Platanus x acerifolia</i>	Queensland Small - leaved Fig (3), Puriri, London Plane	5	Mt Albert Road 593	Royal Oak	Lot 2 DP 399421
787	<i>Vitex lucens</i>	Puriri	1	Mt Albert Road 600	Royal Oak	Lot 3 DP 188342
528	<i>Platanus acerifolia</i>	Karaka	1	Mt Albert Road 663	Royal Oak	Lot 4 DP 17915
788	<i>Dacrydium cupressinum</i>	Rimu	1	Mt Albert Road 674	Mount Albert	Lot 3 DP 8185
192	<i>Corynocarpus laevigatus</i> , <i>Vitex lucens</i> , <i>Cedrus</i> <i>deodara</i>	Karaka (3), Puriri (2), Atlas Cedar	6	Mt Eden Road 223-227	Mt Eden	Lot 4 DP 51425
193	<i>Araucaria heterophylla</i> , <i>Ailanthus altissima</i> , <i>Quercus ilex</i>	Norfolk Island Pine, Tree of Heaven (2), Holm Oak	4	Mt Eden Road 283	Mt Eden	Lot 3 DEEDS Blue 9
949	<i>Taxus baccata</i>	Yew	6	Mt Eden Road 307A	Mount Eden	Lot 1 DP 47770
203	<i>Vitex lucens</i> , <i>Platanus</i> <i>acerifolia</i> , <i>Metrosideros</i> <i>excelsa</i>	Puriri, London Plane Tree, Pöhutukawa	3	Mt Eden Rd 310 (reserve)	Mt Eden	Lot 1 DP 131932
201	<i>Araucaria heterophylla</i> , <i>Vitex lucens</i>	Norfolk Island Pine, Puriri (2)	3	Mt Eden Road 333	Mt Eden	Lot 1 DP 40757
285	<i>Podocarpus totara</i>	Totara	1	Mt Eden Road 461	Mt Eden	Lot 2 DP 16659
276	<i>Metrosideros excelsa</i>	Pöhutukawa	1	Mt Eden Road 465	Mt Eden	Lot 1 DP 27635
275	<i>Metrosideros excelsa</i>	Pöhutukawa	1	Mt Eden Road 465A	Mt Eden	Lot 2 DP 27635
958	<i>Metrosideros excelsa</i>	Pöhutukawa	2	Mt Eden Road 625	Mount Eden	Lot 2 DP 418166
959	<i>Vitex lucens</i>	Puriri	1	Mt Eden Road 666	Mount Eden	Lot 3 DP 19745
983	<i>Dacrycarpus dacrydioides</i>	Kahikatea	2	Mt Eden Road 679	Mount Eden	Lot 22 DP 4583
283	<i>Metrosideros excelsa</i> , <i>Metrosideros</i> <i>kermadecensis</i>	Pöhutukawa (4), Kermadec Island Pöhutukawa (2)	7	Mt Eden Road/Balmoral Road (reserve on corner)	Mt Eden	Lot 2 DP 25163
277	<i>Grevillea robusta</i> , <i>Vitex</i> <i>lucens</i>	Silky Oak, Puriri	2	Mt Eden Road/Disraeli Street (road reserve on corner)	Mt Eden	
735	<i>Araucaria heterophylla</i>	Norfolk Island Pine	1	Mt Royal Avenue 2	Mount Albert	Lot 48 DP 16603
840	<i>Dacrydium cupressinum</i>	Rimu	1	Mt Royal Avenue 33	Mount Albert	Lot 1 DP 16603
529	<i>Metrosideros excelsa</i>	Pöhutukawa	3	Mt Smart Road 42	Royal Oak	Lot 1 DP 312455
510	<i>Podocarpus totara</i>	Totara	2	Mt Smart Road 66-68	Onehunga	Lot 1 DP 188113
557	<i>Podocarpus totara</i>	Totara	2	Mt Smart Road 97	Onehunga	Lot 1 DP 47382
558	<i>Juglans regia</i> , <i>Podocarpus</i> <i>totara</i>	Walnut, Totara (4)	5	Mt Smart Road 109s	Onehunga	Lot 2 DP 47382
560	<i>Quercus robur</i> , <i>Alectryon</i> <i>excelsus</i> , <i>Juglans regia</i> , <i>Podocarpus totara</i> , <i>Vitex</i> <i>lucens</i>	English Oak (6), Titoki, Walnut, Totara, Puriri (3)	12	Mt Smart Road 117	Te Papapa	Lot 3 DP 47382
547	<i>Podocarpus totara</i>	Totara	1	Mt Smart Road 120	Onehunga	Lot 1 DP 114405
559	<i>Podocarpus totara</i>	Totara	1	Mt Smart Road 124	Onehunga	Lot 21 DEEDS O 8
574	<i>Metrosideros excelsa</i>	Pöhutukawa	4	Mt Smart Road 219	Onehunga	Pt Lot 1 DP 4113
292	<i>Cinnamomum camphora</i>	Camphor Laurel	2	Mt St John Avenue 17	Epsom	Lot 1 DP 17185
307	<i>Liquidambar styraciflua</i> , <i>Phoenix canariensis</i> , <i>Cedrus deodara</i>	Liquidambar, Phoenix Palm (2), Himalayan Cedar	4	Mt St John Avenue 27	Epsom	Lot 7 DP 17185
296	<i>Podocarpus totara</i>	Totara	1	Mt St John Avenue 47	Epsom	Lot 1 DEEDS S 117
320	<i>Podocarpus totara</i>	Totara	1	Mt St John Avenue 61	Epsom	Lot 8 DP 2976

## Isthmus

ID	Botanical Name	Common Name	Number of Trees	Location/Street Address	Locality	Legal Description
321	<i>Agathis australis</i>	Kauri	1	Mt St John Avenue 63	Epsom	Lot 9 DP 2976
475	<i>Metrosideros excelsa</i> , <i>Podocarpus totara</i> , <i>Tilia x europaea</i>	Pōhutukawa, Totara, Linden	3	Mt Wellington Highway 87	Mt Wellington	Allotment 13 SECT 1 SM LOTS NEAR VILL OF Panmure
592	<i>Metrosideros excelsa</i> , <i>Ficus macrophylla</i>	Pōhutukawa, Moreton Bay Fig	2	Mt Wellington Highway 200 (road reserve outside #200)	Mt Wellington	
590	<i>Araucaria heterophylla</i>	Norfolk Island Pine	1	Mt Wellington Highway 218-220	Mt Wellington	Pt Lot 67 DP 20427
641	<i>Platanus acerifolia</i>	London Plane (10)	Group	Mt Wellington Highway 517B	Mount Wellington	Lot 3 DP 171269
642	<i>Ficus macrophylla</i> , <i>Metrosideros excelsa</i> , <i>Vitex lucens</i>	Moreton Bay Fig (3), Pōhutukawa (3), Puriri	7	Mt Wellington Highway 523	Mount Wellington	Lot 2 DP 168442
646	<i>Platanus acerifolia</i>	London Plane	2	Mt Wellington Highway 525	Mount Wellington	Lot 1 DP 168442
649	<i>Metrosideros excelsa</i> , <i>Vitex lucens</i>	Pōhutukawa	2	Mt Wellington Highway 658	Mt Wellington	Lot 11 DP 7580
650	<i>Metrosideros excelsa</i>	Puriri, Pōhutukawa	2	Mt Wellington Highway 662	Mt Wellington	Lot 13 DP 7580
96	<i>Metrosideros excelsa</i>	Pōhutukawa	1	Muripara Avenue 18	Pt Chevalier	Lot 135 DP 20514
697	<i>Metrosideros excelsa</i>	Pōhutukawa	1	Nehu Street 2A	Orakei	Lot 2 DP 193891
632	<i>Cupressus sempervirens</i>	Italian Cypress	1	Neilson Street 270	Onehunga	Lot 1 DP 37733
184	<i>Metrosideros excelsa</i>	Pōhutukawa	1	New North Road 379	Kingsland	Pt Lot 17 DP 2916
179	<i>Quercus robur</i>	English Oak	5	New North Road 704	Mt Albert	Pt Allotment 170 SECT 10 SBRS OF Auckland
249	<i>Quercus robur</i> , <i>Magnolia grandiflora</i> , <i>Metrosideros excelsa</i> , <i>Podocarpus totara</i>	English Oak (12), Magnolia, Pōhutukawa, Totara (2)	16	New North Road 807 (reserve)	Mt Albert	Pt Allotment 189 PSH OF Titirangi
250	<i>Araucaria heterophylla</i> , <i>Taxus baccata</i> , <i>Metrosideros excelsa</i> , <i>Stenocarpus sinuatus</i>	Norfolk Island Pine (7), English Yew, Pōhutukawa, Australian Firewheel Tree	11	New North Road 830	Mt Albert	Pt Allotment 40 PSH OF Titirangi
976	<i>Araucaria heterophylla</i>	Norfolk Island Pine	1	New North Road 1062	Mt Albert	Lot 12 DP 21991
977	<i>Fagus sylvatica</i>	Red Beech	1	New North Road 1137	Mount Albert	Lot 1 DP 35472
677	<i>Quercus robur</i>	Oak	1	New North Road 1256	Avondale	Lot 2 DP 45694
75	<i>Phoenix canariensis</i>	Phoenix Palm	3	New Street 3-9	Ponsonby	Pt Allotment 14 SECT 8 SBRS OF Auckland
357	<i>Metrosideros robusta</i>	Northern Rata	1	New Windsor Road 113	New Windsor	Lot 3 DP 19513
799	<i>Metrosideros excelsa</i>	Pōhutukawa	1	Newton Road 122	Newton	Lot 2 DP 196272
698	<i>Metrosideros excelsa</i>	Pōhutukawa	1	Ngaio Street 9	Orakei	Lot 77 DP 38388
699	<i>Metrosideros excelsa</i>	Pōhutukawa	1	Ngaiwi Street 12	Orakei	Lot 9 DP 21287
826	<i>Agathis australis</i>	Kauri	1	Ngaroma Road 3	Epsom	Lot 2 DP 340162
579	<i>Metrosideros excelsa</i>	Pōhutukawa	1	Ngatiawa Road 37	Onehunga	Lot 174 DP 20802
443	<i>Agathis australis</i>	Kauri	1	Ngatiawa Road 52	Onehunga	Lot 49 DP 20802
637	<i>Metrosideros excelsa</i> , <i>Populus yunnanensis</i>	Pōhutukawa, Chinese Poplar (2)	3	Niall Burgess Drive 1	Mount Wellington	Lot 2 DP 188715
635	<i>Platanus acerifolia</i> , <i>Populus deltoides</i>	London Plane (32), Cottonwood	33	Niall Burgess Drive 8 (reserve)	Mount Wellington	Lot 18 DP 168442, Lot 17 DP 169144
648	<i>Vitex lucens</i>	Puriri	2	Nikau Road 13	Otahuhu	Lot 2 DP 35948
790	<i>Eucalyptus nicholii</i>	Peppermint Gum	1	Norfolk Street 45	Ponsonby	Lot 60 DEEDS Blue V
791	<i>Metrosideros excelsa</i>	Pōhutukawa	1	Norfolk Street 82	Grey Lynn	Lot 110 DP 3311



## Isthmus

ID	Botanical Name	Common Name	Number of Trees	Location/Street Address	Locality	Legal Description
204	<i>Erythrina crista-galli</i>	Flame Tree	1	Normanby Road/Boston Road	Mt Eden	
616	<i>Eucalyptus ficifolia</i>	Red Flowering Gum	1	Normans Hill Road 12	Onehunga	Lot 1 DP 20853
615	<i>Metrosideros excelsa</i>	Pōhutukawa	1	Normans Hill Road 26	Onehunga	Lot 2 DP 38539
614	<i>Vitex lucens, Corynocarpus laevigatus</i>	Puriri, Karaka	2	Normans Hill Road 26A	Onehunga	Lot 1 DP 58167
530	<i>Vitex lucens</i>	Puriri	1	Normans Hill Road 67	Onehunga	Pt Lot E DP 2010
517	<i>Agathis australis, Pseudopanax crassifolium, Dacrycarpus dacrydioides, Metrosideros excelsa</i>	Kauri, Lancewood, Kahikatea, Pōhutukawa	4	Normans Hills Road 54	Onehunga	Lot 1 DP 48640
625	<i>Metrosideros excelsa</i>	Pōhutukawa	1	O'Rorke Street 9	Onehunga	Lot 2 DP 69685
506	<i>Metrosideros excelsa</i>	Pōhutukawa	1	Oak Street 1B	Royal Oak	Lot 29 DP 8185
938	<i>Metrosideros excelsa</i>	Pōhutukawa		Oakley Avenue 76-78	Waterview	Lot 2 DP 58588
117	<i>Vitex lucens</i>	Puriri	2	Old Mill Road 55	Grey Lynn	Lot 2 DP 60168
97	<i>Podocarpus totara</i>	Totara	1	Oliver Street 37	Pt Chevalier	Lot 21 DP 7636
322	<i>Metrosideros excelsa</i>	Pōhutukawa	1	Omahu Road 53	Remuera	Lot 2 DP 53665
376	<i>Metrosideros excelsa, Lithocarpus edulis</i>	Pōhutukawa (26), Tanbark Oak	27	One Tree Hill Domain (western boundary, and corner of Haydn Ave & Manukau Rd) )	One Tree Hill	Pt Allotment 54 SECT 12 SBRS OF Auckland, Pt Allotment 11 SECT 12 SBRS OF Auckland
681	<i>Quercus robur</i>	Common Oak	1	Onslow Road 26	Kingsland	Pt Allotment 11 SECT 10 SBRS OF Auckland
401	<i>Eucalyptus ficifolia</i>	Red Flowering Gum	1	Orakau Avenue 16	Epsom	Lot 19 DP 7443
374	<i>Dacrydium cupressinum</i>	Rimu	1	Orakau Avenue 27	Epsom	Lot 15 DP 8179
947	<i>Podocarpus totara</i>	Totara	1	Orakei Road 24	Remuera	Lot 1 DP 84270
793	<i>Alectryon excelsus, Podocarpus totara</i>	Titoki; Totara (2)	3	Orakei Road 92	Remuera	Lot 8 DP 62539
232	<i>Agathis robusta</i>	South Queensland Kauri	2	Orakei Road 94	Remuera	Lot 7 DP 62539
996	<i>Agathis robusta</i>	Queensland Kauri	1	Orakei Road 100	Remuera	Lot 4 DP 62539
792	<i>Vitex lucens</i>	Puriri	1	Orakei Road 107	Remuera	Lot 1 DP 20393
228	<i>Ulmus parvifolia</i>	Chinese Elm	1	Orakei Road 184	Orakei	Lot 3 DP 45292
345	<i>Vitex lucens, Corynocarpus laevigatus</i>	Puriri, Karaka	2	Oran Road 9A	Panmure	Lot 2 DP 460890
575	<i>Metrosideros excelsa</i>	Pōhutukawa	1	Oranga Avenue 11/42	Onehunga	Lot 2 DP 188221
576	<i>Metrosideros excelsa</i>	Pōhutukawa	1	Oranga Avenue 67	Onehunga	Lot 1 DP 43265
843	<i>Metrosideros excelsa</i>	Pōhutukawa	1	Owairaka Avenue 133	Mt Albert	Lot 7 DP 16488
274	<i>Cupressus macrocarpa, Vitex lucens</i>	Macrocarpa, Puriri	2	Owens Road 129	Epsom	Pt Lot 3 DP 579
809	<i>Litsea calicaris</i>	Mangeao	1	Owens Road 30	Epsom	Lot 2 DP 52878
212	<i>Agathis robusta</i>	South Queensland Kauri	1	Owens Road 34	Epsom	Lot 1 DP 64390
219	<i>Castanospermum australe</i>	Moreton Bay Chestnut	1	Owens Road 37	Epsom	Pt Lot 32 DP 6924
220	<i>Nothofagus solandri</i>	Black Beech	1	Owens Road 39	Epsom	Lot 38 DP 6924
217	<i>Metrosideros excelsa, Jacaranda mimosifolia, Laurus canariensis</i>	Pōhutukawa, Jacaranda (2), Canary Island Laurel	4	Owens Road 42	Epsom	Lot 1 DP 161728
210	<i>Syzygium ventenatti, Syncarpia glomulifera, Agathis robusta, Platanus acerifolia, Cupressus macrocarpa</i>	Weeping Lilly Pilly, Red Turpentine Tree (2), South Queensland Kauri, London Plane Tree, Macrocarpa		Owens Road 75	Epsom	Pt Allotment 37 SECT 6 SBRS OF Auckland

## Isthmus

ID	Botanical Name	Common Name	Number of Trees	Location/Street Address	Locality	Legal Description
288	<i>Taxus baccata 'fastigiata'</i>	Irish Yew	1	Owens Road 82	Epsom	Lot 9 DP 7287
700	<i>Araucaria bidwillii</i>	Bunya Bunya Pine	1	Paerimu Street 15	Orakei	Lot 469 DP 38384
396	<i>Podocarpus totara</i>	Totara	1	Pah Road 12	Epsom	Lot 4 DP 4828
516	<i>Ginkgo biloba</i>	Ginkgo	5	Pah Road 100	Royal Oak	Lot 1 DP 441241
679	<i>Cedrus deodara</i>	Himalayan Cedar	5	Pah Road 108-124	Royal Oak	Lot 1 DP 90089
716	<i>Podocarpus totara</i>	Totara	1	Paice Avenue 73	Sandringham	Lot 23 DP 3671
437	<i>Quercus canariensis</i>	Algerian Oak	1	Paihia Road 139	Onehunga	Lot 7 DP 37894
639	<i>Metrosideros excelsa</i>	Pōhutukawa	1	Panama Road 9	Mt Wellington	Lot 5 DP 23160
58	<i>Metrosideros excelsa</i>	Pōhutukawa	1	Parawai Crescent 21	Ponsonby	Lot 27 DP 38075
2988	<i>Metrosideros excelsa</i>	Pōhutukawa	1	Paritai Drive 90	Orakei	SEC 1 Town ORAKEI
800	<i>Metrosideros excelsa</i>	Pōhutukawa	1	Park Avenue 22-30	Grafton	Lot 1 DP 198589
997	<i>Dacrycarpus dacrydioides, Dacrydium cupressinum, Metrosideros excelsa, Quercus robur</i>	Kahikatea (2), Rimu, Pōhutukawa (3), Rimu (3), English Oak	9	Parkside Street 27A, B, C	St Heliers	Lot 3 DP 412715
148	<i>Araucaria heterophylla</i>	Norfolk Island Pine	1	Parnell Road 324	Parnell	Lot 1 DP 49779
154	<i>Quercus robur</i>	English Oak	5	Parnell Road 437	Parnell	Lot 3 DP 103838
152	<i>Dracaena draco, Quercus robur, Ficus macrophylla</i>	Dragon Tree, English Oak (15), Moreton Bay Fig	17	Parnell Road 446	Parnell	Lot 1 DP 93398
145	<i>Metrosideros excelsa</i>	Pōhutukawa	1	Parnell Road 539-541	Parnell	Lot 4 DP 362696
86	<i>Agathis robusta</i>	South Queensland Kauri	1	Parnell Road 1 (reserve)	Parnell	Allotment 95 SECT 1 SBRS OF Auckland
172	<i>Metrosideros excelsa</i>	Pōhutukawa	1	Peacock Street 17	Glendowie	Pt Lot 7 DP 34047
93	<i>Metrosideros excelsa</i>	Pōhutukawa	10	Peacock Street (road reserve at end in Karaka Bay)	Glendowie	
751	<i>Quercus robur</i>	English Oak	1	Pencarrow Avenue 15	Mount Eden	Pt Lot 6 DEEDS 522
844	<i>Metrosideros excelsa</i>	Pōhutukawa	2	Penrhyn Road 14	Mt Eden	Pt Lot 54 DEEDS S 22
585	<i>Metrosideros excelsa</i>	Pōhutukawa	1	Penrose Road 155	Mt Wellington	Lot 89 DP 34252
586	<i>Quercus robur</i>	English Oak	2	Penrose Road 165	Penrose	Lot 84 DP 34252
587	<i>Metrosideros excelsa</i>	Pōhutukawa	1	Penrose Road 171	Penrose	Lot 2 DP 53148
581	<i>Eucalyptus maidenii</i>	Maiden's Gum	6	Penrose Road (road reserve outside #116-120)	Penrose	Lot 1 DP 202809
718	<i>Vitex lucens</i>	Puriri	1	Pentland Avenue 16	Mt Eden	Lot 1 DP 130889
198	<i>Vitex lucens</i>	Puriri	1	Pentland Avenue 22	Mt Eden	Lot 30 DP 3705
596	<i>Platanus acerifolia, Populus deltoides</i>	Plane (4), Cottonwood (3)	7	Peterson Road (reserve)	Mt Wellington	Lot 4 DP 38031
132	<i>Vitex lucens</i>	Puriri	1	Picton Street 32A	Freemans Bay	Lot 1 DP 199504
131	<i>Vitex lucens</i>	Puriri	2	Picton Street 32B	Freemans Bay	Lot 2 DP 199504
133	<i>Platanus acerifolia</i>	London Planes	33	Picton Street (road reserve – whole street)	Freemans Bay	
666	<i>Metrosideros excelsa</i>	Pōhutukawa	1	Piki Thompson Way 2	Otahuhu	Lot 10 DP 19310
477	<i>Metrosideros excelsa</i>	Pōhutukawa	2	Pilkington Road 52 (and road reserve)	Mt Wellington	
266	<i>Metrosideros excelsa</i>	Pōhutukawa	1	Pine Street 65	Balmoral	Lot 12 DP 6943
535	<i>Metrosideros kermadecensis</i>	Kermadec Pōhutukawa	5	Pleasant Street 24	Onehunga	Pt Allotment 2 SECT 13 SBRS OF Auckland

## Isthmus

ID	Botanical Name	Common Name	Number of Trees	Location/Street Address	Locality	Legal Description
531	<i>Podocarpus totara</i> , <i>Ilex aquifolium</i> , <i>Metrosideros excelsa</i>	Totara, Holly, Pöhutukawa	3	Pleasant Street 56	Onehunga	Lot 1 DP 158845
124	<i>Magnolia grandiflora</i> <i>Metrosideros excelsa</i>	Magnolia, Pöhutukawa (2)	3	Ponsonby Road 50	Ponsonby	Lot 1 Blk 27 DP 242
122	<i>Platanus acerifolia</i>	London Plane Tree	1	Ponsonby Road 95(road reserve, cnr Picton Street)	Ponsonby	Lot 1 DP 33964
123	<i>Araucaria columnaris</i> , <i>Cupressus torulosa</i> , <i>Pinus canariensis</i>	Cooks Pine, Bhutan Cypress, Canary Island Pine (2)	4	Ponsonby Road (reserve)	Ponsonby	Allotment 3 SECT 52 Auckland CITY
134	<i>Populus yunnanensis</i>	Chinese Poplar	3	Ponsonby Road (near corner with Karangahape Road)	Ponsonby	Lot 2 DP 81579
78	<i>Vitex lucens</i> , <i>Metrosideros excelsa</i>	Puriri, Pöhutukawa	2	Ponsonby Terrace 1A	Ponsonby	Pt Allotment 21 SECT 8 SBRS OF Auckland
845	<i>Vitex lucens</i>	Puriri	1	Poronui Street 2A, 4 & 6	Mount Eden	Lot 3 DP 143612
945	<i>Metrosideros excelsa</i> , <i>Vitex lucens</i>	Pöhutukawa x 2; Puriri	3	Portland Road 14	Remuera	Lot 6 DP 19569
226	<i>Quercus robur</i>	English Oak	1	Portland Road 50,	Remuera	Lot 1 DP 172552
953	<i>Cupressus torulosa</i>	Himalayan Cypress	1	Portland Road 57A	Remuera	Lot 1 DP 70643
994	<i>Quercus robur</i>	English Oak	1	Portland Road 63	Remuera	Lot 1 DP 59710
954	<i>Araucaria heterophylla</i> , <i>Metrosideros excelsa</i>	Norfolk Island Pine, Pöhutukawa	2	Portland Road 65A	Remuera	Lot 2 DP 58654
955	<i>Quercus palustris</i>	Pin Oak	1	Portland Road 67	Remuera	Lot 7 DP 16333
975	<i>Podocarpus totara</i>	Totara	1	Portland Road 69	Remuera	Pt Lot 6 DP 16333
151	<i>Taxodium distichum</i>	Swamp Cypress	1	Portland Road 73A	Remuera	Lot 1 DP 464018
1006	<i>Taxodium distichum</i>	Sydney Peppermint	2	Portland Road 73D	Remuera	Lot 11 DP 16333
993	<i>Quercus palustris</i>	Pin Oak	1	Portland Road 77	Remuera	Lot 4 DP 16333
129	<i>Metrosideros excelsa</i>	Pöhutukawa	2	Potatau St 30	Grey Lynn	Pt Lot 97 DEEDS 1370, Pt Lot 96 Deeds 1370
846	<i>Dacrydium cupressinum</i>	Rimu	1	Prime Road 14	Grey Lynn	Lot 2 Blk 42 DP 1720
653	<i>Metrosideros excelsa</i> , <i>Vitex lucens</i>	Pöhutukawa, Puriri	2	Princes Street 100	Otahuhu	Lot 2 DP 37153
652	<i>Phoenix canariensis</i>	Phoenix Palm	2	Princes Street 120	Otahuhu	Lots 1, 2 & 3 DP 79989
753	<i>Agathis australis</i>	Kauri	1	Prospect Terrace 5	Mount Eden	Lot 13 DEEDS S 25
739	<i>Agathis australis</i>	Kauri	1	Prospero Terrace 15	Mount Albert	Lot 1 DP 144311
270	<i>Dacrydium cupressinum</i> , <i>Agathis australis</i>	Kahikatea (2), Kauri	3	Prospect Terrace 40A	Mt Eden	Lot 32 DP 1665
176	<i>Magnolia grandiflora</i>	Magnolia	2	Pt Chevalier Road 92	Pt Chevalier	Lots 2 & 3 DP 348
98	<i>Podocarpus totara</i>	Totara	1	Pt. Chevalier Road 436	Pt Chevalier	Lot 4 DP 19779
99	<i>Araucaria heterophylla</i>	Norfolk Island Pine	1	Pt Chevalier Road 471	Pt Chevalier	Lot 44 DP 7354
346	<i>Celtis australis</i> , <i>Pinus pinea</i>	Southern NettleTree, Stone Pine	2	Pt England Road 35-37	Pt England	Lots 1 & 2 DP 23937
772	<i>Podocarpus totara</i>	Totara	1	Pukehana Avenue 10	Epsom	Lot 12 DP 17898
828	<i>Fagus sylvatica</i> ' <i>Atropurpurea</i> '	Copper Beech	1	Pukehana Avenue 26	Epsom	Lot 12 DP 13303
827	<i>Vitex lucens</i>	Puriri	1	Pukehana Avenue 27	Epsom	Lot 7 DP 13303
771	<i>Dacrydium cupressinum</i>	Rimu	1	Pukenui Road 12	Epsom	Pt Lot 10 DP 4912
398	<i>Podocarpus totara</i>	Totara	1	Pukenui Road 24,	Epsom	Lot 2 DP 71037
461	<i>Ficus macrophylla</i>	Moreton Bay Fig	1	Pukerangi Crescent 1	Ellerslie	Lot 5 DP 70028
493	<i>Metrosideros excelsa</i>	Pöhutukawa	2	Puketea Street 43	Blockhouse Bay	Lot 1 DP 46589

## Isthmus

ID	Botanical Name	Common Name	Number of Trees	Location/Street Address	Locality	Legal Description
405	<i>Vitex lucens</i>	Avenue of Puriri	30	Puriri Avenue (road reserve – whole street) (	Greenlane	
491	<i>Abies sp.</i>	Fir	1	Queens Road 221	Panmure	Lot 1 DP 18885
597	<i>Metrosideros excelsa</i>	Pōhutukawa	1	Queens Road 241	Panmure	Lot 5 DP 20544
177	<i>Vitex lucens</i>	Puriri	1	Rama Road 22	Pt Chevalier	Lot 1 DP 169684
300	<i>Metrosideros excelsa</i>	Pōhutukawa	1	Ranfurly Road 1A	Epsom	Lot 2 DP 51957
308	<i>Libocedrus plumosa</i>	Kawaka	1	Ranfurly Road 3	Epsom	Lot 1 DP 20119
756	<i>Sequoiadendron giganteum</i>	Giant Redwood/ Wellingtonia	1	Ranfurly Road 55A	Epsom	Lot 2 DP 49089
995	<i>Agathis australis</i>	Kauri	1	Ranfurly Road 64	Epsom	Lot 1 DP 44631
758	<i>Rhopalostylis sapida</i>	Nikau		Ranfurly Road 66	Epsom	Lot 1 DP 15078
757	<i>Rhopalostylis sapida</i>	Nikau		Ranfurly Road 67	Epsom	Lot 1 DP 34126
760	<i>Quercus robur,</i> <i>Rhopalostylis sapida</i>	English Oak, Nikau	2	Ranfurly Road 74	Epsom	Pt Lot 11B DP 3069
759	<i>Rhopalostylis sapida</i>	Nikau		Ranfurly Road 86	Epsom	Lot 1 DP 168400
816	<i>Podocarpus totara</i>	Totara	1	Ranfurly Road West 104	Epsom	Pt Allotment 45 SECT 6 SBRS OF Auckland
400	<i>Agathis australis</i>	Kauri	1	Rangiatea Road 12	Epsom	Lot 2 DP 27969
573	<i>Vitex lucens</i>	Puriri	1	Rangipawa Road 21	Onehunga	Allotment 89 SECT 12 SBRS OF Auckland
577	<i>Vitex lucens</i>	Puriri	1	Rangipawa Road 26	Onehunga	Lot 234 DP 18799
578	<i>Metrosideros excelsa</i>	Pōhutukawa	2	Rangipawa Road 30	Onehunga	Lot 232 DP 21433
1003	<i>Vitex lucens</i>	Puriri	1	Rangitoto Avenue 26	Remuera	Pt Lot 6 DP 22166
814	<i>Rhopalostylis sapida</i>	Nikau	1	Rangitoto Avenue 37	Remuera	Lot 25 DP 18223
899	<i>Podocarpus totara</i>	Totara	1	Ranui Road 9	Remuera	Pt Lot 16 DP 21482
44	<i>Metrosideros excelsa</i>	Pōhutukawa	2	Rawene Avenue 14/16/18	Westmere	Lot 67 DP 10231
45	<i>Metrosideros excelsa, Vitex lucens</i>	Pōhutukawa (4), Puriri	5	Rawene Avenue 38	Westmere	Lot 55 DP 10231
702	<i>Metrosideros excelsa</i>	Pōhutukawa	1	Reihana Street 42A	Orakei	Lot 1 DP 508366
701	<i>Araucaria heterophylla</i>	Norfolk Island Pine	1	Reihana Street 106	Orakei	Lot 27 DP 46795
971	<i>Metrosideros excelsa</i>	Pōhutukawa	2	Remuera Road 273	Remuera	Lot 1 DP 65576
847	<i>Agathis robusta</i>	Queensland Kauri	1	Remuera Road 276	Remuera	Lot 2 DP 149567
334	<i>Alectryon excelsus</i>	Titoki	1	Remuera Road 450	Remuera	Lot 4 DP 32518
794	<i>Metrosideros excelsa</i>	Pōhutukawa (3), English Oak	4	Remuera Road 519	Remuera	Lot 1 DP 364537
822	<i>Metrosideros robusta</i>	Northern Rata	1	Remuera Road 690	Remuera	Lot 5 DP 20952
960	<i>Metrosideros excelsa</i>	Pōhutukawa	1	Remuera Road 708	Remuera	Lot 5 DP 32385
762	<i>Metrosideros excelsa</i>	Pōhutukawa	1	Remuera Road 712	Remuera	Lot 2 DP 31975
985	<i>Cordyline australis, Vitex lucens</i>	Cabbage Tree, Puriri	2	Remuera Road 728	Remuera	Pt Lot 3 DP 19028
135	<i>Metrosideros excelsa,</i> <i>Liquidambar styraciflua</i>	Pōhutukawa (2), Liquidambar	3	Richmond Road 113-127	Ponsonby	Lots 55 & 56, & Lot 77 DEEDS Blue W
115	<i>Cupressus goveniana</i>	Gowan Cypress	Group	Richmond Road 244	Grey Lynn	Lot 1 DP 155631
1011	<i>Metrosideros excelsa</i>	Pōhutukawa	2	Richardson Road 285A	Mount Roskill	Pt Lot 2 DP 72522

## Isthmus

ID	Botanical Name	Common Name	Number of Trees	Location/Street Address	Locality	Legal Description
112	<i>Metrosideros excelsa</i>	Pōhutukawa	1	Richmond Road 334-336	Grey Lynn	Pt Lot 1A A 938
712	<i>Vitex lucens</i>	Puriri	2	Riddell Road 138	Glendowie	Lot 168 DP 18160
171	<i>Metrosideros excelsa, Quercus robur, Quercus cerris</i>	Pōhutukawa (2), English Oak (4), Turkey Oak	7	Riddell Road 510	Glendowie	Lot 1 DP 157604
79	<i>Phoenix canariensis</i>	Phoenix Palm	2	Ring Terrace 1/17	Ponsonby	Lot 3 DP 110257
728	<i>Araucaria heterophylla</i>	Norfolk Island Pine	1	Riversdale Road 63	Avondale	Lot 1 DP 50188
350	<i>Carya illinoensis</i>	Pecan Tree	2	Riversdale Road 177	Avondale	Lot 3 DP 22401
348	<i>Metrosideros excelsa</i>	Pōhutukawa	2	Riverside Avenue 194	Pt England	Lot 363 DP 19406
482	<i>Metrosideros excelsa</i> 'variegata'	Variegated Pōhutukawa	1	Riverview Road 18	Panmure	Allotment 65 SECT 3 VILL OF Panmure
912	<i>Liriodendron tulipifera</i>	Tulip tree	1	Rockwood Place 6	Epsom	Lot 3 DP 46839
732	<i>Agathis australis</i>	Kauri	1	Rosebank Road 159	Avondale	Lot 1 DP 46716
729	<i>Prunus spp</i>	Cherry Tree	1	Rosebank Road 278	Avondale	Lot 1 DP 151906
674	<i>Araucaria heterophylla</i>	Norfolk Island Pine	1	Rosebank Road 448	Avondale	Lot 2 DP 100061
673	<i>Podocarpus totara, Vitex lucens, Quercus robur</i>	Totara, Puriri, Common Oak	3	Rosebank Road 489	Avondale	Lot 1 DP 118450
672	<i>Araucaria heterophylla</i>	Norfolk Island Pine	23	Rosebank Road 489-493	Avondale	Lot 1 DP 314867
675	<i>Podocarpus totara, Metrosideros excelsa</i>	Totara, Pōhutukawa	6	Rosebank Road 494	Avondale	Lot 1 DP 463284
595	<i>Metrosideros excelsa</i>	Pōhutukawa	1	Roslyn Road 15	Mt Wellington	Lot 49 DP 21547
830	<i>Vitex lucens</i>	Puriri	1	Rowan Road 20B	Epsom	Lot 3 DP 332108
867	<i>Quercus ilex, Corynocarpus laevigatus, Vitex lucens</i>	Holm Oak. Karaka. Puriri	3	Rowan Road 24A	Royal Oak	Lot 7 DP 335718
935	<i>Vitex lucens</i>	Puriri	1	Rowan Road 26A	Royal Oak	Lot 9 DP 335718
999	<i>Metrosideros excelsa</i>	Pōhutukawa	1	Royal Terrace (road reserve outside #35)	Sandringham	
922	<i>Dacrycarpus dacrydioides</i>	Kahikatea	1	Ruarangi Road 4A	Mount Albert	Lot 2 DP 190557
583	<i>Vitex lucens</i>	Puriri	1	Ruawai Road 1-3	Mt Wellington	Lot 1 DP 140144
582	<i>Metrosideros excelsa</i>	Pōhutukawa	1	Ruawai Road 2	Mt Wellington	Lot 5 DP 36260
588	<i>Metrosideros excelsa</i>	Pōhutukawa	3	Ruawai Road 27A	Mt Wellington	Lot 2 DP 331464
589	<i>Metrosideros excelsa</i>	Pōhutukawa	1	Ruawai Road 78	Mt Wellington	Lot 1 DP 40914
645	<i>Populus x canadensis</i>	Golden Poplar	1	Ryburn Road 11	Mt Wellington	Lot 4 DP 39188
640	<i>Metrosideros excelsa</i>	Pōhutukawa	1	Ryburn Road 22	Mount Wellington	Lot 1 DP 199264
580	<i>Agathis australis</i>	Kauri	3	Rydal Drive 8 & 11	Mt Wellington	Lot 4 DP 57668
584	<i>Agathis australis</i>	Kauri	10	Rydal Drive 8	Mt Wellington	Lot 7 DP 57668
59	<i>Metrosideros kermadecensis</i>	Kermadec Pōhutukawa	2	Salisbury Street 3	Herne Bay	Lot 4 DP 23323
60	<i>Fraxinus americana</i>	American Ash	1	Salisbury Street 11	Herne Bay	Lot 7 DP 1877
795	<i>Metrosideros excelsa</i>	Pōhutukawa	1	Salisbury Street 22	Herne Bay	Lot 1 DP 114359

## Isthmus

ID	Botanical Name	Common Name	Number of Trees	Location/Street Address	Locality	Legal Description
678	<i>Quercus robur</i>	Common Oak	3	Sandringham Road 419	Sandringham	Pt Lots 3 & 4 ALLT 159 Section 10 SBRS OF Auckland
796	<i>Metrosideros excelsa</i>	Pōhutukawa	1	Sarsfield Street 10	Herne Bay	Lot 1 DP 155997
61	<i>Podocarpus totara</i>	Totara	1	Sarsfield Street 80	Herne Bay	Lot 1 DP 176793
710	<i>Dacrycarpus dacrydioides</i>	Kahikatea	1	Sayegh Street 31	St Heliers	Lot 5 DP 40694
181	<i>Metrosideros excelsa</i>	Pōhutukawa	1	School Road 1A	Kingsland	Allotment 45 SECT 5 SBRS OF Auckland
889	<i>Metrosideros excelsa, Calocedrus decurrens</i>	Pōhutukawa, Incense Cedar	2	Seafield View Road 40	Grafton	Part Lot 2 DP 23630, Part Lot 22 DP 15537
848	<i>Metrosideros excelsa 'Variegata'</i>	Variegated Pōhutukawa	1	Seaside Avenue 27	Waterview	Lot 86 DP 18786
222	<i>Sequoia sempervirens</i>	Redwood	19	Seaview Road 64, 66, 68	Remuera	Lot 3 DP 68934, Lot 1 DP 68934, Pt Lot 2 DP 9192
223	<i>Araucaria bidwillii, Podocarpus totara, Metrosideros excelsa, Quercus canariensis, Ficus rubiginosa</i>	Bunya Bunya Pine, Totara (2), Pōhutukawa (5), Canary Oak, Port Jackson Fig	10	Seaview Road 72	Remuera	Lot 1 DP 97142
178	<i>Araucaria heterophylla</i>	Norfolk Island Pine	1	Seaview Terrace 66	Mt Albert	Lot 3 DP 191172
208	<i>Podocarpus totara</i>	Totara	1	Seccombes Road 12C	Epsom	Lot 3 DP 211537
877	<i>Podocarpus totara</i>	Totara		Seccombes Road 30	Newmarket	Lot 3 DP 10962
3006	<i>Vitex lucens</i>	Puriri	1	Seccombes Road 36	Epsom	Lot 100 DP 588571
187	<i>Metrosideros excelsa</i>	Pōhutukawa	1	Second Avenue 35	Kingsland	Lot 121 Blk 1 DP 171
696	<i>Metrosideros excelsa</i>	Pōhutukawa	1	Selwyn Avenue 31	Mission Bay	Pt Lot 2 DP 9001
621	<i>Metrosideros excelsa</i>	Pōhutukawa	1	Selwyn Street 37-39	Onehunga	Lot 6 DEEDS 566
606	<i>Metrosideros excelsa</i>	Pōhutukawa	1	Selwyn Street 52	Onehunga	Lot 4 DP 27565
519	<i>Vitex lucens</i>	Puriri	1	Selwyn Street 119	Onehunga	Lot 1 DP 176408
80	<i>Metrosideros excelsa</i>	Pōhutukawa	1	Seymour Street 3/5	Ponsonby	Lot 1 DP 26368
65	<i>Metrosideros excelsa</i>	Pōhutukawa	1	Shelly Beach Road 17	Ponsonby	Pt Lot 8 DP 29740
83	<i>Araucaria heterophylla</i>	Norfolk Island Pine	1	Shelly Beach Road 42	Ponsonby	Lot 1 DP 348908
68	<i>Quercus robur, Phoenix canariensis</i>	English Oak, Phoenix Palm (7)	8	Shelly Beach Road 55A	Herne Bay	Lot 1 DP 328893
869	<i>Vitex lucens</i>	Puriri	2	Shelly Beach Road 91	Ponsonby	Pt Lot 1 DP 37078
64	<i>Metrosideros excelsa</i>	Pōhutukawa	1	Shelly Beach Road 109	Herne Bay	Pt Lot 5 DP 14312
870	<i>Metrosideros excelsa</i>	Pōhutukawa		Shelly Beach Road 117	Herne Bay	Lot 1 DP 196962
156	<i>Carya illinoensis</i>	Pecan Tree	1	Shore Road 7	Remuera	Lot 4 DP 52454
224	<i>Platanus acerifolia</i>	Plane Tree	2	Shore Road 17-17A (reserve)	Remuera	Part Allot 1 Sec 16 SBRS OF Auckland Section 1 SO 69009
163	<i>Podocarpus elatus, Quercus anariensis</i>	Brown Pine (2), Spanish Oak	3	Shore Road 74-84	Remuera	Allotment 92 SECT 16 SBRS OF Auckland
218	<i>Elaeocarpus dentatus, Quercus robur</i>	Hinau, English Oak	2	Silver Road 14	Epsom	Pt Allotment 149 SECT 6 SBRS OF Auckland
622	<i>Quercus robur, Metrosideros excelsa, Alectryon excelsus</i>	English Oak (2), Pōhutukawa, Titoki	4	Spring Street 19	Onehunga	Lot 3 DEEDS 659
92	<i>Washingtonia filifera</i>	Washington Palm	1	Springcombe Road 9	St Heliers	Lot 1 DP 26904

## Isthmus

ID	Botanical Name	Common Name	Number of Trees	Location/Street Address	Locality	Legal Description
2956	<i>Cypress sp</i>	Cypress	1	Springleigh Avenue 2-6	Mt Albert	Lot 11 DP 39610
271	<i>Araucaria heterophylla</i>	Norfolk Island Pine	1	St Andrews Road 15	Epsom	Lot 1 DP 192839
747	<i>Washingtonia robusta,</i>	Cotton Palm	2	St Andrews Road 75	Epsom	Lot 71 DP 19332
850	<i>Podocarpus totara</i>	Totara	2	St Andrews Road 82	Epsom	Pt Lot 1 DP 49439
851	<i>Metrosideros excelsa</i>	Pöhutukawa	2	St Andrews Road 176	Epsom	Lot 1 DP 30056
768	<i>Metrosideros excelsa, Araucaria heterophylla, Ficus macrophylla, Podocarpus elatus, Podocarpus totara, Vitex lucens, Aesculus hippocastanum, Araucaria cunninghamii, Liquidambar styraciflua, Quercus ilex, Cordyline australis, Corynocarpus laevigatus, Quercus canariensis, Dysoxylum spectabile</i>	Pöhutukawa (13), Norfolk Island Pine (2), Moreton Bay Fig, Plum Pine, Totara (2), Puriri (3), Horse Chestnut, Hoop Pine, Red Gum, Holm Oak (3), Cabbage Tree (6), Karaka(2), Algerian Oak, Kohekohe		St Andrews Road 183	Epsom	Pt Lot 7 DP 3468
991	<i>Vitex lucens</i>	Puriri	1	St Andrews Road 194	Epsom	Lot 3 DP 21988
849	<i>Metrosideros excelsa</i>	Pöhutukawa	1	St Andrews Road 198	Epsom	Pt Lot 1 DP 21988
891	<i>Araucaria heterophylla</i>	Norfolk Island Pine	1	St Georges Bay Road 3- 3A	Parnell	Lot 4 DP 93399
803	<i>Metrosideros excelsa</i>	Pöhutukawa	1	St Georges Bay Road 25	Parnell	Lot 1 DP 31042
239	<i>Quercus robur</i>	English Oak	3	St Heliers Bay Road 349	St Heliers	Lot 4 DP 205773
238	<i>Podocarpus totara, Agathis australis, Quercus robur, Cupressus macrocarpa, Pinus pinaster</i>	Totara, Kauri, English Oak, Macrocarpa (3), Maritime Pines (12)	18	St Johns Road 188-280	Meadowbank	Lot 1 DP 205773
352	<i>Ficus rubiginosa</i>	Port Jackson Fig	1	St Jude Street 25-27	Avondale	Pt Allotment 164 PSH OF Titirangi
67	<i>Alectryon excelsus</i>	Titoki	1	St Marys Road 20	Ponsonby	Pt Allotment 13 SECT 8 SBRS OF Auckland
76	<i>Quercus canariensis, Quercus robur, Agathis australis</i>	Spanish Oak, English Oak (13), Kauri	15	St Marys Road 43-59	Ponsonby	Lot 1 DP 20314
100	<i>Metrosideros excelsa</i>	Pöhutukawa	1	St Michaels Avenue 10	Point Chevalier	Lot 77 DP 7475
150	<i>Araucaria heterophylla</i>	Norfolk Island Pine	1	St Stephens Avenue 12	Parnell	Lot 2 DP 36022
149	<i>Quercus palustris</i>	Pin Oak	1	St Stephens Avenue 36	Parnell	Lot 1 DP 23603
159	<i>Quercus nigra, Metrosideros excelsa, Quercus robur</i>	Water Oak, Pöhutukawa, English Oak (2)	4	St Stephens Avenue 48- 82	Parnell	Pt Lot 9 DP 22798
157	<i>Metrosideros excelsa</i>	Pöhutukawa	1	St Stephens Avenue 95	Parnell	Lot 1 DP 45795
685	<i>Metrosideros excelsa</i>	Pöhutukawa	4	St Stephens Avenue 119	Parnell	Lot 3 DP 36018
62	<i>Metrosideros excelsa</i>	Pöhutukawa	2	Stack Street 1	Herne Bay	Pt Lot 5 DP 2335
852	<i>Araucaria heterophylla</i>	Norfolk Island Pine	1	Station Road 50	Otahuhu	Lot 1 DP 38318
647	<i>Quercus frainetto</i>	Hungarian Oak	1	Station Road 101	Otahuhu	Lot 5 DP 25538
254	<i>Metrosideros excelsa</i>	Pöhutukawa	1	Stilwell Road (road reserve outside #29)	Mt Albert	
671	<i>Metrosideros excelsa</i>	Pöhutukawa	1	Sturges Avenue 9	Otahuhu	Lot 6 DP 16451
703	<i>Metrosideros excelsa</i>	Pöhutukawa	2	Sudeley Street 34	Orakei	Lot 2 DP 188152
853	<i>Podocarpus totara</i>	Totara		Summit Drive 7	Mt Albert	Lot 31 DP 3280

## Isthmus

ID	Botanical Name	Common Name	Number of Trees	Location/Street Address	Locality	Legal Description
740	<i>Metrosideros excelsa</i>	Pōhutukawa	1	Summit Drive 36-38	Mt Albert	Lot 1 DP 72298
323	<i>Quercus robur</i>	English Oak	1	Sunnyvale Road 14	Greenlane	Lot 16 DP 7432
480	<i>Metrosideros excelsa</i>	Pōhutukawa	2	Sunset View Road 4	Panmure	Lot 6 DP 18395
481	<i>Metrosideros excelsa</i> , <i>Fagus sylvatica</i> 'purpurea'	Pōhutukawa, Copper Beech	2	Sunset View Road 16	Panmure	Lot 1 DP 60514
111	<i>Vitex lucens</i> , <i>Metrosideros excelsa</i> , <i>Pinus radiata</i> , <i>Cupressus macrocarpa</i> , <i>Vitex lucens</i>	Puriri, Pōhutukawa, Radiata Pine, Macrocarpa, Puriri	5	Surrey Crescent 44	Grey Lynn	Lot 12 ALLT 16 Section 9 SBRS OF Auckland
113	<i>Vitex lucens</i> <i>Metrosideros excelsa</i> <i>Phoenix canariensis</i>	English Oak, Pōhutukawa (2), Phoenix Palm, (2), English Oak	6	Surrey Crescent 92-96	Grey Lynn	Lot 7 DP 20423
937	<i>Metrosideros kermadecensis</i> , <i>Meryta sinclairii</i> , <i>Cordyline australis</i> , <i>Agathis australis</i>	Kermadec Island Pōhutukawa, Puka, Cabbage Tree (2), Kauri		Sussex Street 9-11	Grey Lynn	Lot 32 Blk 5 DP 282
608	<i>Araucaria heterophylla</i> , <i>Ficus macrophylla</i> , <i>Phoenix canariensis</i> , <i>Metrosideros excelsa</i>	Norfolk Island Pine (2), Moreton Bay Fig, Phoenix Palm, Pōhutukawa (3)	7	Symonds Street 7	Onehunga	Lot 1 DP 320447
515	<i>Castanea sativa</i> , <i>Metrosideros excelsa</i> , <i>Podocarpus totara</i> , <i>Liquidambar styraciflua</i>	Sweet Chestnut, Pōhutukawa (3), Totara (2), Liquidambar	7	Symonds Street 74	Onehunga	Pt Allotment 1 SECT 38 VILL OF Onehunga, Allotment 33 SECT 38 VILL OF Onehunga
562	<i>Metrosideros excelsa</i> , <i>Agathis australis</i>	Pōhutukawa, Kauri	2	Taiere Terrace 8	Onehunga	Lot 1 DP 364108
561	<i>Agathis australis</i>	Kauri	1	Taiere Terrace 9A	Onehunga	Lot 2 DP 210892
548	<i>Aloe bainesii</i>	Tree Aloe	1	Taiere Terrace 15A	Onehunga	Lot 1 DP 369038
704	<i>Agathis australis</i>	Kauri	1	Takitimu Street 50A	Orakei	Lot 83 DP 37694
160	<i>Quercus robur</i>	English Oak	1	Takutai Street 13	Parnell	Lot 1 DP 165168
90	<i>Araucaria heterophylla</i>	Norfolk Island Pine	2	Tamaki Drive 40-44	Mission Bay	Lot 2 DP 22640
167	<i>Metrosideros excelsa</i> , <i>Ficus macrophylla</i>	Pōhutukawa (3), Moreton Bay Fig	4	Tamaki Drive 301	Kohimarama	Lot 1 DP 192860
168	<i>Ficus macrophylla</i>	Moreton Bay Fig	2	Tamaki Drive 353-359 (reserve)	St Heliers	Pt Allotment 25 DIST OF Tamaki
169	<i>Metrosideros excelsa</i>	Pōhutukawa	1	Tamaki Drive (road reserve outside # 347)	St Heliers	
101	<i>Phoenix canariensis</i>	Phoenix Palm	15	Target Street 43	Point Chevalier	Lot 1 DP 194801
765	<i>Metrosideros excelsa</i>	Pōhutukawa	1	Taumata Road 20	Sandringham	Lot 187 DP 5007
1000	<i>Kunzea ericoides</i>	Kanuka		Taumata Road 56	Sandringham	Lot 37 DP 10465
1001	<i>Kunzea ericoides</i> , <i>Podocarpus totara</i> , <i>Dysoxylum spectabile</i> , <i>Rhopalostylis sapida</i>	Kanuka, Totara, Kohekohe (2), Nikau	5	Taumata Road 58B & C	Sandringham	Lot 36 DP 10465
602	<i>Metrosideros excelsa</i>	Pōhutukawa	1	Taunton Terrace 75	Blockhouse Bay	Pt Lot 1 DP 27764
854	<i>Dacrycarpus dacrydioides</i>	Kahikatea	1	Tautari Street 5	Orakei	Lot 343 DP 45581
707	<i>Metrosideros excelsa</i>	Pōhutukawa	1	Tautari Street 9	Orakei	Lot 345 DP 38385
705	<i>Metrosideros excelsa</i>	Pōhutukawa	1	Tautari Street 37	Orakei	Lot 395 DP 38385
706	<i>Metrosideros excelsa</i>	Pōhutukawa	1	Tautari Street 77	Orakei	Lot 1 DP 114386
563	<i>Metrosideros excelsa</i>	Pōhutukawa	1	Tawa Road 24	Onehunga	Lot 4 DP 19966



## Isthmus

ID	Botanical Name	Common Name	Number of Trees	Location/Street Address	Locality	Legal Description
565	<i>Agathis australis</i>	Kauri	1	Tawa Road 38	Onehunga	Lot 53 DP 3646
543	<i>Metrosideros excelsa</i>	Pōhutukawa	1	Tawa Road 39	Onehunga	Lot 1 DP 449794
539	<i>Metrosideros excelsa</i>	Pōhutukawa	1	Tawa Road 47	Onehunga	Lot 2 DP 19319
566	<i>Podocarpus totara</i>	Totara	1	Tawa Road 50B	Onehunga	Lot 3 DP 50309
567	<i>Metrosideros excelsa</i>	Pōhutukawa	1	Tawa Road 63	Onehunga	Lot 1 DP 319077
325	<i>Vitex lucens</i>	Puriri	1	Tawera Road 10	Greenlane	Pt Lot 34 DP 3317
326	<i>Ginkgo biloba</i>	Ginkgo	1	Tawera Road 14	Greenlane	Lot 2 DP 27713
797	<i>Metrosideros excelsa</i> , <i>Agathis australis</i> , <i>Dacrydium cupressinum</i>	Pōhutukawa, Kauri, Rimu	3	Tawhiri Road 2	One Tree Hill	Lot 2 DP 54691
417	<i>Metrosideros excelsa</i>	Pōhutukawa	1	Tawhiri Road 31	One Tree Hill	Lot 92 DP 7941
492	<i>Dacrycarpus dacrydioides</i>	Kahikatea	1	Te Koa Road 50	Panmure	Lot 47 DP 37895
102	<i>Cinnamomum camphora</i> , <i>Metrosideros excelsa</i> , <i>Podocarpus totara</i> , <i>Quercus robur</i>	Camphor Laurel, Pōhutukawa, Totara, Common Oak (2)	5	Te Ra Road 7-31	Point Chevalier	Lot 1 DP 179987
438	<i>Magnolia grandiflora</i>	Magnolia	1	Tecoma Street 6	Ellerslie	Lot 1 DP 135802
375	<i>Agathis australis</i> , <i>Ginkgo biloba</i>	Kauri, Ginkgo	2	The Drive 104	Epsom	Lot 1 DP 77766
829	<i>Vitex lucens</i>	Puriri	1	The Drive 130	Epsom	Lot 19 DP 8179
161	<i>Metrosideros excelsa</i>	Pōhutukawa	1	Tohunga Crescent (road reserve outside #29)	Parnell	
802	<i>Metrosideros excelsa</i>	Pōhutukawa		Tohunga Crescent 62	Parnell	Lot 23 DP 9448
347	<i>Persea americana</i>	Avocado	1	Torino Street 21	Point England	Lot 483 DP 39860
533	<i>Dacrydium cupressinum</i>	Rimu	1	Trafalgar Street 76A	Onehunga	Lot 1 DP 152938
534	<i>Agathis australis</i>	Kauri	1	Trafalgar Street 93	Onehunga	Lot 2 DP 50881
532	<i>Agathis australis</i>	Kauri	2	Trafalgar Street 151	Onehunga	Lot 2 DP 49284
479	<i>Metrosideros excelsa</i> , <i>Populus deltoides</i> , <i>Platanus acerifolia</i> , <i>Metrosideros excelsa</i> , <i>Populus yunnanensis</i> , <i>Quercus robur</i>	Pōhutukawa, Cottonwood (4), Chinese Poplar (3), English Oak (2), Plane Tree, Pōhutukawa	12	Tripoli Road 80A	Panmure	Lot 544 DP 38230
909	<i>Metrosideros excelsa</i>	Pōhutukawa	1	Tuhimata Street 26-28	St Heliers	Lot 1 DP 20407
370	<i>Dacrydium cupressinum</i>	Rimu	1	Tuperiri Road 6B	Epsom	Lot 10 DP 492258
855	<i>Metrosideros excelsa</i>	Pōhutukawa	1	Turakina Street 32	Grey Lynn	Lot 20 Blk 7 DP 282
505	<i>Vitex lucens</i> <i>Metrosideros excelsa</i>	Puriri, Pōhutukawa	2	Turama Road 3	Royal Oak	Lot 32 DEEDS 142
936	<i>Dacrydium cupressinum</i>	Rimu	1	Turama Road 41	Royal Oak	Lot 20 DP 4949
500	<i>Metrosideros excelsa</i>	Pōhutukawa	1	Turama Road 54	Royal Oak	Pt Allotment 13 SECT 12 SBRS OF Auckland
856	<i>Pinus pinaster</i>	Maritime Pine	1	Upland Road 49	Remuera	Lot 1 DP 45353
230	<i>Quercus robur</i>	English Oak	1	Upland Road 96	Remuera	Pt Lot 23 DP 7362
745	<i>Metrosideros excelsa</i>	Pōhutukawa	1	Valley Road 6-8	Mount Eden	Lot 1 DP 93869
748	<i>Vitex lucens</i>	Puriri	1	Valley Road 24	Mount Eden	Lot 1 DP 65023
754	<i>Vitex lucens</i>	Puriri	1	Valley Road 34	Mount Eden	Lot 8 DEEDS S 25
720	<i>Podocarpus totara</i>	Totara	1	Valley Road 38	Mount Eden	Lot 1 DP 414825
199	<i>Araucaria heterophylla</i> <i>Metrosideros excelsa</i>	Norfolk Island Pine, Pōhutukawa (2)	3	Valley Road 44	Mount Eden	Lot 42 DP 3705
196	<i>Eucalyptus pauciflora</i>	Snow Gum	1	Valley Road 73	Mount Eden	Pt Lot 13 DP 1
136	<i>Vitex lucens</i>	Puriri	1	Vermont Street 16	Ponsonby	Lot 30 DP 4319

## Isthmus

ID	Botanical Name	Common Name	Number of Trees	Location/Street Address	Locality	Legal Description
120	<i>Podocarpus elatus</i>	Illawara Pine	1	Vermont Street 22-24	Ponsonby	Lot 5 DP 211127
85	<i>Vitex lucens</i>	Puriri	1	Vermont Street 39	Ponsonby	Lot 1 DP 48205
636	<i>Metrosideros excelsa</i>	Pōhutukawa	1	Vestey Drive 1	Mount Wellington	Lot 1 DP 192446
727	<i>Metrosideros excelsa</i>	Pōhutukawa	2	Victoria Avenue 31	Remuera	Lot 1 DP 69296
231	<i>Metrosideros excelsa</i>	Pōhutukawa	1	Victoria Avenue 36	Remuera	Lot 22 DP 47789
726	<i>Metrosideros excelsa</i>	Pōhutukawa	1	Victoria Avenue 41	Remuera	Lot 1 DP 27939
624	<i>Vitex lucens</i>	Puriri	1	Victoria Street 61	Onehunga	Lot 1 DP 22091
623	<i>Cupressus macrocarpa</i>	Macrocarpa	1	Victoria Street 64-74	Onehunga	Lot 1 DP 93902
229	<i>Agathis robusta</i>	South Queensland Kauri	1	Victoria Avenue 139	Remuera	Pt Lot 1 DP 39388
234	<i>Metrosideros excelsa</i>	Pōhutukawa	1	Victoria Avenue 228	Remuera	Lot 2 DP 67683
164	<i>Castanospermum australe</i>	Moreton Bay Chestnut	1	Victoria Avenue 235-237	Remuera	Pt Lot 14 DP 44273
804	<i>Dacrydium cupressinum</i>	Rimu	1	Victoria Avenue 298	Remuera	Lot 4 DP 16999
722	<i>Metrosideros excelsa</i>	Pōhutukawa	1	View Road 21	Mount Eden	Lot 6 DEEDS 807
190	<i>Agathis robusta</i>	South Queensland Kauri	1	View Road 28-32	Mt Eden	Lot 1 DP 87011
951	<i>Podocarpus totara</i>	Totara	3	View Road 31A	Mount Eden	Lot 1 DP 320372
857	<i>Metrosideros excelsa</i>	Pōhutukawa		View Road 35	Mount Eden	Lot 1 DP 165523
721	<i>Vitex lucens</i>	Puriri	1	View Road 46	Mount Eden	Lot 1 DP 66290
683	<i>Quercus robur</i>	Common Oak	1	Waiaatarua Road 68	Remuera	Lot 20 DP 19744
1007	<i>Podocarpus totara</i>	Totara		Waimea Lane 22	Remuera	Lot 1 DP 199980
594	<i>Vitex lucens</i>	Puriri	2	Waipuna Road 71, 2/71 and 1/73	Mount Wellington	Lots 2 & 3 DP 199138
593	<i>Vitex lucens, Corynocarpus laevigatus</i>	Puriri (2), Karaka	3	Waipuna Road 73C	Mount Wellington	Lot 10 DP 460648
600	<i>Metrosideros excelsa</i>	Pōhutukawa	2	Waipuna Road East 118	Mount Wellington	Lot 1 DP 145453
598	<i>Metrosideros excelsa</i>	Pōhutukawa	1	Waipuna Road East 149,	Mt Wellington	Lot 23 DP 39314
599	<i>Quercus robur</i>	English Oak	1	Waipuna Road 153A	Mount Wellington	Lot 2 DP 195797
439	<i>Vitex lucens</i>	Puriri	1	Wairakei Street 37	Greenlane	Pt Allotment 7 SECT 12 SBRS OF Auckland
63	<i>Cupressus macrocarpa</i>	Macrocarpa	1	Wairangi Street 3	Herne Bay	Pt Lot 8 DP 2335
568	<i>Metrosideros excelsa</i>	Pōhutukawa	1	Waitangi Road 69	Onehunga	Pt Lot 9 DP 19300
3007	<i>Araucaria heterophylla</i>	Norfolk Island Pine	1	Walker Road 18D	Pt Chevalier	LOT 4 DP 580684, 1/5 SH LOT 6 DP 580684
3008	<i>Araucaria heterophylla</i>	Norfolk Island Pine	1	Walker Road 18E	Pt Chevalier	LOT 3 DP 580684, 1/5 SH LOT 6 DP 580684
664	<i>Metrosideros excelsa</i>	Pōhutukawa	1	Walmsley Road 60	Otahuhu	Lot 4 DP 24782
661	<i>Phoenix canariensis</i>	Phoenix Palm	1	Walmsey Road 83	Otahuhu	Lot 7 DEEDS 57
310	<i>Metrosideros excelsa</i>	Pōhutukawa	1	Wapiti Avenue 39	Epsom	Lot 10 DP 25557
107	<i>Araucaria heterophylla</i>	Norfolk Island Pine	1	Warnock Street 98	Westmere	Lot 61 DP 19195
773	<i>Metrosideros excelsa, Podocarpus totara</i>	Pōhutukawa (4), Totara	5	Warren Avenue 1	Three Kings	Lot 4 DP 39702
183	<i>Vitex lucens</i>	Puriri	1	Warwick Street 5	Western Springs	Lot 2 DP 210317

## Isthmus

ID	Botanical Name	Common Name	Number of Trees	Location/Street Address	Locality	Legal Description
770	<i>Metrosideros excelsa</i>	Pōhutukawa	2	Watling Street 1A	Mount Eden	Lot 1 DP 20205
769	<i>Agathis australis</i> , <i>Podocarpus totara</i> , <i>Metrosideros excelsa</i>	Kauri, Totara, Pōhutukawa	3	Watling Street 47	Mount Eden	Lot 2 DP 57744
118	<i>Agathis australis</i>	Kauri	1	Webber Street 25	Westmere	Lot 1 DP 120984
84	<i>Sequoiadendron giganteum</i> , <i>Sequoia sempervirens</i> , <i>Eucalyptus ficifolia</i> , <i>Metrosideros excelsa</i> , <i>Platanus orientalis</i>	Giant Redwood / Wellingtonia, Redwood (coastal), Red Flowering Gum, Pōhutukawa, Oriental Plane	5	Wellington Street 95	Freemans Bay	Pt Lot 49 DEEDS Red B
110	<i>Metrosideros excelsa</i>	Pōhutukawa	1	Weona Place 10	Westmere	Lot 34 DP 20641
907	<i>Vitex lucens</i>	Puriri	1	West End Road 1	Westmere	Lot 2 DP 1898
2983	<i>Quercus spp.</i>	Oak	1	West End Road 11	Herne Bay	Lot 3 DP 108642
695	<i>Metrosideros excelsa</i>	Pōhutukawa		West End Road 42A-42F	Westmere	Lot 1 DP 313198
240	<i>Ficus macrophylla</i>	Moreton Bay Fig	1	West Tamaki Road 172	Glen Innes	Lot 20 DP 36176
182	<i>Metrosideros excelsa</i>	Pōhutukawa	1	Western Springs Road 1-5	Kingsland	Lot 2 DP 56701
858	<i>Metrosideros excelsa</i>	Pōhutukawa	2	Western Springs Road 61	Western Springs	Lot 2 Blk II DP 339
643	<i>Ficus macrophylla</i>	Moreton Bay Fig	1	Westfield Place 8-14	Mount Wellington	Lot 3 DP 202063
879	<i>Libocedrus plumosa</i>	Kawaka	1	Wharua Road 1A	Remuera	Lot 1 DP 50795
420	<i>Populus nigra 'italica'</i>	Lombardy Poplar	2	Wheturangi Road 9	Greenlane	Lot 11 DP 18843
418	<i>Olea europaea</i>	Olive	1	Wheturangi Road 17A	Greenlane	Lot 2 DP 55654
419	<i>Dacrydium cupressinum</i>	Rimu	1	Wheturangi Road 50	Greenlane	Lot 13 DP 18124
314	<i>Metrosideros excelsa</i>	Pōhutukawa	1	Wheturangi Road 69	Greenlane	Lot 1 DP 175143
327	<i>Vitex lucens</i>	Puriri	1	Wheturangi Road 79	Greenlane	Lot 6 DP 28924
313	<i>Metrosideros excelsa</i>	Pōhutukawa	1	Wheturangi Road 89	Greenlane	Pt Lot 43 DP 3317
328	<i>Dacrycarpus dacrydioides</i> , <i>Libocedrus plumosa</i>	Kahikatea, Kawaka	2	Wheturangi Road 101	Greenlane	Lot 2 DP 40810
330	<i>Metasequoia glyptostroboides</i> , <i>Cedrus deodara</i>	Dawn Redwood, Himalayan Cedar	2	Wheturangi Road 103A	Greenlane	Lot 6 DP 43415
332	<i>Quercus robur</i>	English Oak	1	Wheturangi Road 103B	Greenlane	Lot 7 DP 43415
331	<i>Podocarpus totara</i>	Totara	1	Wheturangi Road 105E	Greenlane	Lot 2 DP 374270
329	<i>Quercus robur</i>	English Oak	2	Wheturangi Road 109	Greenlane	Lot 1 DP 15032
1004	<i>Dacrydium cupressinum</i>	Rimu	1	Wheturangi Road 136/138	Greenlane	Lot 1 DP 204272
761	<i>Agathis australis</i> , <i>Dacrydium cupressinum</i> , <i>Vitex lucens</i>	Kauri, Rimu, Puriri	3	Wilding Avenue 9	Epsom	Pt Allotment 64 DP 14183
109	<i>Vitex lucens</i>	Puriri	1	William Denny Avenue 7	Westmere	Lot 44 DP 19195
108	<i>Metrosideros excelsa</i>	Pōhutukawa	1	William Denny Avenue 28	Westmere	Lot 22 DP 19195
119	<i>Metrosideros excelsa</i>	Pōhutukawa	1	Wilton Street 6	Grey Lynn	Lot 50 DP 322
859	<i>Dacrycarpus dacrydioides</i>	Kahikatea	1	Wilton Street 22	Grey Lynn	Lot 58 DP 322

## Isthmus

ID	Botanical Name	Common Name	Number of Trees	Location/Street Address	Locality	Legal Description
494	<i>Podocarpus totara</i> , <i>Dacrydium cupressinum</i> , <i>Darcycarpus dacridioides</i> , <i>Agathis australis</i> , <i>Phyllocladys</i> <i>trichomanoides</i> , <i>Libocedrus</i> <i>plumose</i> , <i>Vitex lucens</i> , <i>Dysoxylum spectabile</i>	Totara, Rimu, Kahikatea, Kauri, Tanekaha, Kawaka, Puriri, Kohekohe	8	Windermere Crescent 34	Blockhouse Bay	Lot 36 DP 47284
281	<i>Podocarpus totara</i> , <i>Vitex</i> <i>lucens</i> , <i>Quercus robur</i>	Totara (4), Puriri, English Oak	6	Windmill Road 2	Mt Eden	Allotment 68A SECT 10 SBRS OF Auckland
883	<i>Quercus robur</i>	English Oak	1	Windmill Road 23	Mt Eden	Lot 9 DP 3015
358	<i>Metrosideros excelsa</i> , <i>Vitex</i> <i>lucens</i> , <i>Schinus mole</i> , <i>Podocarpus totara</i>	Pōhutukawa, Puriri, Pepper Tree, Totara	4	Wolverton Street 4	Avondale	Lot 15 DP 17405
717	<i>Agathis australis</i> , <i>Dacrydium cupressinum</i> , <i>Podocarpus totara</i> , <i>Vitex</i> <i>lucens</i>	Kauri (2), Rimu (2), Totara, Puriri	6	Woodford Road 25	Mt Eden	Lot 4 DEEDS Blue 64
287	<i>Picconia excelsa</i>	Canary Island Olive	1	Woodside Road 2	Mt Eden	Lot 2 DP 161692
1013	<i>Metrosideros excelsa</i>	Pōhutukawa	1	Woodside Road, 20	Mt Eden	Pt Lot 7 DP 1714
752	<i>Podocarpus totara</i> , <i>Vitex</i> <i>lucens</i>	Totara, Puriri (2)	3	Woodside Road 34A & B	Mt Eden	Lot 2 DP 200000
279	<i>Vitex lucens</i>	Puriri	1	Woodside Road 37	Mt Eden	Pt Lot 12 DP 1714
246	<i>Araucaria heterophylla</i>	Norfolk Island Pine	1	Woodward Road 8	Mt Albert	Lot 2 DP 187691
104	<i>Metrosideros excelsa</i>	Pōhutukawa	1	Wright Road 24	Pt Chevalier	Lot 24 DP 7475
188	<i>Cinnamomum camphora</i>	Camphor Tree	1	Wynyard Road 51	Mt Eden	Pt Lot 20 DEEDS Blue 8