

## UNITARY PLAN UPDATE REQUEST MEMORANDUM

**TO** Celia Davison, Unit Manager – Central South, Plans and Places

**FROM** Vanessa Leddra Policy Planner, Central South





**DATE** 3 December 2024

**SUBJECT** **Designation in accordance with s168 of the Resource Management Act of the Auckland Unitary Plan(AUP) Operative in part (15 November 2016)**



This memorandum requests an update to Auckland Unitary Plan Operative in part

<b>Reason for update – new designation</b>	
<b>Chapter</b>	Chapter K Designations
<b>Section</b>	Schedules and Designations - New Zealand Transport Agency AUP GIS Viewer
<b>Designation only</b>	
<b>Designation # 6781</b>	Bombay Commercial Vehicle Centre - New Zealand Transport Agency
<b>Location:</b>	253 Mill Road, Bombay
<b>Lapse Date</b>	10 years from date of inclusion in the Auckland Unitary Plan
<b>Purpose</b>	To construct, operate, maintain, and improve a vehicle safety centre as part of the operation of the state highway network.
<b>Changes to text (shown in underline and strikethrough)</b>	Add new designation # 6781 and conditions as per those specified in NZTA's decision, as per Attachment 1 & 3
<b>Changes to diagrams</b>	N/A
<b>Changes to spatial data</b>	Amend the GIS layer to show the new designation as requested by New Zealand Transport Agency as shown in Attachment 4 and as per extent in AUP GIS Viewer under Modifications – Notices of Requirement.
<b>Attachments</b>	Attachment 1: Notice of Decision Attachment 2: Updated NZTA Schedule and new designation text (underlined & Strikethrough) Attachment 3: Updated NZTA Schedule and new designation text (clean) Attachment 4: Updated GIS Viewer for new Designation

<b>Prepared by:</b> Vanessa Leddra Policy Planner	<b>Text Entered by:</b> Maninder Kaur-Mehta Planning Technician
<b>Signature:</b> 	<b>Signature:</b> 
<b>Maps prepared by:</b> Danica Torres Geospatial Specialist	<b>Reviewed by:</b> Craig Cairncross Team Leader
<b>Signature:</b> 	<b>Signature:</b> 
<b>Signed off by:</b> Celia Davison Manager Planning – Central/South	
<b>Signature:</b> 	

# **Attachment 1: Notice of Decision**

31/10/2024

Chief Executive  
Auckland Council  
135 Albert Street, Auckland

Via email to: [Vanessa.Leddra@aucklandcouncil.govt.nz](mailto:Vanessa.Leddra@aucklandcouncil.govt.nz)  
Vanessa Leddra, Policy Planner, Planning Central and South; Policy, Planning and Governance  
Cc to: [Rebecca.Greaves@aucklandcouncil.govt.nz](mailto:Rebecca.Greaves@aucklandcouncil.govt.nz)

Dear Vanessa

**Decision of NZ Transport Agency Waka Kotahi (NZTA) on recommendation of Auckland Council in relation to a Notice of Requirement to designate land for a vehicle safety centre (253 Mill Road, Bombay)**

NZTA gave its decision on the Auckland Council's recommendation on the Notice of Requirement (NOR) to designate land for a vehicle safety centre at 253 Mill Road, Bombay on 17 October 2024. As requested by Council<sup>1</sup>, this letter updates that earlier decision to include specific reference to the lapse date.

Council's recommendation is that the Notice of Requirement be confirmed with conditions.

Pursuant to Section 172 of the Resource Management Act 1991, NZTA:

- Accepts the Council's recommendation that the NOR should be confirmed; and
- Accepts the Council's recommendations on conditions of the NOR.

NZTA has made some minor changes in our decision version of the conditions. These minor changes are:

- Editorial i.e. punctuation and capitalisation of words; and
- In condition 2, the abbreviation "IIG" is deleted and replaced with the full term "Iwi Integration Group".

Those changes do not affect conditions content.

An additional condition is included to provide clarity on the lapse date, which reflects the Council's recommendation report paragraphs 13 and 26, and Attachment A of the recommendation.

The decision version of the conditions, showing the editorial change in Condition 2 and the additional Condition 7 is included in **Attachment 1**.

Yours sincerely



Belinda Petersen  
Principal Planner, Poutiaki Taiao / Environmental Planning  
Transport Services  
Pursuant to authority delegated by New Zealand Transport Agency Waka Kotahi  
Email: [consents@nzta.govt.nz](mailto:consents@nzta.govt.nz)

---

<sup>1</sup> Telephone conversation Rebecca Greaves to Belinda Petersen 30 October 2024

**Attachment 1:  
Council's recommended conditions, showing NZTA minor text edit in Condition 2 and additional Condition 7**

**# Council to allocate # [Bombay Commercial Vehicle Centre](#)**

Designation Number	xxxx
Requiring Authority	New Zealand Transport Authority
Location	253 Mill Road, Bombay
Lapse Date	10 years from the date on which it is included in the Auckland Unitary Plan (Operative in Part)

**Purpose**

To construct, operate, maintain, and improve a vehicle safety centre as part of the operation of the state highway network.

**Conditions**

**General conditions**

- 1 a) Except as provided for in the conditions below, works within the designation shall be undertaken in general accordance with the following plans and information submitted with the Notice of Requirement:
  - i. Notice of Requirement for a Designation of Land dated 24 October 2023, and updated 16 July 2024;
  - ii. Section 2 Description of Proposed Work in the Assessment of Effects on the Environment updated 24 January 2024;
  - iii. General Arrangement Plans, Architectural Design Plans, Landscape General Arrangement Plans, and Landscape Planting Plans included in Document and Drawing Schedule in memo dated 22 April 2024.
- b) Where there is inconsistency between the documents listed in clause (a) above and the requirements of the following conditions, the conditions shall prevail.

**Pre-construction**

- 2 Prior to the start of construction, appropriate provision shall be made for a cultural induction of the contractor's staff. The New Zealand Transport Agency (NZTA) Southern ~~##~~ **Iwi Integration Group** or its nominated representative(s) shall be invited to participate.

**Construction noise and vibration**

- 3 a) A Construction Noise and Vibration Management Plan (CNVMP) shall be prepared prior to the start of construction.
- b) The purpose of the CNVMP is to provide a framework for the development and implementation of the Best Practicable Option for the minimisation of noise and vibration effects from construction.
- c) The CNVMP shall include details in accordance with Annex E2 of NZS 6803 and the NZTA State Highway Construction and Maintenance Noise and Vibration Guide (version 1.1, 2019) or any subsequent updated version.

### Construction traffic management

- 4
- a) A Construction Traffic Management Plan (CTMP) shall be prepared prior to the start of construction.
  - b) The purpose of the CTMP is to avoid, remedy or mitigate, as far as practicable, adverse construction traffic effects. To achieve this purpose, the CTMP shall include:
    - i. Methods to manage the effects of temporary traffic management activities on traffic capacity and movements;
    - ii. Measures to manage the safety of all transport users;
    - iii. Estimated numbers, frequencies, routes, and timing of traffic movements;
    - iv. Methods to communicate traffic management measures to affected road users.
  - c) The CTMP shall be prepared:
    - i. In accordance with the New Zealand Guide to Temporary Traffic Management or any subsequent version; and
    - ii. In consultation with Auckland Transport.

#### *Advice Note:*

*Any temporary or permanent work in Great South Road will require separate approvals from Auckland Transport as the road controlling authority. These approvals are:*

- *Corridor Access Request and accompanying Traffic Management Plan (for temporary construction activities which affect the local road)*
- *Engineering Plan Approval (for permanent work in the road corridor e.g. stormwater assets, lighting, or pavement); and*
- *Asset Owner Approval (for any changes to traffic or parking controls).*

### Accidental discovery protocol

- 5
- a) An Accidental Discovery Protocol (ADP) shall be prepared prior to the start of construction. The purpose of the ADP is to set out the procedures to be followed if there are accidental archaeological discoveries which occur during construction.
  - b) The ADP shall be:
    - i. Consistent with the NZTA Minimum Standard P45 – Accidental Archaeological Discovery Specification (August 2018) or any subsequent updated version; and
    - ii. Prepared in consultation with iwi.

### Design

- 6
- Buildings and structures shall use recessive, low reflective colours and material finishes to minimise their visibility in the landscape.

### Lapse

- 7
- In accordance with Section 184(1)(c) of the Resource Management Act 1991, this designation shall lapse if not given effect to within 10 years from the date on which it is included in the Auckland Unitary Plan (Operative in Part).**

### Attachments

[No attachments.]

**Attachment 2: Updated NZTA Schedule  
and new designation text (underlined  
& Strikethrough)**

## Designation Schedule - New Zealand Transport Agency

Number	Purpose	Location
6700	Motorway	State Highway 1 from south of Quarry Road, Drury to Bombay Road, Bombay
6701	Motorway	State Highway 1 from Bombay Road to Mill Road, Bombay
6702	State Highway - declared limited access road	State Highway 1 from Mill Road to south of Beaver Road East (Waikato District Council boundary), Bombay
6703	Road	State Highway 1 at Great South Road on-ramp, Bombay
6704	State Highway - declared limited access road	State Highway 22 (Karaka Road and Paerata Road) from east of Woodlyn Drive, Karaka to Adams Drive, Pukekohe
6705	Land for road widening - 5m where indicated on Map 100, to a minimum width of 30m of road reserve	State Highway 22 (Karaka Road and Paerata Road) from east of Woodlyn Drive, Karaka to Adams Drive, Pukekohe
6706	Motorway purposes Auckland - Hamilton	State Highway 1 from north of Takanini interchange to south of Quarry Road, Drury
6707	State Highway 22	State Highway 22 (Karaka Road and Great South Road) from east of Woodlyn Road, Karaka to State Highway 1,
6708	South Western Motorway (State Highway 20)	State Highway 20 from (1) east of Great south Road, Manukau City Centre to Cavendish Drive interchange, Wiri and from (2) Massey Road to Walmsley Road, Mangere
6709	South Western Motorway (State Highway 20)	State Highway 20 from (1) Manukau Harbour Crossing to Tararata Creek, Mangere and from (2) Massey Road, Mangere to Cavendish Drive interchange, Wiri
6710	Manukau Harbour Crossing	Waterfront Road Reserve, Coronation Road, Rimu Road and Mahunga Drive, Mangere
6712	Airport Motorway (State Highway 20A)	State Highway 20A from Bader Drive to south of Kirkbride Road, Mangere
6713	George Bolt Memorial Drive	State Highway 20A (George Bolt Memorial Drive) from Kirkbride Road to Auckland International Airport,
6714	Southern Motorway (State Highway 1)	State Highway 1 from north of Highbrook Drive, Otara to south of Great South Road, Takanini
6715	Southern Motorway widening East Tamaki Road	State Highway 1 at East Tamaki Road interchange, Otara
6716	South Western Motorway - State Highway 20 (connection to State Highway 1)	State Highway 20 from Great South Road, Manukau City Centre to Cavendish Drive interchange, Wiri
6717	State Highway 20B Road purposes: the maintenance, operation and improvement of the State Highway (including road widening)	State Highway 20 (Puhinui Road) from Puhinui Road interchange to Orrs Road, Puhinui



6718	Motorway	State Highway 1 from (1) Auckland Harbour Bridge, Westhaven to Fanshawe Street, Freemans Bay and from (2) Grafton Road, Grafton to Tamaki River, Otahuhu, and State Highway 16 from (3) Newton Road, Eden Terrace to Whau River bridge, Avondale and State Highway 20 from (4) Hillborough Road, Hillsborough to Manukau Harbour Crossing, Onehunga
6719	Motorway - Shelley Beach Road priority lane	State Highway 1 at Shelly Beach Road, Westhaven
6720	Motorway - Newmarket Viaduct improvement project	State Highway 1 from Gillies Avenue to St Marks Road off-ramp, Newmarket
6721	Motorway - Victoria Park tunnel project	State Highway 1 from Victoria Park, Auckland Central to Shelley Beach Road off-ramp, Westhaven
6722	To alter designation A07-01, SH16, causeway and Rosebank Peninsula	State Highway 16 from the causeway to north of Patiki Road on-ramp, Avondale
6723	To alter designation A07-01, SH16, between Great North Road and St Lukes Interchange ...	State Highway 16 from Great North Road, Avondale to St Lukes Road, Western Springs
6724	The designation provides for the construction, and subsequent operation, maintenance and minor improvement of the motorway	State Highway 16 in the vicinity of (1) Patiki Road, Avondale and (2) Rosebank Road, Avondale
6725	Construction of a public road to provide access to properties at the northern end of Patiki Road	State Highway 16 on Patiki Road, Avondale
6726	For a new designation, SH16, SH20 and Great North underpass – NOR4. A new surface designation for ...	State Highway 20 from Great North Road (in the vicinity of Alverston Street) to the northern portal (vicinity of Great North Road interchange), Waterview
6727	12.2 metre height restriction affecting land within 76.2 meters of the centre line of the Newmarket Viaduct	Vicinity of Newmarket Viaduct (State Highway 1), Newmarket
6728	For a new designation, SH20 tunnels, Great North Road underpass to Alan Wood Reserve ...	State Highway 20 from Alan Wood Reserve, Mt Roskill to Great North Road, Waterview
6729	Proposed motorway; proposed motorway and railway; proposed road, Hayr Road to Richardson Road ...	State Highway 20 from Hillsborough Road, Hillborough to Maioro Street, Mt Roskill
6730	For new designation, SH20, southern tunnel portal to Maioro Street interchange	State Highway 20 from Maioro Street to Alan Wood Reserve, Mt Roskill
6731	The designation is for the following work: ...	State Highway 20 from Queenstown Road, Hillsborough to Ernie Pinches Street, Mt Roskill Hillsborough Road
6732	The designation is for the following work: ...	State Highway 20 from Queenstown Road, Hillborough to Maioro Street, Mt Roskill
6733	The designation is for the following work: ...	State Highway 20 in the vicinity of Earnie Pinches Street, My Roskill

6734	Otahuhu Southern Motorway	State Highway 1 at Otahuhu interchange, Otahuhu
6735	The designation is to include, and allow for, the control of this State Highway, including planning, design, supervision, construction and maintenance ...	State Highway 1 from Wellington Street to Victoria Park, Auckland Central
6736	The designation is to include, and allow for, the control of this State Highway, including planning, design, supervision, construction and maintenance ...	State Highway 1 and 16 from Grafton Road, Grafton to Wellington Street, Auckland Central and State Highway 16 from Parnell Rise to Newton Road, Auckland Central
6738	Alteration to designation NZTA1, SH16, between Whau River and Henderson Creek ...	State Highway 16 from Whau Creek to Henderson Creek, Te Atatu
6740	N/A	State Highway 16 from north end of Fred Taylor Drive to Brigham Creek, Whenuapai
6741	N/A	State Highways 16 from Westgate interchange, Westgate to Brigham Creek Road intersection, Whenuapai and State Highway 18 from Westgate interchange, Westgate to Greenhithe Bridge, Hobsonville
6742	Refer NOR-2010-1559	State Highway 16 from Henderson Creek, Henderson to Huruheru Road Bridge, Massey
6743	Refer NOR-2010-1136	State Highway 16 from west of Huruheru Road bridge, Massey to Westgate interchange, Westgate
6744	N/A	State Highway 16 south of Westgate interchange, Westgate
6747	Motorway administration and maintenance	28 Sulphur Beach Road, Northcote
6748	Auckland Harbour Bridge works depot and anchorage	9 Princes Street, Northcote Point
6749	Auckland Harbour Bridge works depot and anchorage	Queen Street (Pt Allotment 68 TTN of Woodside) , Northcote Point
6750	Auckland-Waiwera Motorway (State Highway 1), including planning, design, supervision, construction and maintenance ...	State Highway 1 from Auckland Harbour Bridge, Northcote to Greville Road interchange, Albany
6751	Proposed Motorway (Auckland/Waiwera Motorway State Highway 1), including planning, design, supervision, construction	State Highway 1 from Greville Road interchange, Albany to Lonely Track Road, Albany
6753	State Highway 18 - the control, management and improvement of the State Highway ...	State Highway 18 from Constellation Drive interchange (State Highway 1) to west of Paul Matthews Road, Rosedale
6756	State Highway 18 - the control, management and improvement of the State Highway ...	State Highway 18 (Upper Harbour Highway) from west of Paul Matthews Road, Rosedale to Upper Harbour Bridge, Greenhithe
6757	The North Shore Busway ...	North Shore Busway from south of Onewa Road interchange, Onewa to Constellation Drive interchange,
6758	Constellation Drive Station ...	Corner Constellation Drive interchange and State Highway 1, Rosedale

6759	Motorway	State Highway 1, Silverdale interchange, Silverdale
6760	Motorway	State Highway 1 from Lonely Track Road, Redvale to Silverdale interchange, Silverdale
6761	Motorway and limited access highway and associated interchange	State Highway 1 from Bankside Road, Silverdale to Titfords Bridge, Puhoi
6762	Withdrawn	
6763	State Highway 1	State Highway 1 from Titfords Bridge, Puhoi to Ross Road (Kaipara District Council boundary), Topuni
6764	Withdrawn	
6765	State Highway 1 / Wayby Valley Road / Wayby Station Road intersection	State Highway 1 intersection with Wayby Station Road and Wayby Valley Road, Wellsford
6766	State Highway 16	State Highway 16 from Brigham Creek, Hobsonville to State Highway 1, Wellsford
6768	Road widening	State Highway 16 (Main Road), Kumeu and Huapai
6769	The construction, operation and maintenance of a State highway (Ara Tūhono - Pūhoi to Wellsford Road of National Significance: Pūhoi to Warkworth Section)	State Highway 1, Puhoi to Warkworth
6770	Construction, operation and maintenance of a component of the State Highway 20A Airport Project	1 Ascot Road, Mangere
6771	Construction, operation and maintenance of a component of the State Highway 20A Airport Project	2 Ascot Road, Mangere
6772	Road widening	State Highway 16 from Brighams Creek Road, Whenuapai to Taupaki Road, Taupaki
6773	To construct, operate and maintain Section 2 (St Johns Road to Meadowbank Train Station) of the Glen Innes to Tamaki Drive proposed shared pedestrian and cycle path.	Pourewa Valley within the area bounded by St Johns Road (St Johns) to the east, Orakei Basin to the west, Whytehead Crescent, Edison Place and John Rymer Place and the Pourewa Creek (Kohimarama) to the north and North Island Main Trunk Line, Purewa Cemetery, Tahapa Crescent and Purewa Road (Meadowbank) to the south.
6774	Construction, operation and maintenance of a State highway, being the East West Link between Onehunga and Ōtāhuhu, and associated works.	Between Onehunga and Ōtāhuhu on the northern side of the Māngere Inlet
6775	The construction, operation and maintenance of the busway and ancillary works including approaches, ramp connections, ancillary safety and operational services (including communications), vegetation removal, stormwater treatment, temporary construction works including storage areas and office facilities, maintenance and access areas, mitigation and restoration, ancillary structures and activities associated with these works.	State Highway 1 – Northern Busway Extension. Adjacent to the east of State Highway 1 from Constellation Bus Station and connection across State Highway 1 to the Albany Bus Station

6776	Shared Use Path – for the construction, operation and maintenance of the Shared Use Path and ancillary works including approaches, ramp connections, ancillary safety and operational services (including communications), vegetation removal, stormwater treatment, temporary construction works including storage areas and office facilities, maintenance and access areas, mitigation and restoration, ancillary structures and activities associated with these works.	State Highway 1 and State Highway 18 Shared Use Path. Adjacent to the east of State Highway 1 from Constellation Bus Station to Oteha Road, adjacent to the north of State Highway 18 from Constellation Drive to Albany Highway, and intermediate linkages to the local network
6777	Weiti Crossing	East Coast Road, Redvale (crossing Weiti River) to corner Whangaparaoa Road and Cedar Road, Whangaparaoa
6778	Designation for the construction, operation and maintenance of a shared path and associated infrastructure.	State Highway 1 from north of Takanini Interchange to south of Quarry Road, Drury; from north of the Papakura Interchange through to Otūwairoa (Slippery Creek) Bridge; from north of Bremner Road to the Drury Interchange.
6779	Construction, operation and maintenance of a new state highway and associated activities between Warkworth and north of Te Hana	Between Warkworth and Te Hana
6781	<u>To construct, operate, maintain, and improve a vehicle safety centre as part of the operation of the state highway network.</u>	<u>253 Mill Road, Bombay</u>

## 6781 Bombay Commercial Vehicle Centre

<u>Designation Number</u>	<u>6781</u>
<u>Requiring Authority</u>	<u>New Zealand Transport Authority</u>
<u>Location</u>	<u>253 Mill Road, Bombay</u>
<u>Lapse Date</u>	<u>10 years from the date on which it is included in the Auckland Unitary Plan (Operative in Part)</u>

## Purpose

To construct, operate, maintain, and improve a vehicle safety centre as part of the operation of the state highway network.

## Conditions

### General Conditions

1. a) Except as provided for in the conditions below, works within the designation shall be undertaken in general accordance with the following plans and information submitted with the Notice of Requirement:
  - i. Notice of Requirement for a Designation of Land dated 24 October 2023, and updated 16 July 2024;
  - ii. Section 2 Description of Proposed Work in the Assessment of Effects on the Environment updated 24 January 2024;
  - iii. General Arrangement Plans, Architectural Design Plans, Landscape General Arrangement Plans, and Landscape Planting Plans included in Document and Drawing Schedule in memo dated 22 April 2024.
- b) Where there is inconsistency between the documents listed in clause (a) above and the requirements of the following conditions, the conditions shall prevail.

### Pre-construction

2. Prior to the start of construction, appropriate provision shall be made for a cultural induction of the contractor's staff. The New Zealand Transport Agency (NZTA) Southern ~~HC~~ **Iwi Integration Group** or its nominated representative(s) shall be invited to participate.

### Construction noise and vibration

3. a) A Construction Noise and Vibration Management Plan (CNVMP) shall be prepared prior to the start of construction.
- b) The purpose of the CNVMP is to provide a framework for the development and implementation of the Best Practicable Option for the minimisation of noise and vibration effects from construction.

- c) The CNVMP shall include details in accordance with Annex E2 of NZS 6803 and the NZTA State Highway Construction and Maintenance Noise and Vibration Guide (version 1.1, 2019) or any subsequent updated version.

Construction traffic management

4. a) A Construction Traffic Management Plan (CTMP) shall be prepared prior to the start of construction.
- b) The purpose of the CTMP is to avoid, remedy or mitigate, as far as practicable, adverse construction traffic effects. To achieve this purpose, the CTMP shall include:
- i. Methods to manage the effects of temporary traffic management activities on traffic capacity and movements;
  - ii. Measures to manage the safety of all transport users;
  - iii. Estimated numbers, frequencies, routes, and timing of traffic movements;
  - iv. Methods to communicate traffic management measures to affected road users.
- c) The CTMP shall be prepared:
- i. Methods to manage the effects of temporary traffic management activities on traffic capacity and movements;
  - ii. In consultation with Auckland Transport.

Advice Note:

Any temporary or permanent work in Great South Road will require separate approvals from Auckland Transport as the road controlling authority. These approvals are:

- Corridor Access Request and accompanying Traffic Management Plan (for temporary construction activities which affect the local road)
- Engineering Plan Approval (for permanent work in the road corridor e.g. stormwater assets, lighting, or pavement); and
- Asset Owner Approval (for any changes to traffic or parking controls).

Accidental discovery protocol

5. a) An Accidental Discovery Protocol (ADP) shall be prepared prior to the start of construction. The purpose of the ADP is to set out the procedures to be followed if there are accidental archaeological discoveries which occur during construction.
- b) The ADP shall be:
- i. Consistent with the NZTA Minimum Standard P45 – Accidental Archaeological Discovery Specification (August 2018) or any subsequent updated version; and
  - ii. Prepared in consultation with iwi.

### Design

6. Buildings and structures shall use recessive, low reflective colours and material finishes to minimise their visibility in the landscape.

### Lapse

7. In accordance with Section 184(1)(c) of the Resource Management Act 1991, this designation shall lapse if not given effect to within 10 years from the date on which it is included in the Auckland Unitary Plan (Operative in Part).

## Attachments

[No attachments.]

**Attachment 3: Updated NZTA Schedule  
and new designation text (clean)**



## Designation Schedule - New Zealand Transport Agency

Number	Purpose	Location
6700	Motorway	State Highway 1 from south of Quarry Road, Drury to Bombay Road, Bombay
6701	Motorway	State Highway 1 from Bombay Road to Mill Road, Bombay
6702	State Highway - declared limited access road	State Highway 1 from Mill Road to south of Beaver Road East (Waikato District Council boundary), Bombay
6703	Road	State Highway 1 at Great South Road on-ramp, Bombay
6704	State Highway - declared limited access road	State Highway 22 (Karaka Road and Paerata Road) from east of Woodlyn Drive, Karaka to Adams Drive, Pukekohe
6705	Land for road widening - 5m where indicated on Map 100, to a minimum width of 30m of road reserve	State Highway 22 (Karaka Road and Paerata Road) from east of Woodlyn Drive, Karaka to Adams Drive, Pukekohe
6706	Motorway purposes Auckland - Hamilton	State Highway 1 from north of Takanini interchange to south of Quarry Road, Drury
6707	State Highway 22	State Highway 22 (Karaka Road and Great South Road) from east of Woodlyn Road, Karaka to State Highway 1,
6708	South Western Motorway (State Highway 20)	State Highway 20 from (1) east of Great south Road, Manukau City Centre to Cavendish Drive interchange, Wiri and from (2) Massey Road to Walmsley Road, Mangere
6709	South Western Motorway (State Highway 20)	State Highway 20 from (1) Manukau Harbour Crossing to Tararata Creek, Mangere and from (2) Massey Road, Mangere to Cavendish Drive interchange, Wiri
6710	Manukau Harbour Crossing	Waterfront Road Reserve, Coronation Road, Rimu Road and Mahunga Drive, Mangere
6712	Airport Motorway (State Highway 20A)	State Highway 20A from Bader Drive to south of Kirkbride Road, Mangere
6713	George Bolt Memorial Drive	State Highway 20A (George Bolt Memorial Drive) from Kirkbride Road to Auckland International Airport,
6714	Southern Motorway (State Highway 1)	State Highway 1 from north of Highbrook Drive, Otara to south of Great South Road, Takanini
6715	Southern Motorway widening East Tamaki Road	State Highway 1 at East Tamaki Road interchange, Otara
6716	South Western Motorway - State Highway 20 (connection to State Highway 1)	State Highway 20 from Great South Road, Manukau City Centre to Cavendish Drive interchange, Wiri
6717	State Highway 20B Road purposes: the maintenance, operation and improvement of the State Highway (including road widening)	State Highway 20 (Puhinui Road) from Puhinui Road interchange to Orrs Road, Puhinui

6718	Motorway	State Highway 1 from (1) Auckland Harbour Bridge, Westhaven to Fanshawe Street, Freemans Bay and from (2) Grafton Road, Grafton to Tamaki River, Otahuhu, and State Highway 16 from (3) Newton Road, Eden Terrace to Whau River bridge, Avondale and State Highway 20 from (4) Hillborough Road, Hillsborough to Manukau Harbour Crossing, Onehunga
6719	Motorway - Shelley Beach Road priority lane	State Highway 1 at Shelly Beach Road, Westhaven
6720	Motorway - Newmarket Viaduct improvement project	State Highway 1 from Gillies Avenue to St Marks Road off-ramp, Newmarket
6721	Motorway - Victoria Park tunnel project	State Highway 1 from Victoria Park, Auckland Central to Shelley Beach Road off-ramp, Westhaven
6722	To alter designation A07-01, SH16, causeway and Rosebank Peninsula	State Highway 16 from the causeway to north of Patiki Road on-ramp, Avondale
6723	To alter designation A07-01, SH16, between Great North Road and St Lukes Interchange ...	State Highway 16 from Great North Road, Avondale to St Lukes Road, Western Springs
6724	The designation provides for the construction, and subsequent operation, maintenance and minor improvement of the motorway	State Highway 16 in the vicinity of (1) Patiki Road, Avondale and (2) Rosebank Road, Avondale
6725	Construction of a public road to provide access to properties at the northern end of Patiki Road	State Highway 16 on Patiki Road, Avondale
6726	For a new designation, SH16, SH20 and Great North underpass – NOR4. A new surface designation for ...	State Highway 20 from Great North Road (in the vicinity of Alverston Street) to the northern portal (vicinity of Great North Road interchange), Waterview
6727	12.2 metre height restriction affecting land within 76.2 meters of the centre line of the Newmarket Viaduct	Vicinity of Newmarket Viaduct (State Highway 1), Newmarket
6728	For a new designation, SH20 tunnels, Great North Road underpass to Alan Wood Reserve ...	State Highway 20 from Alan Wood Reserve, Mt Roskill to Great North Road, Waterview
6729	Proposed motorway; proposed motorway and railway; proposed road, Hayr Road to Richardson Road ...	State Highway 20 from Hillsborough Road, Hillborough to Maioro Street, Mt Roskill
6730	For new designation, SH20, southern tunnel portal to Maioro Street interchange	State Highway 20 from Maioro Street to Alan Wood Reserve, Mt Roskill
6731	The designation is for the following work: ...	State Highway 20 from Queenstown Road, Hillsborough to Ernie Pinches Street, Mt Roskill Hillsborough Road
6732	The designation is for the following work: ...	State Highway 20 from Queenstown Road, Hillborough to Maioro Street, Mt Roskill
6733	The designation is for the following work: ...	State Highway 20 in the vicinity of Earnie Pinches Street, My Roskill

6734	Otahuhu Southern Motorway	State Highway 1 at Otahuhu interchange, Otahuhu
6735	The designation is to include, and allow for, the control of this State Highway, including planning, design, supervision, construction and maintenance ...	State Highway 1 from Wellington Street to Victoria Park, Auckland Central
6736	The designation is to include, and allow for, the control of this State Highway, including planning, design, supervision, construction and maintenance ...	State Highway 1 and 16 from Grafton Road, Grafton to Wellington Street, Auckland Central and State Highway 16 from Parnell Rise to Newton Road, Auckland Central
6738	Alteration to designation NZTA1, SH16, between Whau River and Henderson Creek ...	State Highway 16 from Whau Creek to Henderson Creek, Te Atatu
6740	N/A	State Highway 16 from north end of Fred Taylor Drive to Brigham Creek, Whenuapai
6741	N/A	State Highways 16 from Westgate interchange, Westgate to Brigham Creek Road intersection, Whenuapai and State Highway 18 from Westgate interchange, Westgate to Greenhithe Bridge, Hobsonville
6742	Refer NOR-2010-1559	State Highway 16 from Henderson Creek, Henderson to Huruheru Road Bridge, Massey
6743	Refer NOR-2010-1136	State Highway 16 from west of Huruheru Road bridge, Massey to Westgate interchange, Westgate
6744	N/A	State Highway 16 south of Westgate interchange, Westgate
6747	Motorway administration and maintenance	28 Sulphur Beach Road, Northcote
6748	Auckland Harbour Bridge works depot and anchorage	9 Princes Street, Northcote Point
6749	Auckland Harbour Bridge works depot and anchorage	Queen Street (Pt Allotment 68 TTN of Woodside) , Northcote Point
6750	Auckland-Waiwera Motorway (State Highway 1), including planning, design, supervision, construction and maintenance ...	State Highway 1 from Auckland Harbour Bridge, Northcote to Greville Road interchange, Albany
6751	Proposed Motorway (Auckland/Waiwera Motorway State Highway 1), including planning, design, supervision, construction	State Highway 1 from Greville Road interchange, Albany to Lonely Track Road, Albany
6753	State Highway 18 - the control, management and improvement of the State Highway ...	State Highway 18 from Constellation Drive interchange (State Highway 1) to west of Paul Matthews Road, Rosedale
6756	State Highway 18 - the control, management and improvement of the State Highway ...	State Highway 18 (Upper Harbour Highway) from west of Paul Matthews Road, Rosedale to Upper Harbour Bridge, Greenhithe
6757	The North Shore Busway ...	North Shore Busway from south of Onewa Road interchange, Onewa to Constellation Drive interchange,
6758	Constellation Drive Station ...	Corner Constellation Drive interchange and State Highway 1, Rosedale

6759	Motorway	State Highway 1, Silverdale interchange, Silverdale
6760	Motorway	State Highway 1 from Lonely Track Road, Redvale to Silverdale interchange, Silverdale
6761	Motorway and limited access highway and associated interchange	State Highway 1 from Bankside Road, Silverdale to Titfords Bridge, Puhoi
6762	Withdrawn	
6763	State Highway 1	State Highway 1 from Titfords Bridge, Puhoi to Ross Road (Kaipara District Council boundary), Topuni
6764	Withdrawn	
6765	State Highway 1 / Wayby Valley Road / Wayby Station Road intersection	State Highway 1 intersection with Wayby Station Road and Wayby Valley Road, Wellsford
6766	State Highway 16	State Highway 16 from Brigham Creek, Hobsonville to State Highway 1, Wellsford
6768	Road widening	State Highway 16 (Main Road), Kumeu and Huapai
6769	The construction, operation and maintenance of a State highway (Ara Tūhono - Pūhoi to Wellsford Road of National Significance: Pūhoi to Warkworth Section)	State Highway 1, Puhoi to Warkworth
6770	Construction, operation and maintenance of a component of the State Highway 20A Airport Project	1 Ascot Road, Mangere
6771	Construction, operation and maintenance of a component of the State Highway 20A Airport Project	2 Ascot Road, Mangere
6772	Road widening	State Highway 16 from Brighams Creek Road, Whenuapai to Taupaki Road, Taupaki
6773	To construct, operate and maintain Section 2 (St Johns Road to Meadowbank Train Station) of the Glen Innes to Tamaki Drive proposed shared pedestrian and cycle path.	Pourewa Valley within the area bounded by St Johns Road (St Johns) to the east, Orakei Basin to the west, Whytehead Crescent, Edison Place and John Rymer Place and the Pourewa Creek (Kohimarama) to the north and North Island Main Trunk Line, Purewa Cemetery, Tahapa Crescent and Purewa Road (Meadowbank) to the south.
6774	Construction, operation and maintenance of a State highway, being the East West Link between Onehunga and Ōtāhuhu, and associated works.	Between Onehunga and Ōtāhuhu on the northern side of the Māngere Inlet
6775	The construction, operation and maintenance of the busway and ancillary works including approaches, ramp connections, ancillary safety and operational services (including communications), vegetation removal, stormwater treatment, temporary construction works including storage areas and office facilities, maintenance and access areas, mitigation and restoration, ancillary structures and activities associated with these works.	State Highway 1 – Northern Busway Extension. Adjacent to the east of State Highway 1 from Constellation Bus Station and connection across State Highway 1 to the Albany Bus Station

6776	Shared Use Path – for the construction, operation and maintenance of the Shared Use Path and ancillary works including approaches, ramp connections, ancillary safety and operational services (including communications), vegetation removal, stormwater treatment, temporary construction works including storage areas and office facilities, maintenance and access areas, mitigation and restoration, ancillary structures and activities associated with these works.	State Highway 1 and State Highway 18 Shared Use Path. Adjacent to the east of State Highway 1 from Constellation Bus Station to Oteha Road, adjacent to the north of State Highway 18 from Constellation Drive to Albany Highway, and intermediate linkages to the local network
6777	Weiti Crossing	East Coast Road, Redvale (crossing Weiti River) to corner Whangaparaoa Road and Cedar Road, Whangaparaoa
6778	Designation for the construction, operation and maintenance of a shared path and associated infrastructure.	State Highway 1 from north of Takanini Interchange to south of Quarry Road, Drury; from north of the Papakura Interchange through to Otūwairoa (Slippery Creek) Bridge; from north of Bremner Road to the Drury Interchange.
6779	Construction, operation and maintenance of a new state highway and associated activities between Warkworth and north of Te Hana	Between Warkworth and Te Hana
6781	To construct, operate, maintain, and improve a vehicle safety centre as part of the operation of the state highway network.	253 Mill Road, Bombay

## 6781 Bombay Commercial Vehicle Centre

Designation Number	6781
Requiring Authority	New Zealand Transport Authority
Location	253 Mill Road, Bombay
Lapse Date	10 years from the date on which it is included in the Auckland Unitary Plan (Operative in Part)

## Purpose

To construct, operate, maintain, and improve a vehicle safety centre as part of the operation of the state highway network.

## Conditions

### General Conditions

1. a) Except as provided for in the conditions below, works within the designation shall be undertaken in general accordance with the following plans and information submitted with the Notice of Requirement:
  - i. Notice of Requirement for a Designation of Land dated 24 October 2023, and updated 16 July 2024;
  - ii. Section 2 Description of Proposed Work in the Assessment of Effects on the Environment updated 24 January 2024;
  - iii. General Arrangement Plans, Architectural Design Plans, Landscape General Arrangement Plans, and Landscape Planting Plans included in Document and Drawing Schedule in memo dated 22 April 2024.
- b) Where there is inconsistency between the documents listed in clause (a) above and the requirements of the following conditions, the conditions shall prevail.

### Pre-construction

2. Prior to the start of construction, appropriate provision shall be made for a cultural induction of the contractor's staff. The New Zealand Transport Agency (NZTA) Southern Iwi Integration Group or its nominated representative(s) shall be invited to participate.

### Construction noise and vibration

3. a) A Construction Noise and Vibration Management Plan (CNVMP) shall be prepared prior to the start of construction.
  - b) The purpose of the CNVMP is to provide a framework for the development and implementation of the Best Practicable Option for the minimisation of noise and vibration effects from construction.

- c) The CNVMP shall include details in accordance with Annex E2 of NZS 6803 and the NZTA State Highway Construction and Maintenance Noise and Vibration Guide (version 1.1, 2019) or any subsequent updated version.

#### **Construction traffic management**

4. a) A Construction Traffic Management Plan (CTMP) shall be prepared prior to the start of construction.
- b) The purpose of the CTMP is to avoid, remedy or mitigate, as far as practicable, adverse construction traffic effects. To achieve this purpose, the CTMP shall include:
- i. Methods to manage the effects of temporary traffic management activities on traffic capacity and movements;
  - ii. Measures to manage the safety of all transport users;
  - iii. Estimated numbers, frequencies, routes, and timing of traffic movements;
  - iv. Methods to communicate traffic management measures to affected road users.
- c) The CTMP shall be prepared:
- i. Methods to manage the effects of temporary traffic management activities on traffic capacity and movements;
  - ii. In consultation with Auckland Transport.

#### **Advice Note:**

Any temporary or permanent work in Great South Road will require separate approvals from Auckland Transport as the road controlling authority. These approvals are:

- Corridor Access Request and accompanying Traffic Management Plan (for temporary construction activities which affect the local road)
- Engineering Plan Approval (for permanent work in the road corridor e.g. stormwater assets, lighting, or pavement); and
- Asset Owner Approval (for any changes to traffic or parking controls).

#### **Accidental discovery protocol**

5. a) An Accidental Discovery Protocol (ADP) shall be prepared prior to the start of construction. The purpose of the ADP is to set out the procedures to be followed if there are accidental archaeological discoveries which occur during construction.
- b) The ADP shall be:
- i. Consistent with the NZTA Minimum Standard P45 – Accidental Archaeological Discovery Specification (August 2018) or any subsequent updated version; and
  - ii. Prepared in consultation with iwi.

## **Design**

6. Buildings and structures shall use recessive, low reflective colours and material finishes to minimise their visibility in the landscape.

## **Lapse**

7. In accordance with Section 184(1)(c) of the Resource Management Act 1991, this designation shall lapse if not given effect to within 10 years from the date on which it is included in the Auckland Unitary Plan (Operative in Part).

## **Attachments**

No attachments.





## **Attachment 4: Updated GIS Viewer for new Designation**

**BEFORE**

1998

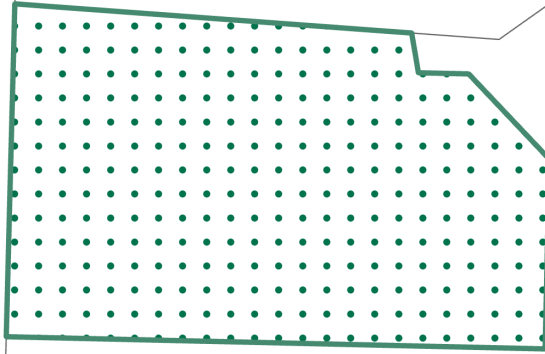
Great South Road



 Eastern Busway - EBC3

253

Mill Road

**AFTER**

1998

Great South Road

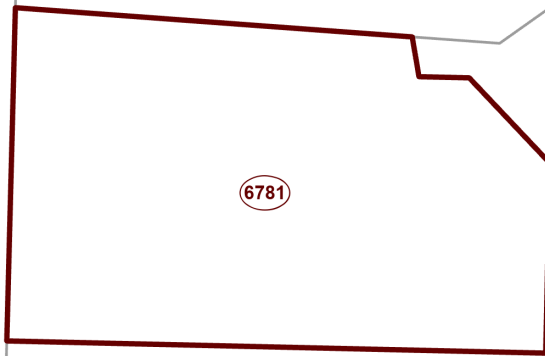

6781

 Designation 6781

253

Mill Road

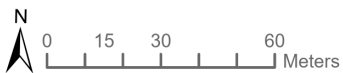

Whilst due care has been taken, Auckland Council gives no warranty as to the accuracy and completeness of any information on this map/plan and accepts no liability for any error, omission or use of the information.

Date: 12/12/2024

# Designation: 6781 Bombay Commercial Vehicle Centre



Plans and Places