

Memo

Date 10 December 2024

To: Celia Davison, Central South Planning Manager
 From: Ewen Patience – Policy Planner

Subject: Plan Modification: Clause 20A modification to Auckland Unitary Plan – Correction to Schedule 10, D13 Notable Trees Overlay, AUP
149 Centreway Road, Orewa – ID #2310 (subdivision)

Corrections are required to the Auckland Unitary Plan (operative in Part) 2016 (the AUP).

I seek your approval of this plan modification pursuant to clause 20A, First Schedule, Resource Management Act 1991 and Chapter D13 Notable Trees Overlay of the AUP(OP).

You have delegated authority, as a tier four manager, to make a decision to correct a minor error to an operative plan under clause 20A. Schedule 2A of the Auckland Council Chief Executive’s Delegations Register authorises all powers, functions, and duties under RMA’s first schedule (except clause 17 which cannot be delegated) to tier four positions.





D13.4 Activity table of the AUP enables the automatic update of Schedule 10 Notable Trees Schedule under the following circumstances:

- a) Subdivision altering legal description of one or more trees
- b) Resource consent authorising the removal of one or more trees and the tree has been physically removed
- c) Resource consent for, or authorisation of, removal of tree as a result of emergency works (storm damage/disease/other).

In this case the modification relates to: Subdivision (BUN60389427) which alters the address and legal description of tree #2310, as set out below:

| | | | | | | | |
|--|---|-----------------------------|------------|---|--------------------|-------|-----------------|
| Rule or Section of Unitary Plan | Schedule 10 Notable Trees Schedule – Tree #2310 | | | | | | |
| | 2310 | <i>Cupressus macrocarpa</i> | Macrocarpa | 1 | Centreway Road 149 | Orewa | Lot 39 DP 38916 |
| Subject Site | 149 Centreway Road, Orewa | | | | | | |
| Current Legal Description | As above | | | | | | |
| Nature of change | A clause 20A modification is required in accordance with D13.4 to ‘automatically’ update Schedule 10 of the AUP for the following reason: As advised by the GIS team (Danica Torres, 29.10.2024) following the regular updating of the cadastral mapping data received from LINZ, a subdivision of the property has occurred. This necessitates updating/correcting the notable tree listing in Schedule 10 as set out below. | | | | | | |
| Effect of change | The effects of the modifications are neutral as they are authorised by the provisions of D13.4 AUP and arise from subdivision. The landowner/s will be advised of the AUP modification once approved (and as | | | | | | |

| | soon as the new owner/address is in the Council system). | | | | | | | | | | | | | | |
|--|--|-------------|-----------------|---|-----------------|---|----------|-------------------|------|-----------------------------|------------|---|---|-------|---|
| Changes required to be made (text/in-text diagrams) | <p>Amend Schedule 10 Notable Tree Schedule of the AUP so that it reads as follows:</p> <table border="1" style="width: 100%; border-collapse: collapse;"> <thead> <tr> <th style="text-align: center;">ID</th> <th style="text-align: center;">Botanical Name</th> <th style="text-align: center;">Common Name</th> <th style="text-align: center;">Number of Trees</th> <th style="text-align: center;">Location/Street Address</th> <th style="text-align: center;">Locality</th> <th style="text-align: center;">Legal Description</th> </tr> </thead> <tbody> <tr> <td style="text-align: center;">2310</td> <td style="text-align: center;"><i>Cupressus macrocarpa</i></td> <td style="text-align: center;">Macrocarpa</td> <td style="text-align: center;">1</td> <td style="text-align: center;">Shared portion of 149A Centreway Road 449</td> <td style="text-align: center;">Orewa</td> <td style="text-align: center;">Lot 39 DP 38946 Lot 7 DP 603190</td> </tr> </tbody> </table> | ID | Botanical Name | Common Name | Number of Trees | Location/Street Address | Locality | Legal Description | 2310 | <i>Cupressus macrocarpa</i> | Macrocarpa | 1 | Shared portion of 149A Centreway Road 449 | Orewa | Lot 39 DP 38946 Lot 7 DP 603190 |
| ID | Botanical Name | Common Name | Number of Trees | Location/Street Address | Locality | Legal Description | | | | | | | | | |
| 2310 | <i>Cupressus macrocarpa</i> | Macrocarpa | 1 | Shared portion of 149A Centreway Road 449 | Orewa | Lot 39 DP 38946 Lot 7 DP 603190 | | | | | | | | | |
| Changes required to be made (to maps) | No change is required to the tree triangle. | | | | | | | | | | | | | | |
| Attachments | <p>Any further relevant information/evidence to help the decision maker (if necessary):</p> <ul style="list-style-type: none"> - Attachment 1: Information from GIS team as advised by email from Danica Torres, Senior Geospatial Specialist, on 29 October 2024. - Attachment 2: AUP map showing listing #2310. - Attachment 3: Consent plan showing notable tree in common area at front of development - Attachment 4: Schedule 10 listing showing revised texts. | | | | | | | | | | | | | | |

| | |
|---|--|
| Prepared by: Ewen Patience, Policy Planner | Signature:  |
| Text prepared by: Sarah El Karamany, Planning Technician | Signature:  |
| Data or map/s prepared by: NA | Signature: |
| Reviewed by: Clare Wall Shaw, Team Leader | Signature:  |
| Decision: I agree to authorise the Clause 20A modification using my delegated authority | Signature:  |

| | |
|---|--|
| <p>Celia Davison Central South Planning Manager Date: 13 January 2025</p> | |
|---|--|

Attachment 1: Information from GIS team as advised by email from Danica Torres on 29 October, 2024

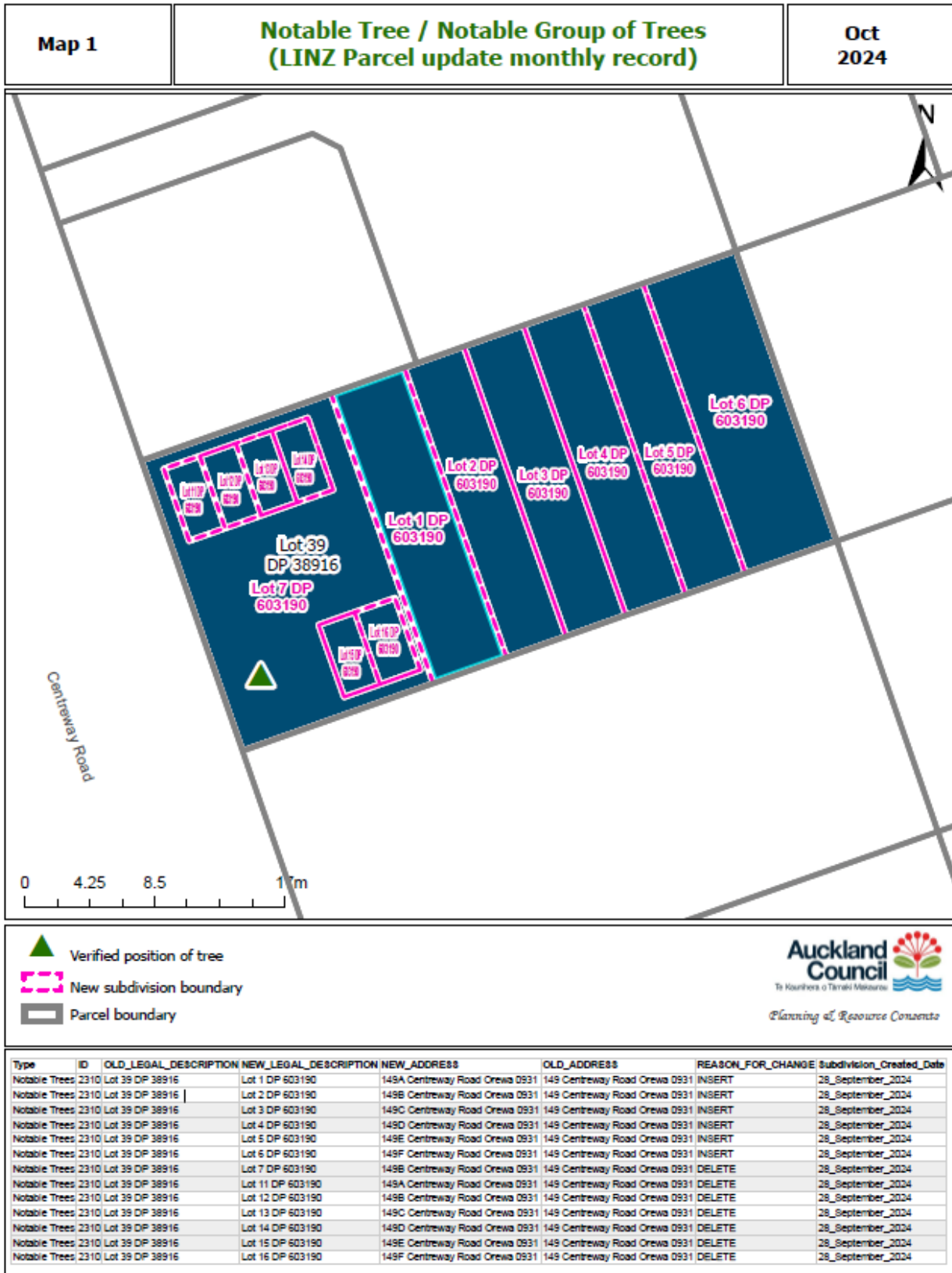

Attachment 2: AUP map showing listing #2310

Property Summary

This summary lists searched address, legal description, Zone and other limitations that apply to the site.

Address

149 Centreway Road Orewa 0931

Legal Description

Lot 39 DP 38916

Appeals

Modification

Plan Changes, Plan Change 78 - Intensification, Multiple Layers, [View PDF](#), Proposed, 18/08/2022

Zone

Residential - Mixed Housing Urban Zone

Precinct

Overlays

Natural Heritage: Notable Trees Overlay - 2310, Macrocarpa, Verified position of tree



Attachment 3: Consent plan showing notable tree in common area at front of development.

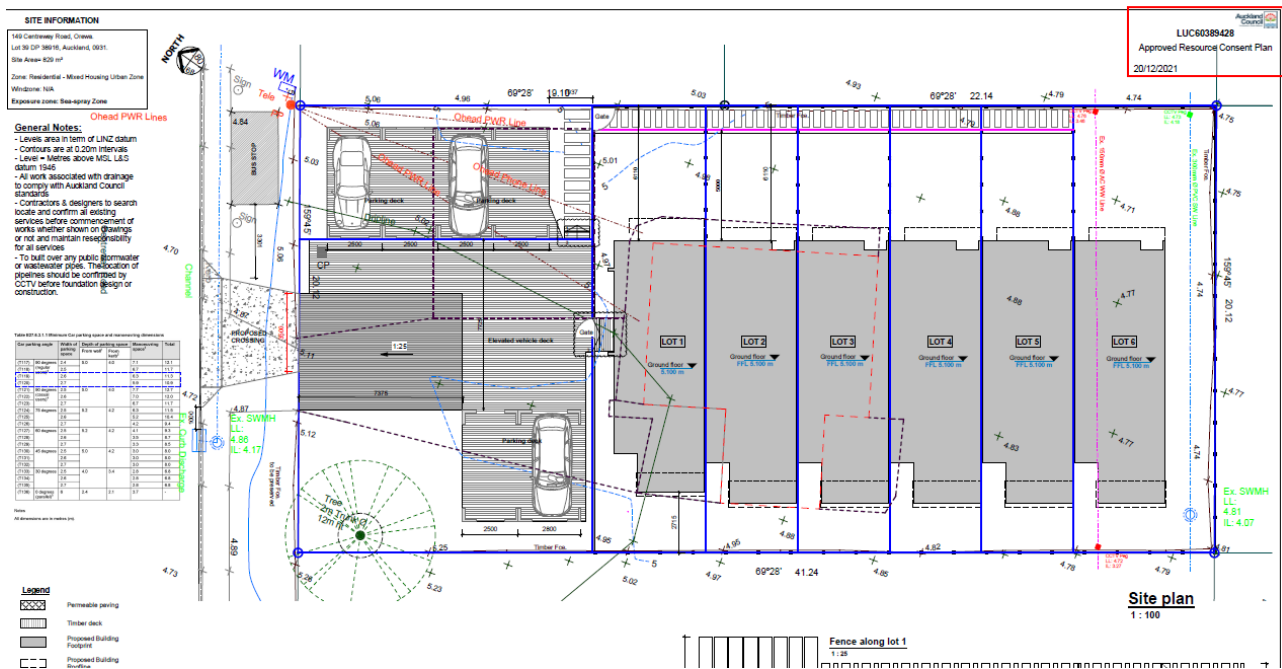

Attachment 4: Schedule 10 listing showing revised text

| vvaivera | | | | | | |
|----------|-----------------------------|------------|---|---------------------------------------|-------|-----------------|
| 2515 | <i>Podocarpus totara</i> | Totara | 1 | Centreway Road 79 | Orewa | Lot 69 DP 18948 |
| 2310 | <i>Cupressus macrocarpa</i> | Macrocarpa | 1 | Shared portion of 149A Centreway Road | Orewa | Lot 7 DP 603190 |
| 2498 | <i>Metrosideros excelsa</i> | Pōhutukawa | 1 | Centreway Road 164 | Orewa | Lot 1 DP 49013 |