

Memo

Date 11 December 2024

To: Celia Davison, Central South Planning Manager
 From: Ewen Patience – Policy Planner

Subject: Plan Modification: Clause 20A modification to Auckland Unitary Plan – Correction to Schedule 10, D13 Notable Trees Overlay, AUP
113 New Windsor Road – ID #357 (subdivision)

Corrections are required to the Auckland Unitary Plan (operative in Part) 2016 (the AUP).

I seek your approval of this plan modification pursuant to clause 20A, First Schedule, Resource Management Act 1991 and Chapter D13 Notable Trees Overlay of the AUP(OP).

You have delegated authority, as a tier four manager, to make a decision to correct a minor error to an operative plan under clause 20A. Schedule 2A of the Auckland Council Chief Executive’s Delegations Register authorises all powers, functions, and duties under RMA’s first schedule (except clause 17 which cannot be delegated) to tier four positions.





D13.4 Activity table of the AUP enables the automatic update of Schedule 10 Notable Trees Schedule under the following circumstances:

- a) Subdivision altering legal description of one or more trees
- b) Resource consent authorising the removal of one or more trees and the tree has been physically removed
- c) Resource consent for, or authorisation of, removal of tree as a result of emergency works (storm damage/disease/other).

In this case the modification relates to: Subdivision (BUN60389427) which alters the address and legal description of tree #2310, as set out below:

Rule or Section of Unitary Plan	Schedule 10 Notable Trees Schedule – Tree #357						
	357	<i>Metrosideros robusta</i>	Northern Rata	1	New Windsor Road 113	New Windsor	Lot 3 DP 19513
Subject Site	113 New Windsor Road, New Windsor						
Current Legal Description	As above						
Nature of change	A clause 20A modification is required in accordance with D13.4 to ‘automatically’ update Schedule 10 of the AUP for the following reason: As advised by the GIS team (Dean Thompson, 28.11.2024) following the regular updating of the cadastral mapping data received from LINZ, a subdivision of the property has occurred. This necessitates updating/correcting the notable tree listing in Schedule 10 as set out below.						
Effect of change	The effects of the modifications are neutral as they are authorised by the provisions of D13.4 AUP and arise from subdivision.						

	The landowner/s will be advised of the AUP modification once approved (and as soon as the new owner/address is in the Council system).														
Changes required to be made (text/in-text diagrams)	<p>Amend Schedule 10 Notable Tree Schedule of the AUP so that it reads as follows:</p> <table border="1" style="width: 100%; border-collapse: collapse;"> <thead> <tr> <th style="text-align: center;">ID</th> <th style="text-align: center;">Botanical Name</th> <th style="text-align: center;">Common Name</th> <th style="text-align: center;">Number of Trees</th> <th style="text-align: center;">Location/Street Address</th> <th style="text-align: center;">Locality</th> <th style="text-align: center;">Legal Description</th> </tr> </thead> <tbody> <tr> <td style="text-align: center;">357</td> <td style="text-align: center;"><i>Metrosideros robusta</i></td> <td style="text-align: center;">Northern Rata</td> <td style="text-align: center;">1</td> <td style="text-align: center;">New Windsor Road 443-113A</td> <td style="text-align: center;">New Windsor</td> <td style="text-align: center;">Lot 3 DP 19513 Lot 1 DP 598495</td> </tr> </tbody> </table>	ID	Botanical Name	Common Name	Number of Trees	Location/Street Address	Locality	Legal Description	357	<i>Metrosideros robusta</i>	Northern Rata	1	New Windsor Road 443 -113A	New Windsor	Lot 3 DP 19513 Lot 1 DP 598495
ID	Botanical Name	Common Name	Number of Trees	Location/Street Address	Locality	Legal Description									
357	<i>Metrosideros robusta</i>	Northern Rata	1	New Windsor Road 443 -113A	New Windsor	Lot 3 DP 19513 Lot 1 DP 598495									
Changes required to be made (to maps)															
Attachments	<p>Any further relevant information/evidence to help the decision maker (if necessary):</p> <ul style="list-style-type: none"> - Attachment 1: Information from GIS team as advised by email from Dean Thompson, Team Leader Geospatial, on 28 November 2024. - Attachment 2: AUP map showing listing #357 - Attachment 3: Consent plan showing notable tree at front of development - Attachment 4: Schedule 10 listing showing revised texts. 														

Prepared by: Ewen Patience, Policy Planner	Signature: 
Text prepared by: Sarah El Karamany, Planning Technician	Signature: 
Data or map/s prepared by: Dean Thompson, Team Leader Geospatial	Signature: 
Reviewed by: Clare Wall Shaw, Team Leader	Signature: 
Decision: I agree to authorise the Clause 20A modification using my delegated authority	Signature:

Celia Davison
Central South Planning Manager
Date: 30 January 2025



Attachment 1: Information from GIS team as advised by email from Dean Thompson on 28 November, 2024

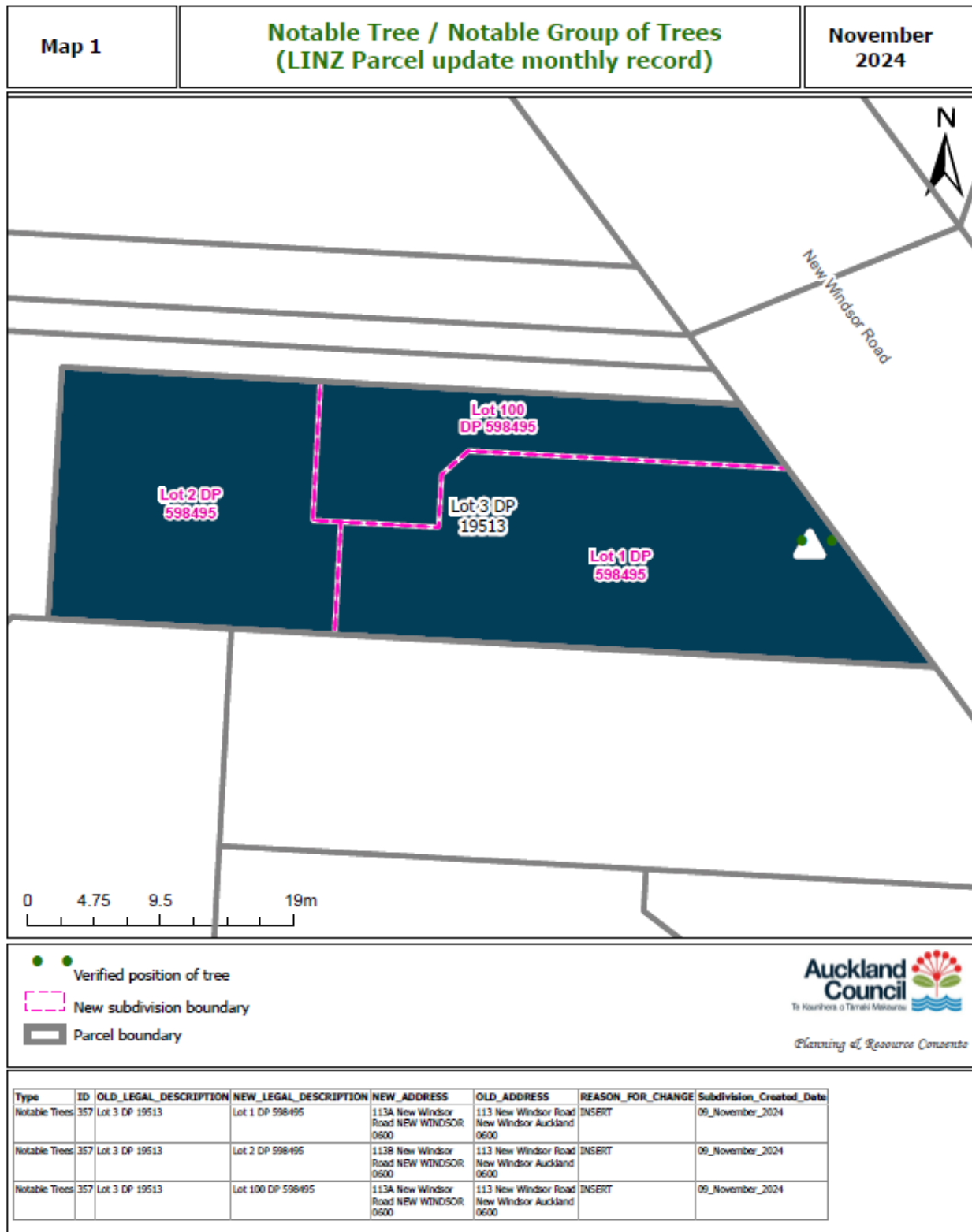

Attachment 2: AUP map showing listing #357 at 113/113A New Windsor Road.

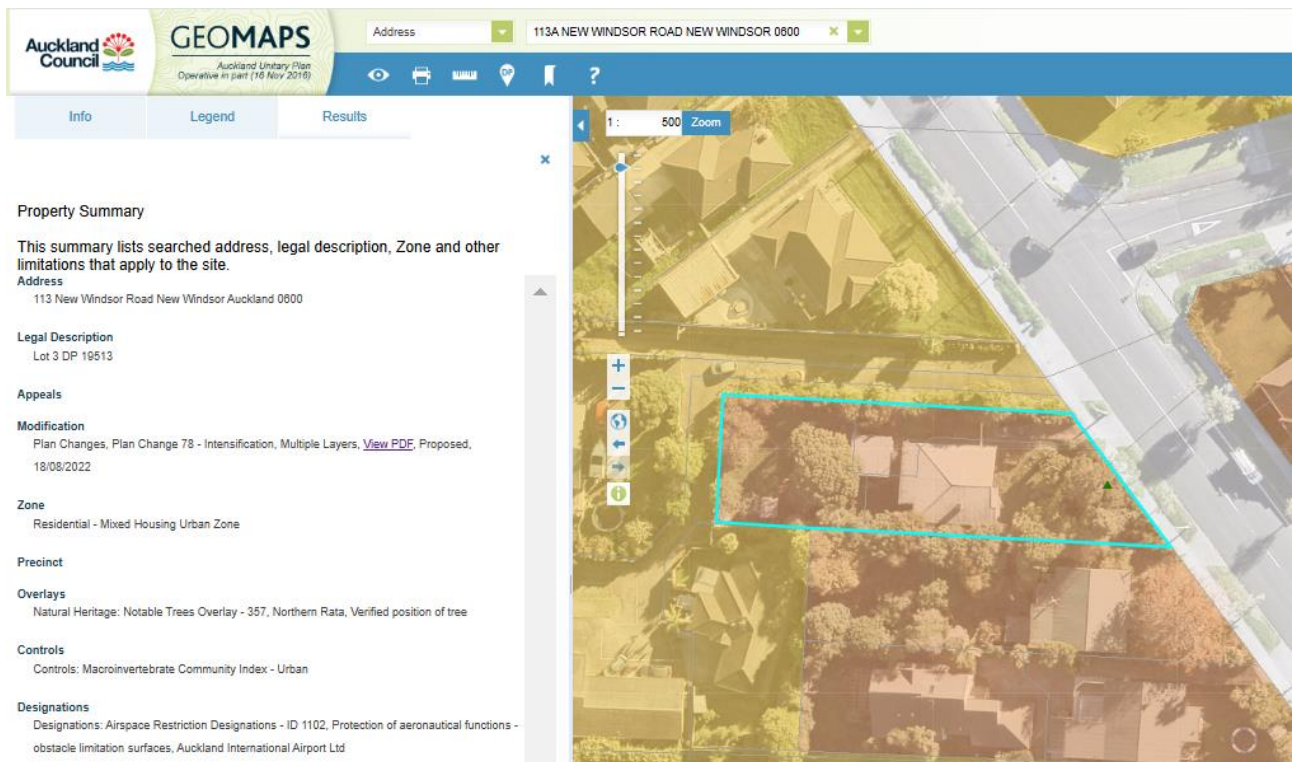

The screenshot displays the Auckland Council Geomaps interface. The address bar shows "113A NEW WINDSOR ROAD NEW WINDSOR 0800". The map shows an aerial view of a residential area with a specific property highlighted in a red rectangle. The sidebar on the left contains the following information:

- Property Summary**
This summary lists searched address, legal description, Zone and other limitations that apply to the site.
- Address**
113 New Windsor Road New Windsor Auckland 0800
- Legal Description**
Lot 3 DP 19513
- Appeals**
- Modification**
Plan Changes, Plan Change 78 - Intensification, Multiple Layers, [View PDF](#), Proposed, 18/08/2022
- Zone**
Residential - Mixed Housing Urban Zone
- Precinct**
- Overlays**
Natural Heritage: Notable Trees Overlay - 357, Northern Rata, Verified position of tree
- Controls**
Controls: Macroinvertebrate Community Index - Urban
- Designations**
Designations: Airspace Restriction Designations - ID 1102, Protection of aeronautical functions - obstacle limitation surfaces, Auckland International Airport Ltd

Attachment 3: Consent plan showing (removed) notable tree at front of development.

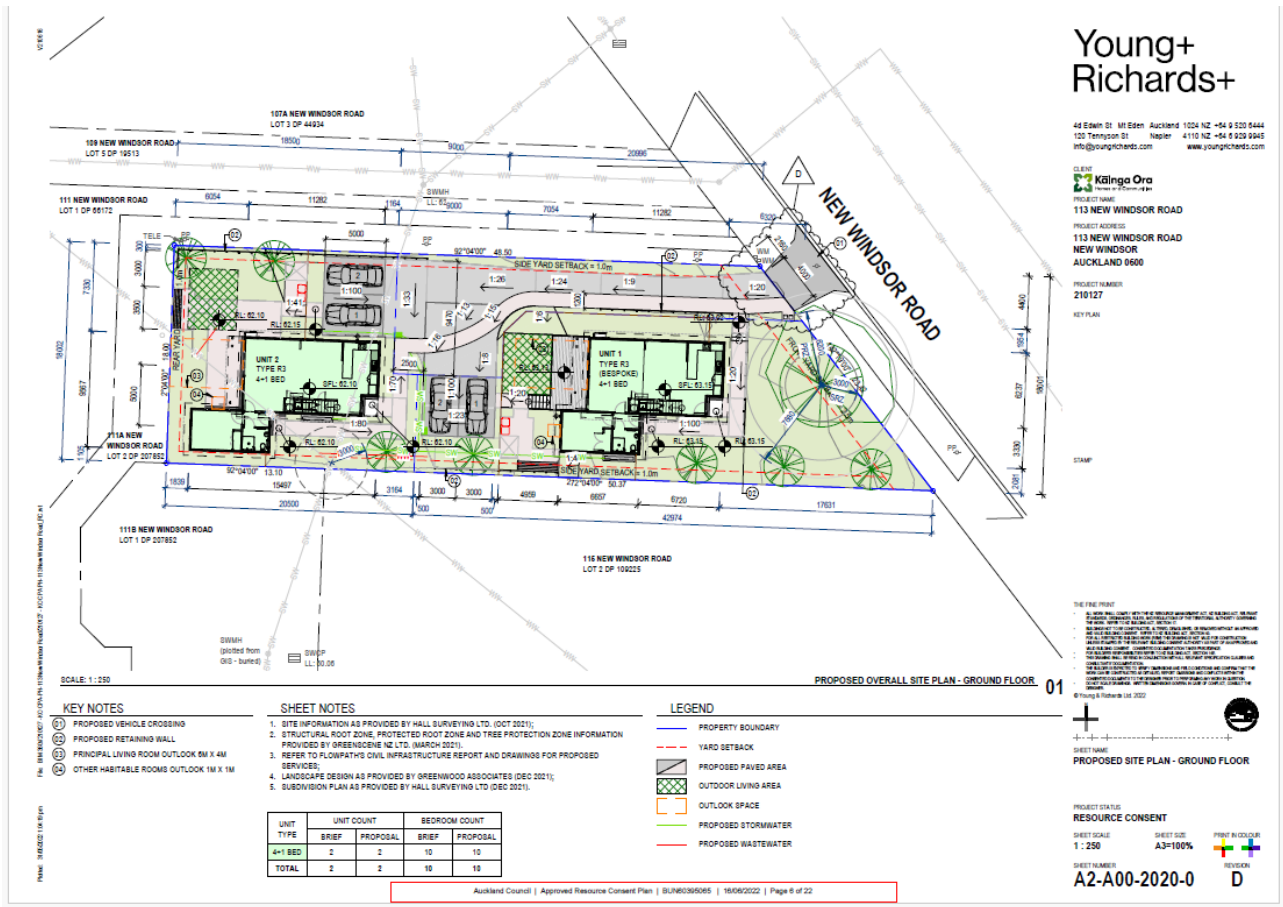

Attachment 4: Schedule 10 listing showing revised text

75	<i>Phoenix canariensis</i>	Phoenix Palm	3	New Street 3-9	Ponsonby	Pt Allotment 14 SECT 8 SBRS OF Auckland
357	<i>Metrosideros robusta</i>	Northern Rata	1	New Windsor Road 113A	New Windsor	Lot 1 DP 598495
799	<i>Metrosideros excelsa</i>	Pōhutukawa	1	Newton Road 122	Newton	Lot 2 DP 196272
698	<i>Metrosideros excelsa</i>	Pōhutukawa	1	Ngaio Street 9	Orakei	Lot 77 DP 38388