





TO Warren MacLennan – Manager Regional, North, West and Islands Planning
FROM Sarah Wong – Policy planner, Planning Regional, North/West and Islands
DATE 1 August 2024
SUBJECT **Update requested to the Auckland Unitary Plan (Operative in Part 2016) (AUP)**

I request an update to the AUP as outlined below:

Reason for update	Section 182 - Removal of designations 6762 & 6764
Chapter(s)	Chapter K Designations – New Zealand Transport Agency New Zealand Transport Agency – Schedule AUP GIS viewer
Designation only	
Designation #	New Zealand Transport Agency Waka Kotahi (NZTA), Designations 6762 and 6764: <ul style="list-style-type: none"> • 6762 Quarry - State Highway 1, Pohuehue • 6764 State Highway 1 Road Widening - Hudson Road, Warkworth
Locations:	<u>6762:</u> <ul style="list-style-type: none"> • Allot 273 SO 39591, State Highway 1 Pohuehue 0983 <u>6764:</u> <ul style="list-style-type: none"> • 80 Great North Road, Warkworth • 3, 4, 5, 6, 7, 8, 9, 10, 11, 12, 13, 14, 15 Wikitoria Lane, Warkworth • 56 & 58 Victoria Street, Warkworth, • 99 & 99A Great North Road, Warkworth, • 2 State Highway 1, Warkworth • 12 Hudson Road, Warkworth
Lapse Date	Given effect to (i.e. no lapse date) (both designations)
Purpose	<u>6762:</u> <ul style="list-style-type: none"> • Quarry. <u>6764:</u> <ul style="list-style-type: none"> • Road widening.
Changes to text (shown in underline and strikethrough)	Removal of Designations 6762 and 6764 from Chapter K and the Schedules. See text changes in Attachment 3 & 4.
Changes to diagrams	n/a – no diagrams (both designations)

Changes to spatial data	Removal of Designations 6762 and 6764 from AUP GIS viewer. See Attachment 5.
Attachments	Attachment 1: Section 182 report (Designation 6762) Attachment 2: Section 182 report (Designation 6764) Attachment 3: Removal of designation text and updated NZTA Schedule (Strikethrough/Underscore) Attachment 4: NZTA Schedule (Clean) Attachment 5: Designation 6762 & 6764 GIS viewer map (to be removed).

Maps prepared by: Rache Joseph Geospatial Specialist	Text Entered by: Sophia Coulter Planning Technician
Signature: 	Signature: 
prepared by: Sarah Wong Planner	Reviewed by: Ryan Bradley Acting Team Leader
Signature: 	Signature: 
Authorised by: Warren MacLennan Manager Planning – Regional North/West and Islands	
Signature: 	

Attachment 1: Section 182 report
(Designation 6762)

23 July 2024

Miriam Williams, Aurecon
Miriam.Williams@aurecongroup.com

Section 182 Removal of Designation 6762 – Quarry - State Highway 1, Pohuehue

New Zealand Transport Agency Waka Kotahi (NZTA) requested the uplift of this designation in a letter to the council dated 3 July 2024.

In response to NZTA's request, the full removal of Designation 6762 – Quarry - State Highway 1, Pohuehue from the Auckland Unitary Plan takes effect on 23 June 2024.

The amendment will be included in the next update of the Auckland Unitary Plan.

A copy of the designation uplift report is attached.

Ngā mihi,



Sarah Wong
Policy Planner
Regional, North West and Islands Unit
Planning and Resource Consents

Removal of a designation under section 182 of the Resource Management Act 1991



To: Peter Vari – Team Leader, Planning Regional, North/West and Islands
From: Sarah Wong – Policy Planner, Regional, North/West and Islands
Date: 23 July 2024
Subject: Removal of Designation 6762 – Quarry - State Highway 1, Pohuehue, in the Auckland Unitary Plan

Summary

Auckland Council has received a request from New Zealand Transport Agency Waka Kotahi (NZTA) under section 182 of the Resource Management Act 1991 (RMA), dated 3 July 2024, to remove in full Designation 6762 – Quarry - State Highway 1, Pohuehue.

A section 182(1) request is required to uplift the existing designation in full from land which has been deemed surplus by NZTA.

Auckland Council, as the territorial authority, is required to amend its district plan, without using the process in Schedule 1, as soon as reasonably practicable after receiving a Section 182 request unless it considers that the effect of the removal of the designation is more than minor.

It is recommended that the designation removal be **accepted**.

Recommendation

1. That the section 182 request from NZTA for the removal of Designation 6762 – Quarry - State Highway 1, Pohuehue in the Auckland Unitary Plan be **accepted** for the following reasons:
 - i) NZTA no longer require the designation on the land; and
 - ii) The effects of the removal of the designation are less than minor.
2. That Designation 6762 – Quarry - State Highway 1, Pohuehue be removed in full from the areas of land on Allot 273 SO 39591, State Highway 1 Pohuehue 0983, as soon as reasonably practicable, in the Designation overlay and Chapter K Designations where the text needs to be amended in the Auckland Unitary Plan.

1. Description

1.1. References

Designation number:	Designation 6762 – Quarry - State Highway 1, Pohuehue
Lodgement date:	23 July 2024
Requiring authority:	New Zealand Transport Agency Waka Kotahi (NZTA)
Reporting officer:	Sarah Wong
Site address:	Allot 273 SO 39591, State Highway 1 Pohuehue 0983
UP Zoning:	Open Space - Conservation Zone

2. Background

2.1. Details of designation

New Zealand Transport Agency Waka Kotahi (NZTA) has served a notice under section 182 of the Resource Management Act 1991, signed by Sonya McCall, Team Lead of Poutiaki Taiao / Environmental Planning (dated 3 July 2024), to remove the designation in full from the site identified in Attachment A to Attachment 1.

Designation 6762 in the Auckland Unitary Plan (AUP) is located adjacent and to the east of the Old State Highway 1 in Auckland, approximately 850m north of the intersection with Cowan Bay Road. The purpose of the designation is for a quarry.

The designation is proposed to be removed in full from land adjacent and to the east of the Old State Highway 1 in Auckland, approximately 850m north of the intersection with Cowan Bay Road. Due to the revocation of the state highway status of the Old State Highway 1 between Puhoi and Warkworth on 30 June 2024, this designation is no longer required for the on-going operation, maintenance or mitigation of effects of the work authorised by the designation.

2.2. Land affected by removal

Figure 1 shows Designation 6762 as shown on the AUP maps in red, with this designation proposed to be removed in full:

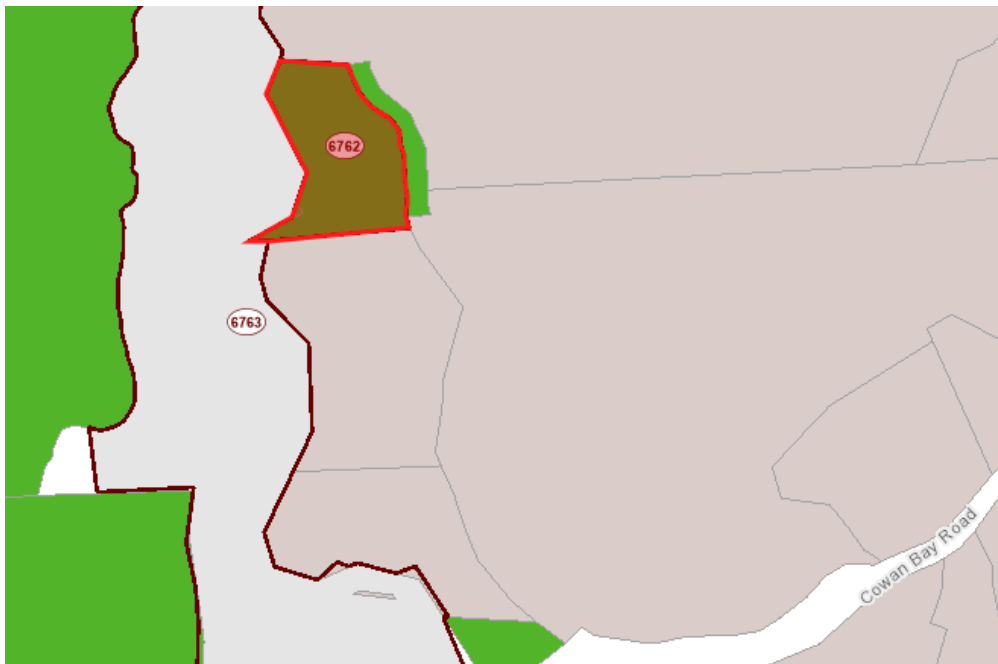

Figure 1: Location and extent of Designation 6762, as shown on the AUP maps.

NZTA has also provided a site plan showing the full extent of the designation proposed for removal in Attachment B of their Section 182 notice of removal (refer to **Attachment 1**).

2.3. Delegated authority to consider alterations to designations

The Team Leader – Regional, North/West and Islands (Planning and Resource Consents) has delegated authority, in accordance with Schedule 2A of the Auckland Council Delegations: Chief Executive Officer (updated July 2024), to exercise the Council’s functions, powers, duties and discretions under the Resource Management Act 1991 in relation to Section 182 to approve a removal of a designation.

The section 182 request to remove the designation can therefore be considered by the Team Leader – Regional, North/West and Islands (Planning and Resource Consents) and accepted or declined.

2.4. Relevant Statutory Provisions

Section 182 of the RMA allows a requiring authority to remove a designation or part of a designation if it no longer wants it. This section also applies to a notice by a territorial authority, to withdraw its own designation or part of a designation within its own district.

Section 182(2) states that as soon as reasonably practicable the territorial authority shall, without using the process in Schedule 1, amend its district plan accordingly. If the territorial authority considers that the effect of the removal of part of a designation on the remaining designation is more than minor, it may, within 20 working days of receipt of a section 182 notice, decline to remove that part of the designation.

It is considered that NZTA has provided sufficient justification for the removal of Designation 6762 – Quarry - State Highway 1, Pohuehue for the following reasons:

- The removal of the identified areas does not affect the use of the rest of the designation for its intended purpose.
- Due to the revocation of the state highway status of the Old State Highway 1 between Puhoi and Warkworth on 30 June 2024, this designation is no longer required for the on-going operation, maintenance or mitigation of effects of the work authorised by the designation.

3. Recommendation

That pursuant to Section 182 of the Resource Management Act 1991 that the removal of Designation 6762 – Quarry - State Highway 1, Pohuehue be **accepted** and the Auckland Unitary Plan Operative in part designation overlay and text in Chapter K Designations be amended accordingly.

Prepared by: Sarah Wong
Policy Planner
Planning Regional,
North/West and Islands

Accepted by: Peter Vari
Team Leader
Planning Regional,
North/West and Islands

Signature: 

Signature: 

Date: 23 July 2024

SCHEDULE OF ATTACHMENTS:

Attachment 1: New Zealand Transport Agency Waka Kotahi s182 Notice of Removal

**ATTACHMENT 1: NEW ZEALAND TRANSPORT AGENCY WAKA KOTAHI S182 NOTICE
OF REMOVAL**

3/07/2024

Sarah Wong
Plans & Places Department
Auckland Council
Private Bag 92300
Victoria Street West
Auckland 1142

Dear Sarah,

Removal of the NZ Transport Agency Waka Kotahi State Highway Designation ref 6762, State Highway 1 Quarry – State Highway 1, Pohuehue

Please find enclosed a notice of removal of a designation.

Pursuant to Section 182 of the Resource Management Act 1991, NZ Transport Agency Waka Kotahi (NZTA) has determined this designation is no longer required and requests the Auckland Unitary Plan (Operative in Part) be amended to reflect this.

For your information, NZTA has notified all persons considered to be affected by this removal, including any land owners or occupiers.

Please contact me if you have any questions or require further information.

Yours sincerely

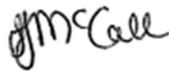

Sonya McCall
Team Lead Poutiaki Taiao / Environmental Planning
Systems Design
Phone: 021 197 1801
Email: consents@nzta.govt.nz (and copy to sonya.mccall@nzta.govt.nz and Miriam.Williams@aurecongroup.com)

Enc. NZ Transport Agency Waka Kotahi Form 23 – Notice of Removal of Designation under Section 182 of Resource Management Act 1991

REMOVAL OF DESIGNATION

July 2024
 NZ Transport Agency Waka Kotahi
 Designation 6762: Road Widening

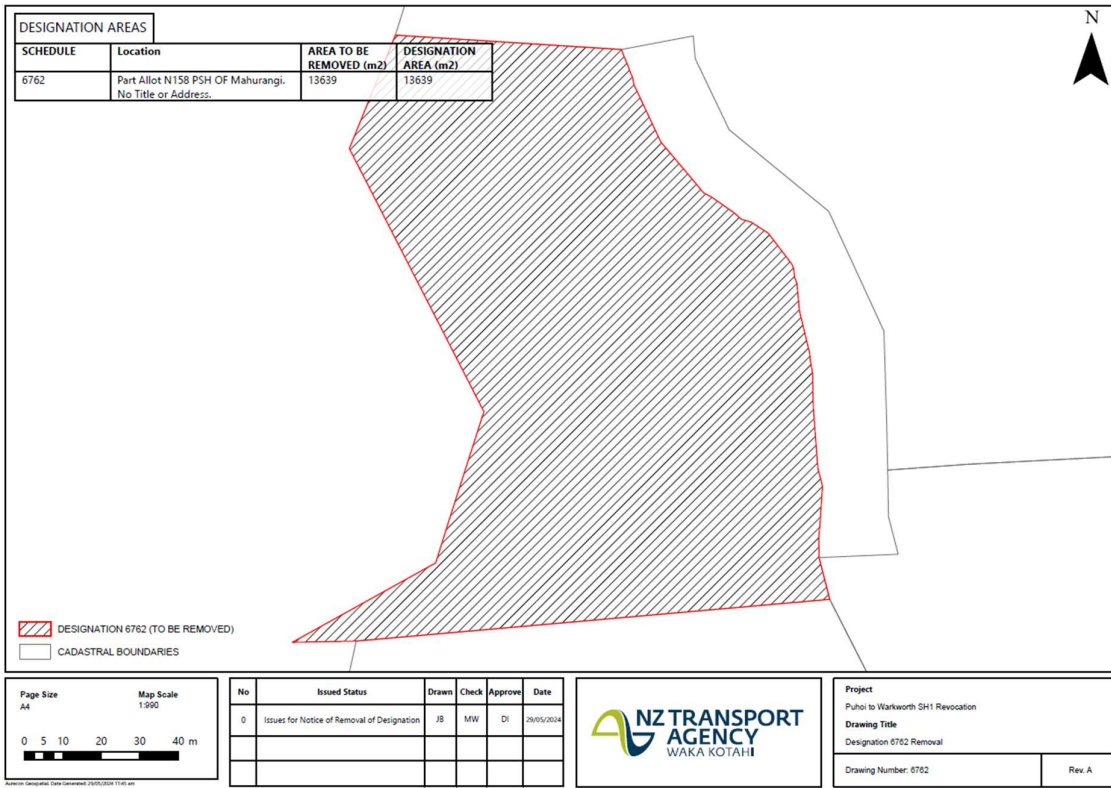

Form 23
Notice of Removal of Designation Under Section 182 of the Resource Management Act 1991

To: Auckland Council
PO Box 92300
Victoria Street West
Auckland 1142

From: NZ Transport Agency Waka Kotahi
PO Box 106602
Auckland 1143

And to: Auckland Transport
20 Viaduct Harbour Avenue
Auckland 1010

Pursuant to Section 182 of the Resource Management Act 1991 (RMA) NZ Transport Agency Waka Kotahi (NZTA) gives notice that it no longer requires all of designation 6762 included in the Auckland Unitary Plan.

The designation is located adjacent and to the east of the Old State Highway 1 in Auckland, approximately 850m north of the intersection with Cowan Bay Road.

The designation is listed in Chapter K Designations: New Zealand Transport Authority Schedule and shown in the Auckland Unitary Plan GIS viewer. The purpose of the designation is for a quarry.

The designation is no longer required on the land listed in Table 1 in Attachment A. The area of the designation to be removed is shown on the plan in Attachment B.

The designation to be removed is no longer required for the on-going operation, maintenance or mitigation of effects of the work authorised by the designation.

NZTA requests the Council amend the Auckland Unitary Plan accordingly as required by section 182 of the Resource Management Act 1991.

Signed by:

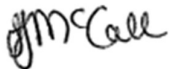

Sonya McCall
Team Lead, Poutiaki Taiao / Environmental Planning
Systems Design
Pursuant to authority delegated by NZ Transport Agency Waka Kotahi
3/07/2024

Address for Service:
Aurecon New Zealand Limited
PO Box 9762
Newmarket
Auckland 1149
Attention: Miriam Williams
Ph: (09) 520 7236
E-mail: Miriam.Williams@aurecongroup.com

Attachment A – Properties subject to removal of designation [or part of designation]

Attachment B – Plan of designation to be removed

Attachment A
Properties subject to removal of designation 6762

1. Land owners/occupiers

The designation is to be removed from the following land:

Legal Description	Certificate of Title	Address
Part Allot N158 PSH OF Mahurangi	N/A	N/A

2. Other persons likely to be affected

The following other persons are likely to be affected:

Name	Address	Reason Likely to be Affected
Auckland Transport	20 Viaduct Harbour Avenue Auckland 1010	The state highway status of the Old State Highway 1 between Puhoi and Warkworth will be revoked on 30 June 2024, with ownership passing to Auckland Transport.

Attachment B
Plan of designation to be removed – Designation 6762

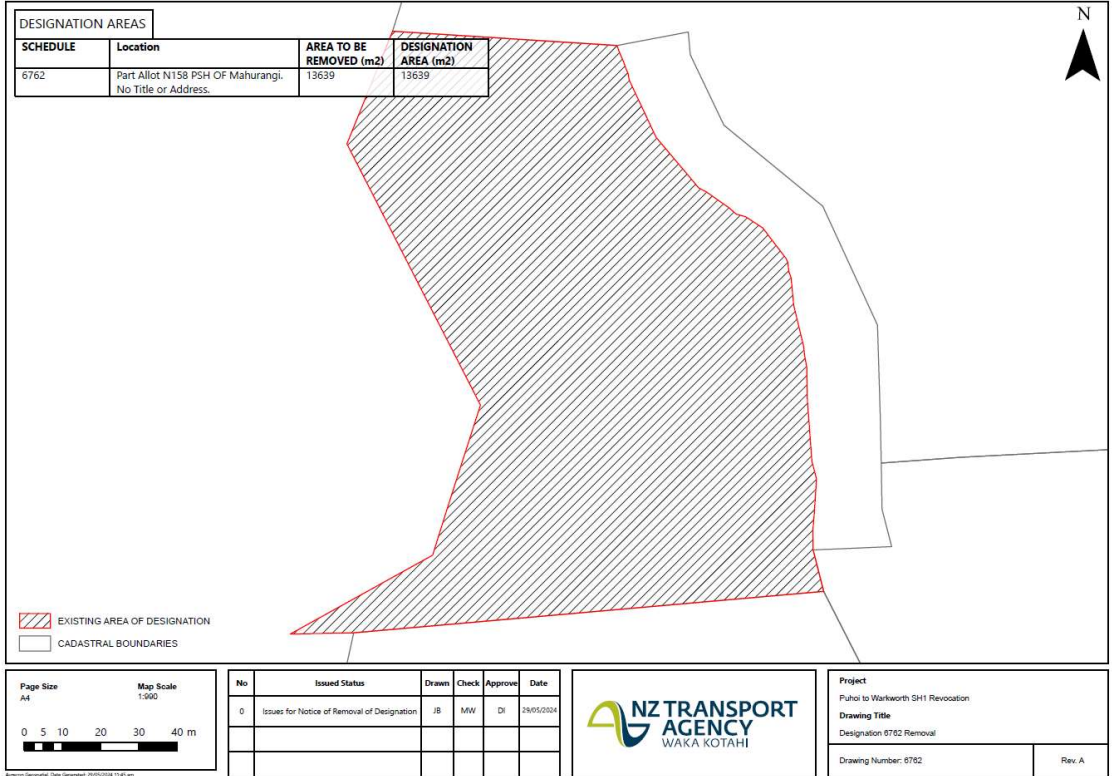

Attachment 2: Section 182 report
(Designation 6764)

23 July 2024

Miriam Williams, Aurecon
Miriam.Williams@aurecongroup.com

Section 182 Removal of Designation 6764 – State Highway 1 Road Widening - Hudson Road, Warkworth

New Zealand Transport Agency Waka Kotahi (NZTA) requested the uplift of this designation in a letter to the council dated 3 July 2024.

In response to NZTA's request, the full removal of Designation 6764 – State Highway 1 Road Widening - Hudson Road, Warkworth from the Auckland Unitary Plan takes effect on 23 June 2024.

The amendment will be included in the next update of the Auckland Unitary Plan.

A copy of the designation uplift report is attached.

Ngā mihi,



Sarah Wong
Policy Planner
Regional, North West and Islands Unit
Planning and Resource Consents

Removal of a designation under section 182 of the Resource Management Act 1991



To: Peter Vari – Team Leader, Planning Regional, North/West and Islands
From: Sarah Wong – Policy Planner, Regional, North/West and Islands
Date: 23 July 2024
Subject: Removal of Designation 6764 – State Highway 1 Road Widening - Hudson Road, Warkworth, in the Auckland Unitary Plan

Summary

Auckland Council has received a request from New Zealand Transport Agency Waka Kotahi (NZTA) under section 182 of the Resource Management Act 1991 (RMA), dated 3 July 2024, to remove in full Designation 6764 – State Highway 1 Road Widening - Hudson Road, Warkworth.

A section 182(1) request is required to uplift the existing designation in full from land which has been deemed surplus by NZTA.

Auckland Council, as the territorial authority, is required to amend its district plan, without using the process in Schedule 1, as soon as reasonably practicable after receiving a Section 182 request unless it considers that the effect of the removal of the designation is more than minor.

It is recommended that the designation removal be **accepted**.

Recommendation

1. That the section 182 request from NZTA for the removal of Designation 6764 – State Highway 1 Road Widening - Hudson Road, Warkworth in the Auckland Unitary Plan be **accepted** for the following reasons:
 - i) NZTA no longer require the designation on the land; and
 - ii) The effects of the removal of the designation are less than minor.
2. That Designation 6764 – State Highway 1 Road Widening - Hudson Road, Warkworth be removed from the areas of land identified in Attachment A of Attachment 1 as soon as reasonably practicable, in the Designation overlay and Chapter K Designations where the text needs to be amended in the Auckland Unitary Plan.

1. Description

1.1. References

Designation number:	Designation 6764 – State Highway 1 Road Widening - Hudson Road, Warkworth
Lodgement date:	23 July 2024
Requiring authority:	New Zealand Transport Agency Waka Kotahi (NZTA)
Reporting officer:	Sarah Wong
Site address:	Various: <ul style="list-style-type: none">- 80 Great North Road, Warkworth- 3, 4, 5, 6, 7, 8, 9, 10, 11, 12, 13, 14, 15 Wikitoria Lane, Warkworth- 56 Victoria Street, Warkworth, 58 Victoria Street, Warkworth, 99A Great North Road, Warkworth, 99 Great North Road, Warkworth- 2 State Highway 1, Warkworth- 12 Hudson Road, Warkworth
UP Zoning:	Various: <ul style="list-style-type: none">- Business - General Business Zone- Residential - Single House Zone- Open Space - Sport and Active Recreation Zone- Strategic Transport Corridor Zone

2. Background

2.1. Details of designation

New Zealand Transport Agency Waka Kotahi (NZTA) has served a notice under section 182 of the Resource Management Act 1991, signed by Sonya McCall, Team Lead of Poutiaki Taiao / Environmental Planning (dated 3 July 2024) for the removal of Designation 6764.

Designation 6764 – State Highway 1 Road Widening - Hudson Road, Warkworth in the Auckland Unitary Plan (AUP) is located where the Old State Highway 1 intersects with Hudson Road in Warkworth, Auckland. The purpose of the designation is for road widening.

The designation is proposed to be removed in full from the AUP from the sites identified in **Attachment 1**. The state highway status of the Old State Highway 1 between Puhoi and Warkworth was revoked on 30 June 2024, with ownership passing to Auckland Transport. As such, the areas where this designation applies are no longer required for the on-going operation, maintenance or mitigation of effects of the work authorised by the designation.

2.2. Land affected by removal

The extent of Designation 6764 as per the AUP maps is shown in red in Figure 1 below, with this designation proposed to be removed in full:

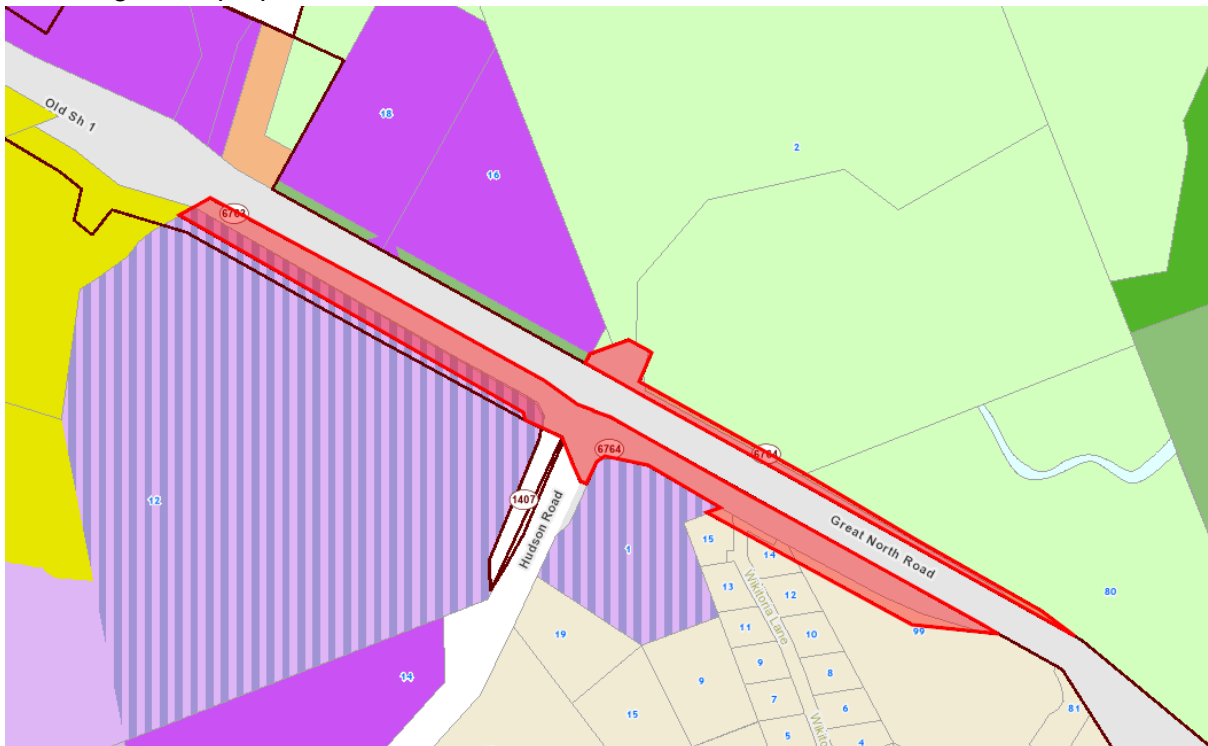

Figure 1: Location and extent of Designation 6764, as shown on the AUP maps.

NZTA has provided a site plan showing the full extent of the designation proposed for removal. This is included in **Attachment 2**.

2.3. Delegated authority to consider alterations to designations

The Team Leader – Regional, North/West and Islands (Planning and Resource Consents) has delegated authority, in accordance with Schedule 2A of the Auckland Council Delegations: Chief Executive Officer (updated July 2024), to exercise the Council's functions, powers, duties and discretions under the Resource Management Act 1991 in relation to Section 182 to approve a removal of a designation.

The section 182 request to remove the designation can therefore be considered by the Team Leader – Regional, North/West and Islands (Planning and Resource Consents) and accepted or declined.

2.4. Relevant Statutory Provisions

Section 182 of the RMA allows a requiring authority to remove a designation or part of a designation if it no longer wants it. This section also applies to a notice by a territorial authority, to withdraw its own designation or part of a designation within its own district.

Section 182(2) states that as soon as reasonably practicable the territorial authority shall, without using the process in Schedule 1, amend its district plan accordingly. If the territorial authority considers that the effect of the removal of part of a designation on the remaining designation is more than minor, it may, within 20 working days of receipt of a section 182 notice, decline to remove that part of the designation.

It is considered that NZTA has provided sufficient justification for the removal of Designation 6764 – State Highway 1 Road Widening - Hudson Road, Warkworth for the following reasons:

- The removal of the identified areas does not affect the use of the rest of the designation for its intended purpose.
- Due to the revocation of the state highway status of the Old State Highway 1 between Puhoi and Warkworth on 30 June 2024, the areas identified within the designation are no longer required for the on-going operation, maintenance or mitigation of effects of the work authorised by the designation.

3. Recommendation

That pursuant to Section 182 of the Resource Management Act 1991 that the removal of Designation 6764 – State Highway 1 Road Widening - Hudson Road, Warkworth be **accepted** and the Auckland Unitary Plan Operative in part designation overlay and text in Chapter K Designations be amended accordingly.

Prepared by: Sarah Wong
Policy Planner
Planning Regional,
North/West and Islands

Accepted by: Peter Vari
Team Leader
Planning Regional,
North/West and Islands

Signature: 

Signature: 

Date: 23 July 2024

SCHEDULE OF ATTACHMENTS:

Attachment 1: Properties subject to removal of designation 6763
Attachment 2: Extent of Designation 6764 and parts of the designation to be removed
Attachment 3: New Zealand Transport Agency Waka Kotahi s182 Notice of Removal

ATTACHMENT 1: PROPERTIES SUBJECT TO REMOVAL OF DESIGNATION 6764

Legal Description	Certificate of Title	Address
Lot 29 Deposited Plan 531363, Lot 18 Deposited Plan 531363	869178	5 Wikitoria Lane, Warkworth
Lot 2 Deposited Plan 150324 and Section 10 Survey Office Plan 476652	694509	80 Great North Road, Warkworth
Lot 29 Deposited Plan 531363, Lot 15 Deposited Plan 531363	869175	11 Wikitoria Lane, Warkworth
Lot 29 Deposited Plan 531363, Lot 13 Deposited Plan 531363	869173	15 Wikitoria Lane, Warkworth
Lot 100 Deposited Plan 559348	984529	56 Victoria Street, Warkworth, 58 Victoria Street, Warkworth, 99A Great North Road, Warkworth, 99 Great North Road, Warkworth
Lot 29 Deposited Plan 531363, Lot 16 Deposited Plan 531363	869176	9 Wikitoria Lane, Warkworth
Section 1 Survey Office Plan 509338	788089	2 State Highway 1, Warkworth
Lot 29 Deposited Plan 531363, Lot 17 Deposited Plan 531363	869177	7 Wikitoria Lane, Warkworth
Lot 29 Deposited Plan 531363, Lot 11 Deposited Plan 531363	869171	12 Wikitoria Lane, Warkworth
Section 4 Survey Office Plan 476652	694504	12 Hudson Road, Warkworth
Lot 29 Deposited Plan 531363, Lot 12 Deposited Plan 531363	869172	14 Wikitoria Lane, Warkworth
Lot 29 Deposited Plan 531363, Lot 8 Deposited Plan 531363	869168	6 Wikitoria Lane, Warkworth
Lot 29 Deposited Plan 531363, Lot 14 Deposited Plan 531363	869174	13 Wikitoria Lane, Warkworth
Lot 29 Deposited Plan 531363, Lot 10 Deposited Plan 531363	869170	10 Wikitoria Lane, Warkworth
Lot 29 Deposited Plan 531363, Lot 19 Deposited Plan 531363	869179	3 Wikitoria Lane, Warkworth
Lot 29 Deposited Plan 531363, Lot 9 Deposited Plan 531363	869169	8 Wikitoria Lane, Warkworth
Lot 29 Deposited Plan 531363, Lot 7 Deposited Plan 531363	869167	4 Wikitoria Lane, Warkworth

ATTACHMENT 2: EXTENT OF DESIGNATION 6761 AND PARTS OF THE DESIGNATION TO BE REMOVED

Full extent of Designation 6764:

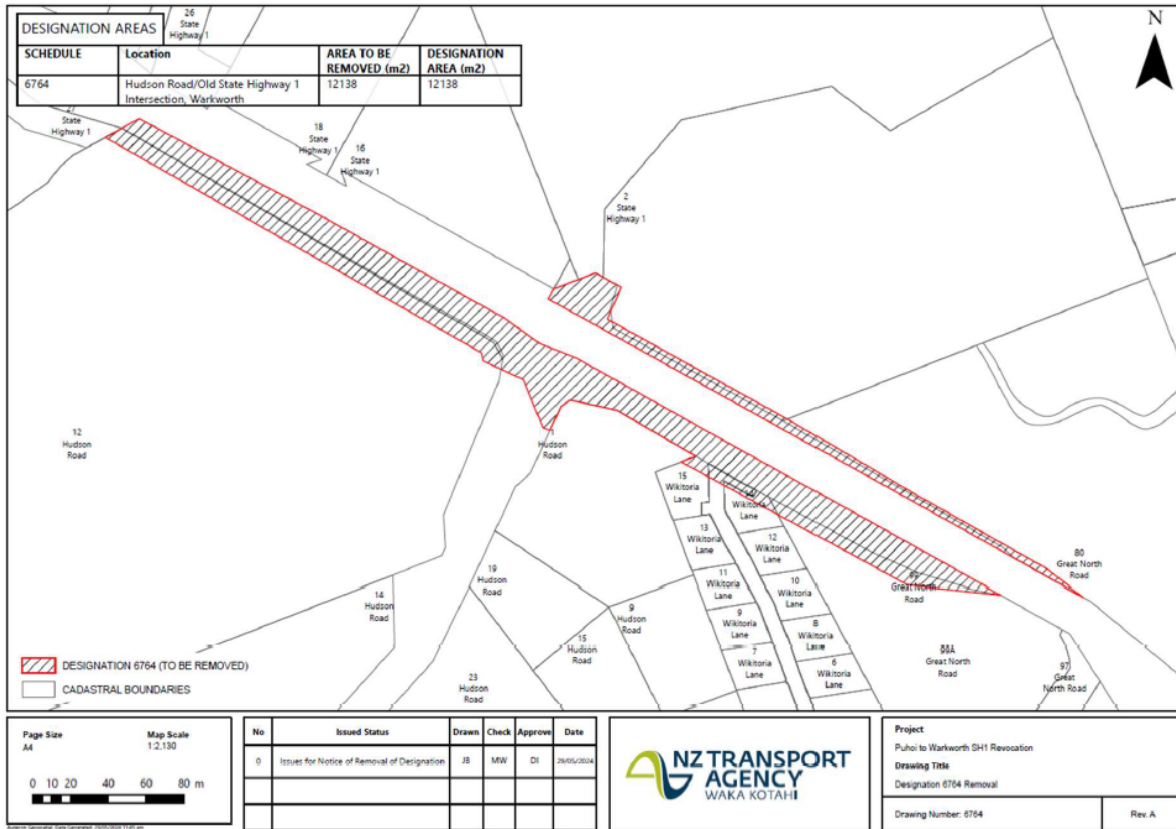

**ATTACHMENT 3: NEW ZEALAND TRANSPORT AGENCY WAKA KOTAHI S182 NOTICE
OF REMOVAL**

3/07/2024

Sarah Wong
Plans & Places Department
Auckland Council
Private Bag 92300
Victoria Street West
Auckland 1142

Dear Sarah,

Removal of the NZ Transport Agency Waka Kotahi State Highway Designation ref 6764, State Highway 1 Road Widening – Hudson Road, Warkworth, Old State Highway 1

Please find enclosed a notice of removal of a designation. Pursuant to Section 182 of the Resource Management Act 1991, NZ Transport Agency Waka Kotahi (NZTA) has determined this designation is no longer required and requests the Auckland Unitary Plan (Operative in Part) be amended to reflect this.

For your information, NZTA has notified all persons considered to be affected by this removal, including any land owners or occupiers.

Please contact me if you have any questions or require further information.

Yours sincerely

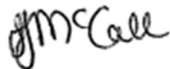

Sonya McCall
Team Lead, Poutiaki Taiao / Environmental Planning
Systems Design
Phone: 021 197 1801
Email: consents@nzta.govt.nz (and copy to sonya.mccall@nzta.govt.nz and Miriam.Williams@aurecongroup.com)

Enc. NZ Transport Agency Waka Kotahi Form 23 – Notice of Removal of Designation under Section 182 of Resource Management Act 1991

REMOVAL OF DESIGNATION

July 2024
 NZ Transport Agency Waka Kotahi
 Designation 6764: Road Widening

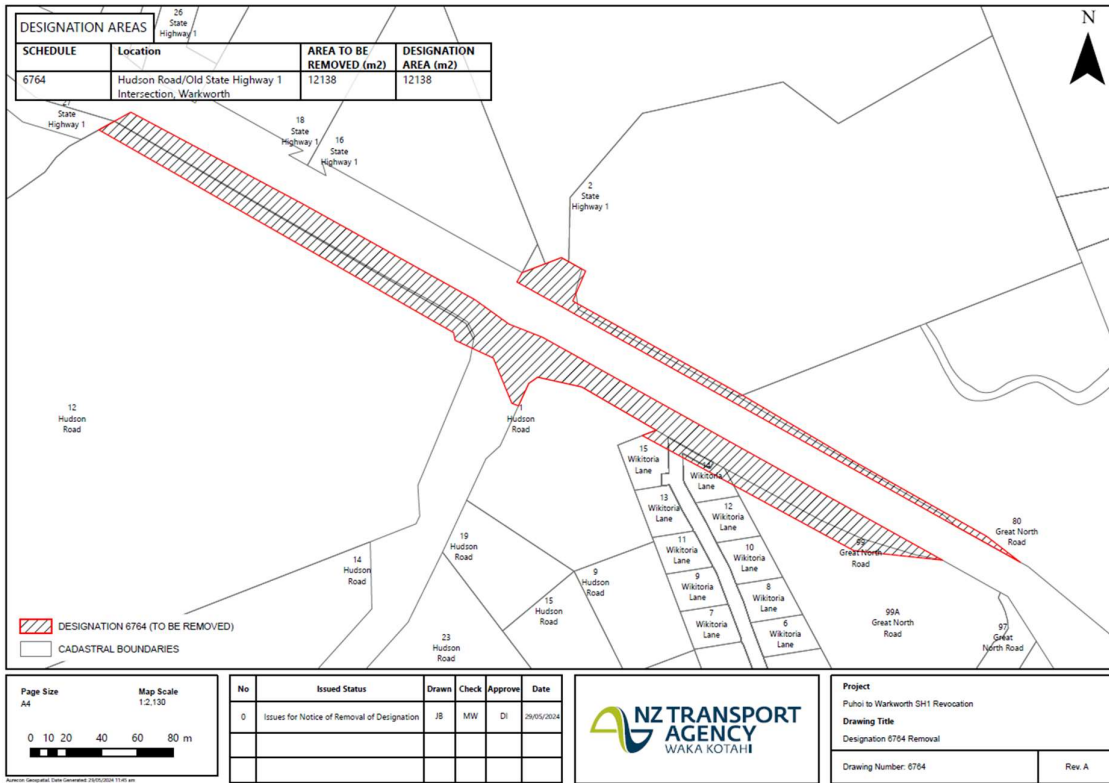

Form 23
Notice of Removal of Designation Under Section 182 of the Resource Management Act 1991

To: Auckland Council
PO Box 92300
Victoria Street West
Auckland 1142

From: NZ Transport Agency Waka Kotahi
PO Box 106602
Auckland 1143

And to: 5 Wikitoria Lane, Warkworth
80 Great North Road, Warkworth
11 Wikitoria Lane, Warkworth
15 Wikitoria Lane, Warkworth
56 Victoria Street, Warkworth, 58 Victoria Street, Warkworth, 99A Great North Road, Warkworth, 99 Great North Road, Warkworth
9 Wikitoria Lane, Warkworth
2 State Highway 1, Warkworth
7 Wikitoria Lane, Warkworth
12 Wikitoria Lane, Warkworth
12 Hudson Road, Warkworth
14 Wikitoria Lane, Warkworth
6 Wikitoria Lane, Warkworth
13 Wikitoria Lane, Warkworth
10 Wikitoria Lane, Warkworth
3 Wikitoria Lane, Warkworth
8 Wikitoria Lane, Warkworth
4 Wikitoria Lane, Warkworth

And to: Auckland Transport
20 Viaduct Harbour Avenue
Auckland 1010

Pursuant to Section 182 of the Resource Management Act 1991 (RMA) NZ Transport Agency Waka Kotahi (NZTA) gives notice that it no longer requires all of designation 6764 included in the Auckland Unitary Plan.

The designation is located where the Old State Highway 1 intersects with Hudson Road in Warkworth, Auckland.

The designation is listed in Chapter K Designations: New Zealand Transport Authority Schedule and shown in the Auckland Unitary Plan GIS viewer. The purpose of the designation is road widening.

The designation is no longer required on the land listed in Table 1 in Attachment A. The area of the designation to be removed is shown on the plan in Attachment B.

The designation to be removed is no longer required for the on-going operation, maintenance or mitigation of effects of the work authorised by the designation.

NZTA requests the Council amend the Auckland Unitary Plan accordingly as required by section 182 of the Resource Management Act 1991.

Signed by:

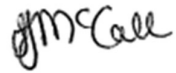

Sonya McCall
Team Lead, Poutiaki Taiao / Environmental Planning
Systems Design
Pursuant to authority delegated by NZ Transport Agency Waka Kotahi
3/07/2024

Address for Service:
Aurecon New Zealand Limited
PO Box 9762
Newmarket
Auckland 1149
Attention: Miriam Williams
Ph: (09) 520 7236
E-mail: Miriam.Williams@aurecongroup.com

Attachment A – Properties subject to removal of designation [or part of designation]

Attachment B – Plan of designation to be removed

Attachment A
Properties subject to removal of designation 6764

1. Land owners/occupiers

The designation is to be removed from the following land:

Legal Description	Certificate of Title	Address
Lot 29 Deposited Plan 531363, Lot 18 Deposited Plan 531363	869178	5 Wikitoria Lane, Warkworth
Lot 2 Deposited Plan 150324 and Section 10 Survey Office Plan 476652	694509	80 Great North Road, Warkworth
Lot 29 Deposited Plan 531363, Lot 15 Deposited Plan 531363	869175	11 Wikitoria Lane, Warkworth
Lot 29 Deposited Plan 531363, Lot 13 Deposited Plan 531363	869173	15 Wikitoria Lane, Warkworth
Lot 100 Deposited Plan 559348	984529	56 Victoria Street, Warkworth, 58 Victoria Street, Warkworth, 99A Great North Road, Warkworth, 99 Great North Road, Warkworth
Lot 29 Deposited Plan 531363, Lot 16 Deposited Plan 531363	869176	9 Wikitoria Lane, Warkworth
Section 1 Survey Office Plan 509338	788089	2 State Highway 1, Warkworth
Lot 29 Deposited Plan 531363, Lot 17 Deposited Plan 531363	869177	7 Wikitoria Lane, Warkworth
Lot 29 Deposited Plan 531363, Lot 11 Deposited Plan 531363	869171	12 Wikitoria Lane, Warkworth
Section 4 Survey Office Plan 476652	694504	12 Hudson Road, Warkworth
Lot 29 Deposited Plan 531363, Lot 12 Deposited Plan 531363	869172	14 Wikitoria Lane, Warkworth
Lot 29 Deposited Plan 531363, Lot 8 Deposited Plan 531363	869168	6 Wikitoria Lane, Warkworth

Lot 29 Deposited Plan 869174 13 Wikitoria Lane, Warkworth
531363, Lot 14
Deposited Plan
531363

Lot 29 Deposited Plan 869170 10 Wikitoria Lane, Warkworth
531363, Lot 10
Deposited Plan
531363

Lot 29 Deposited Plan 869179 3 Wikitoria Lane, Warkworth
531363, Lot 19
Deposited Plan
531363

Lot 29 Deposited Plan 869169 8 Wikitoria Lane, Warkworth
531363, Lot 9
Deposited Plan
531363

Lot 29 Deposited Plan 869167 4 Wikitoria Lane, Warkworth
531363, Lot 7
Deposited Plan
531363

2. Other persons likely to be affected

The following other persons are likely to be affected:

Name	Address	Reason Likely to be Affected
Auckland Transport	20 Viaduct Harbour Avenue Auckland 1010	The state highway status of the Old State Highway 1 between Puhoi and Warkworth will be revoked on 30 June 2024, with ownership passing to Auckland Transport.

Attachment B

Plan of designation to be removed – Designation 6764

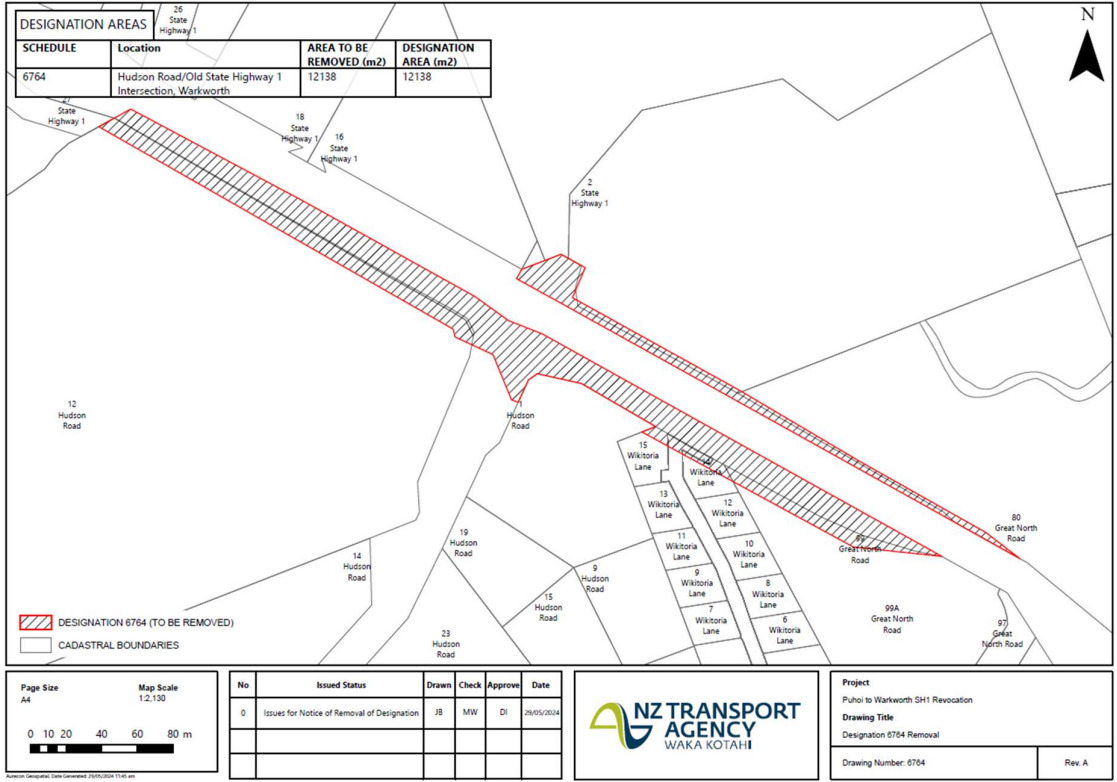

Page Size: A4
 Map Scale: 1:2,150
 0 10 20 40 60 80 m

No	Issued Status	Drawn	Check	Approve	Date
0	Issues for Notice of Removal of Designation	JB	MW	DI	26/05/2014



Project: Puhoi to Warkworth SH1 Revocation
Drawing Title: Designation 6764 Removal
 Drawing Number: 6764 Rev. A

Attachment 3: Removal of designation text
and updated NZTA Schedule
(Strikethrough/Underscore)

Designation Schedule - New Zealand Transport Agency

Number	Purpose	Location
6700	Motorway	State Highway 1 from south of Quarry Road, Drury to Bombay Road, Bombay
6701	Motorway	State Highway 1 from Bombay Road to Mill Road, Bombay
6702	State Highway - declared limited access road	State Highway 1 from Mill Road to south of Beaver Road East (Waikato District Council boundary), Bombay
6703	Road	State Highway 1 at Great South Road on-ramp, Bombay
6704	State Highway - declared limited access road	State Highway 22 (Karaka Road and Paerata Road) from east of Woodlyn Drive, Karaka to Adams Drive, Pukekohe
6705	Land for road widening - 5m where indicated on Map 100, to a minimum width of 30m of road reserve	State Highway 22 (Karaka Road and Paerata Road) from east of Woodlyn Drive, Karaka to Adams Drive, Pukekohe
6706	Motorway purposes Auckland - Hamilton	State Highway 1 from north of Takanini interchange to south of Quarry Road, Drury
6707	State Highway 22	State Highway 22 (Karaka Road and Great South Road) from east of Woodlyn Road, Karaka to State Highway 1,
6708	South Western Motorway (State Highway 20)	State Highway 20 from (1) east of Great south Road, Manukau City Centre to Cavendish Drive interchange, Wiri and from (2) Massey Road to Walmsley Road, Mangere
6709	South Western Motorway (State Highway 20)	State Highway 20 from (1) Manukau Harbour Crossing to Tararata Creek, Mangere and from (2) Massey Road, Mangere to Cavendish Drive interchange, Wiri
6710	Manukau Harbour Crossing	Waterfront Road Reserve, Coronation Road, Rimu Road and Mahunga Drive, Mangere
6712	Airport Motorway (State Highway 20A)	State Highway 20A from Bader Drive to south of Kirkbride Road, Mangere
6713	George Bolt Memorial Drive	State Highway 20A (George Bolt Memorial Drive) from Kirkbride Road to Auckland International Airport,
6714	Southern Motorway (State Highway 1)	State Highway 1 from north of Highbrook Drive, Otara to south of Great South Road, Takanini
6715	Southern Motorway widening East Tamaki Road	State Highway 1 at East Tamaki Road interchange, Otara
6716	South Western Motorway - State Highway 20 (connection to State Highway 1)	State Highway 20 from Great South Road, Manukau City Centre to Cavendish Drive interchange, Wiri
6717	State Highway 20B Road purposes: the maintenance, operation and improvement of the State Highway (including road widening)	State Highway 20 (Puhinui Road) from Puhinui Road interchange to Orrs Road, Puhinui

6718	Motorway	State Highway 1 from (1) Auckland Harbour Bridge, Westhaven to Fanshawe Street, Freemans Bay and from (2) Grafton Road, Grafton to Tamaki River, Otahuhu, and State Highway 16 from (3) Newton Road, Eden Terrace to Whau River bridge, Avondale and State Highway 20 from (4) Hillborough Road, Hillsborough to Manukau Harbour Crossing, Onehunga
6719	Motorway - Shelley Beach Road priority lane	State Highway 1 at Shelly Beach Road, Westhaven
6720	Motorway - Newmarket Viaduct improvement project	State Highway 1 from Gillies Avenue to St Marks Road off-ramp, Newmarket
6721	Motorway - Victoria Park tunnel project	State Highway 1 from Victoria Park, Auckland Central to Shelley Beach Road off-ramp, Westhaven
6722	To alter designation A07-01, SH16, causeway and Rosebank Peninsula	State Highway 16 from the causeway to north of Patiki Road on-ramp, Avondale
6723	To alter designation A07-01, SH16, between Great North Road and St Lukes Interchange ...	State Highway 16 from Great North Road, Avondale to St Lukes Road, Western Springs
6724	The designation provides for the construction, and subsequent operation, maintenance and minor improvement of the motorway	State Highway 16 in the vicinity of (1) Patiki Road, Avondale and (2) Rosebank Road, Avondale
6725	Construction of a public road to provide access to properties at the northern end of Patiki Road	State Highway 16 on Patiki Road, Avondale
6726	For a new designation, SH16, SH20 and Great North underpass – NOR4. A new surface designation for ...	State Highway 20 from Great North Road (in the vicinity of Alverston Street) to the northern portal (vicinity of Great North Road interchange), Waterview
6727	12.2 metre height restriction affecting land within 76.2 meters of the centre line of the Newmarket Viaduct	Vicinity of Newmarket Viaduct (State Highway 1), Newmarket
6728	For a new designation, SH20 tunnels, Great North Road underpass to Alan Wood Reserve ...	State Highway 20 from Alan Wood Reserve, Mt Roskill to Great North Road, Waterview
6729	Proposed motorway; proposed motorway and railway; proposed road, Hayr Road to Richardson Road ...	State Highway 20 from Hillsborough Road, Hillborough to Maioro Street, Mt Roskill
6730	For new designation, SH20, southern tunnel portal to Maioro Street interchange	State Highway 20 from Maioro Street to Alan Wood Reserve, Mt Roskill
6731	The designation is for the following work: ...	State Highway 20 from Queenstown Road, Hillsborough to Ernie Pinches Street, Mt Roskill Hillsborough Road
6732	The designation is for the following work: ...	State Highway 20 from Queenstown Road, Hillborough to Maioro Street, Mt Roskill
6733	The designation is for the following work: ...	State Highway 20 in the vicinity of Earnie Pinches Street, My Roskill

6734	Otahuhu Southern Motorway	State Highway 1 at Otahuhu interchange, Otahuhu
6735	The designation is to include, and allow for, the control of this State Highway, including planning, design, supervision, construction and maintenance ...	State Highway 1 from Wellington Street to Victoria Park, Auckland Central
6736	The designation is to include, and allow for, the control of this State Highway, including planning, design, supervision, construction and maintenance ...	State Highway 1 and 16 from Grafton Road, Grafton to Wellington Street, Auckland Central and State Highway 16 from Parnell Rise to Newton Road, Auckland Central
6738	Alteration to designation NZTA1, SH16, between Whau River and Henderson Creek ...	State Highway 16 from Whau Creek to Henderson Creek, Te Atatu
6740	N/A	State Highway 16 from north end of Fred Taylor Drive to Brighams Creek, Whenuapai
6741	N/A	State Highways 16 from Westgate interchange, Westgate to Brigham Creek Road intersection, Whenuapai and State Highway 18 from Westgate interchange, Westgate to Greenhithe Bridge, Hobsonville
6742	Refer NOR-2010-1559	State Highway 16 from Henderson Creek, Henderson to Huruheru Road Bridge, Massey
6743	Refer NOR-2010-1136	State Highway 16 from west of Huruheru Road bridge, Massey to Westgate interchange, Westgate
6744	N/A	State Highway 16 south of Westgate interchange, Westgate
6747	Motorway administration and maintenance	28 Sulphur Beach Road, Northcote
6748	Auckland Harbour Bridge works depot and anchorage	9 Princes Street, Northcote Point
6749	Auckland Harbour Bridge works depot and anchorage	Queen Street (Pt Allotment 68 TTN of Woodside) , Northcote Point
6750	Auckland-Waiwera Motorway (State Highway 1), including planning, design, supervision, construction and maintenance ...	State Highway 1 from Auckland Harbour Bridge, Northcote to Greville Road interchange, Albany
6751	Proposed Motorway (Auckland/Waiwera Motorway State Highway 1), including planning, design, supervision, construction	State Highway 1 from Greville Road interchange, Albany to Lonely Track Road, Albany
6753	State Highway 18 - the control, management and improvement of the State Highway ...	State Highway 18 from Constellation Drive interchange (State Highway 1) to west of Paul Matthews Road, Rosedale
6756	State Highway 18 - the control, management and improvement of the State Highway ...	State Highway 18 (Upper Harbour Highway) from west of Paul Matthews Road, Rosedale to Upper Harbour Bridge, Greenhithe
6757	The North Shore Busway ...	North Shore Busway from south of Onewa Road interchange, Onewa to Constellation Drive interchange,
6758	Constellation Drive Station ...	Corner Constellation Drive interchange and State Highway 1, Rosedale

6759	Motorway	State Highway 1, Silverdale interchange, Silverdale
6760	Motorway	State Highway 1 from Lonely Track Road, Redvale to Silverdale interchange, Silverdale
6761	Motorway and limited access highway and associated interchange	State Highway 1 from Bankside Road, Silverdale to Titfords Bridge, Puhoi
6762	Quarry Withdrawn	State Highway 1 (Pt Allotment N158 PSH of Mahurangi), Pohuehue
6763	State Highway 1	State Highway 1 from Titfords Bridge, Puhoi to Ross Road (Kaipara District Council boundary), Topuni
6764	Road widening Withdrawn	State Highway 1 intersection with Hudson Road, Warkworth
6765	State Highway 1 / Wayby Valley Road / Wayby Station Road intersection	State Highway 1 intersection with Wayby Station Road and Wayby Valley Road, Wellsford
6766	State Highway 16	State Highway 16 from Brigham Creek, Hobsonville to State Highway 1, Wellsford
6768	Road widening	State Highway 16 (Main Road), Kumeu and Huapai
6769	The construction, operation and maintenance of a State highway (Ara Tūhono - Pūhoi to Wellsford Road of National Significance: Pūhoi to Warkworth Section)	State Highway 1, Puhoi to Warkworth
6770	Construction, operation and maintenance of a component of the State Highway 20A Airport Project	1 Ascot Road, Mangere
6771	Construction, operation and maintenance of a component of the State Highway 20A Airport Project	2 Ascot Road, Mangere
6772	Road widening	State Highway 16 from Brighams Creek Road, Whenuapai to Taupaki Road, Taupaki
6773	To construct, operate and maintain Section 2 (St Johns Road to Meadowbank Train Station) of the Glen Innes to Tamaki Drive proposed shared pedestrian and cycle path.	Pourewa Valley within the area bounded by St Johns Road (St Johns) to the east, Orakei Basin to the west, Whytehead Crescent, Edison Place and John Rymer Place and the Pourewa Creek (Kohimarama) to the north and North Island Main Trunk Line, Purewa Cemetery, Tahapa Crescent and Purewa Road (Meadowbank) to the south.
6774	Construction, operation and maintenance of a State highway, being the East West Link between Onehunga and Ōtāhuhu, and associated works.	Between Onehunga and Ōtāhuhu on the northern side of the Māngere Inlet
6775	The construction, operation and maintenance of the busway and ancillary works including approaches, ramp connections, ancillary safety and operational services (including communications), vegetation removal, stormwater treatment, temporary construction works including storage areas and office facilities, maintenance and access areas, mitigation and restoration, ancillary structures and activities associated with these works.	State Highway 1 – Northern Busway Extension. Adjacent to the east of State Highway 1 from Constellation Bus Station and connection across State Highway 1 to the Albany Bus Station

6776	Shared Use Path – for the construction, operation and maintenance of the Shared Use Path and ancillary works including approaches, ramp connections, ancillary safety and operational services (including communications), vegetation removal, stormwater treatment, temporary construction works including storage areas and office facilities, maintenance and access areas, mitigation and restoration, ancillary structures and activities associated with these works.	State Highway 1 and State Highway 18 Shared Use Path. Adjacent to the east of State Highway 1 from Constellation Bus Station to Oteha Road, adjacent to the north of State Highway 18 from Constellation Drive to Albany Highway, and intermediate linkages to the local network
6777	Weiti Crossing	East Coast Road, Redvale (crossing Weiti River) to corner Whangaparaoa Road and Cedar Road, Whangaparaoa
6778	Designation for the construction, operation and maintenance of a shared path and associated infrastructure.	State Highway 1 from north of Takanini Interchange to south of Quarry Road, Drury; from north of the Papakura Interchange through to Otūwairoa (Slippery Creek) Bridge; from north of Bremner Road to the Drury Interchange.
6779	Construction, operation and maintenance of a new state highway and associated activities between Warkworth and north of Te Hana	Between Warkworth and Te Hana

6762 Quarry – State Highway 1, Pohuehue

Designation Number	6762
Requiring Authority	New Zealand Transport Agency
Location	State Highway 1 (north of Cowan Bay Road), Pohuehue
Rollover Designation	Yes
Legacy Reference	Designation 402, Auckland Council District Plan (Rodney Section) 2011
Lapse Date	Given effect to (i.e. no lapse date)

Purpose

Quarry.

Conditions

No conditions.

Attachments

No attachments.

6764 State Highway 1 Road Widening – Hudson Road, Warkworth

Designation Number	6764
Requiring Authority	New Zealand Transport Agency
Location	State Highway 1 intersection with Hudson Road, Warkworth
Rollover Designation	Yes
Legacy Reference	Designation 404A, Auckland Council District Plan (Rodney Section) 2011
Lapse Date	Given effect to (i.e. no lapse date)

Purpose

Road widening.

Conditions

1. General

1.1 Except as modified by the conditions below and subject to final design, the works shall be undertaken in general accordance with the information provided by the Requiring Authority, being the New Zealand Transport Agency (NZTA), the Notice of Requirement and supporting documents, as follows:

- a. "State Highway 1 Warkworth – Hudson Road/State Highway 1 Intersection Upgrade – Alteration to Designation – "SH 1 Region RS 363, Warkworth Stage 1 Intersection Improvements RP 363/1/31/SH1 and Hudson Road," prepared for NZTA and RDC by Opus International Consultants Ltd, comprising of plans:
 - i. Plans titled "Concept Layout – Sheets 1-5," and referenced "Feature Identifier 1/21/40, Code 6104, Revision RO".

1.2 The period within which this alteration to designation shall lapse if not give effect to shall be 10 years from the date on which it is confirmed in accordance with Section 184(1) of the Resource Management Act, 1991 as amended.

2. Outline Plans of Work and Management Plans

2.1 Prior to the commencement of works, the Requiring Authority shall submit to the Manager Resource Consents, Auckland Council the relevant Management Plans required under Conditions 3 (Construction), 4 (Noise), 6 (Construction Traffic) and 8 (Urban Design and Landscape), below.

2.2 The approval in writing of all the above Management Plans referred to in condition 2.1 above may also, if considered appropriate by the Manager Resource Consents, Auckland Council Council, be deemed to be a waiver, in whole or part, pursuant to Section 176A(2)(c) of the RMA of the requirement for an Outline Plan of Works under section 176A. If such a waiver is sought through the management plan approvals, this should be stated in writing when these management plans are submitted for approval.

2.3 The works shall be undertaken in accordance with the approved Management Plan or accepted Outline Plan of Works (as the case may be).

3. Construction

3.1 At least 10 working days prior to commencement of works on the project, the Requiring

~~Authority shall prepare and submit for approval to the Manager Resource Consents, Auckland Council, a Construction Management Plan (CMP). The purpose of the CMP is to set out the management procedures and construction methods to be undertaken in order to avoid, remedy or mitigate potential adverse effects arising from construction activities. The submission and approval of detailed engineering plans shall also be undertaken through the CMP approval.~~

~~3.2 The CMP shall be implemented and maintained throughout the entire construction period. The CMP shall include specific details relating to the construction and management of all works associated with the Project, including;~~

- ~~a. Details of the site or project manager, including their contact details (phone, facsimile, postal address, e-mail address);~~
- ~~b. The location of large notice boards that clearly identify the name, telephone number and address for service of the site or project manager;~~
- ~~c. An outline construction programme of the works indicating in particular likely time periods for road closures and anticipated traffic diversion effects;~~
- ~~d. A tree protection methodology with arboricultural input, which ensures no damage occurs to the trees along the Showgrounds boundary and the boundary of Lot 1 DP 150324 that are otherwise unaffected by the Project throughout the entire construction period;~~
- ~~e. Any means of protection of services such as pipe and watermains within the legal road;~~
- ~~f. Measures to be adopted to maintain the land in a tidy condition in terms of disposal/storage of rubbish, storage and unloading of building materials and similar construction activities;~~
- ~~g. Location of workers offices and conveniences (e.g. portaloos);~~
- ~~h. Procedures for controlling sediment run-off, dust and the removal of soil, debris and demolition and construction materials from public roads and places. Dust mitigation measures should include use of water sprays to control dust nuisance on dry or windy days;~~
- ~~i. Procedures for ensuring that residents in the immediate vicinity of construction areas are given prior notice of the commencement of construction activities and are informed about the expected duration of the works; and~~
- ~~j. Means of ensuring the safety of the general public.~~

~~3.3 Upon completion of the upgrade project, the Requiring Authority shall submit to the Manager Resource Consents, Auckland Council as built plans in relation to all construction works undertaken as part of the intersection upgrade.~~

4. Noise

Construction Noise

~~4.1 The CMP shall include a Construction Noise and Vibration Management Plan (CNVMP) describing the measures adopted to as far as practicable meet the requirements of the NZS6803:1999 Acoustics — Construction Noise. The CNVMP shall be submitted to and approved by Auckland Council's Environmental Health Officer prior to any works commencing on the upgrade. The CNVMP shall refer to noise management measures set out in Appendix E of NZS6803:1999, and as a minimum shall address the following:~~

- ~~a. Construction sequence;~~
- ~~b. Machinery and equipment to be used;~~
- ~~c. Hours of operation, including time and days when noisy construction work would occur;~~
- ~~d. The design of noise mitigation measures such as temporary barriers or enclosures;~~
- ~~f. Construction noise limits for specific areas;~~
- ~~g. Development of alternative strategies where full compliance with NZS6803:1999 cannot be achieved, including consultation with residents and other occupiers to achieve acceptable outcomes.~~

- ~~h. Methods for monitoring and reporting on construction noise.~~
- ~~i. Onsite contact for local residents and operations;~~
- ~~j. Where an activity is predicted to generate noise levels above the limits prescribed in NZS 6803:1999, the Requiring Authority shall provide a site specific construction noise and vibration management plan. This plan shall describe the noise mitigation and management measures which will be implemented by adopting the best practicable option in accordance with section 16 of the RMA.~~

~~4.2 Every reasonable effort shall be made to notify residents/ occupiers of properties situated within 50m of the construction site in writing at least 3 days prior to the commencement of the proposed works, including information of duration and type of noise activities. A contact telephone number shall be provided to these residents/ occupiers and a complaint monitoring procedure shall be established so that complaints relating to individual contractors are managed centrally.~~

~~Operational Noise~~

~~4.3 A Noise Management Plan (NMP) shall be prepared by a suitably qualified acoustic expert for the purposes of avoiding, mitigating or remedying adverse noise effects from the operation of the project following its construction.~~

~~4.4 The NMP shall include general measures, which shall include but not be limited to the installation of noise attenuation barriers or low noise road surface material, to the extent necessary to achieve at a minimum, compliance with the NZTA (Transit New Zealand) "Guidelines for the Management of Road Traffic Noise — State Highway Improvements" (December 1999).~~

~~Noise Monitoring~~

~~4.5 As required by the NZTA (Transit) Noise Guidelines, measurements of noise levels existing prior to construction shall be used to establish ambient noise levels. The result of 24 hour ambient noise measurements at one (1) position within 50m of the project, together with site maps detailing measurement positions and key data on measurement conditions shall be forwarded to the Council prior to the commencement of construction. Measurements shall be undertaken by a suitably qualified person and the results, together with the site maps and photographs detailing the measurement position and key data, shall be forwarded to the Auckland Council.~~

~~Compliance Monitoring~~

~~4.6 Following completion of the work, the Requiring Authority shall arrange for an appropriately qualified person to undertake monitoring of the level of traffic noise at the above one (1) position for which ambient noise level data has been previously recorded, within a period between 2 and 3 years following completion of construction of the Work, but not post construction of the Western Collector Route. The Requiring Authority shall report the findings of monitoring to the Auckland Council. If as a result of this, non-compliance with the NZTA Guidelines is identified, then specific measures shall be adopted to achieve compliance.~~

5. Vibration

5.1 The CNMVP shall describe how the vibration standards of the German Standard DIN 4150 shall be met as far as practicable, and shall address the following aspects:

- a. Vibration monitoring measures;
- b. Criteria;
- c. Possible mitigation measures;
- d. Complaint response;
- e. Reporting procedures;
- f. Notification and information for the community of the proposed works;

- ~~g. Vibration testing of equipment to conform that the vibration limits will not be exceeded;~~
- ~~h. Location for vibration monitoring when construction activities are adjacent to critical buildings;~~
- ~~i. Operational times;~~
- ~~j. Preparation of dilapidation reports on critical dwellings prior to, during and after completion of works; and~~
- ~~k. Site specific CNVMs where required to address potential exceedances of the vibration standards.~~

Operational Vibration

~~5.2 Vibration levels of the existing operations at the existing State Highway 1 operations shall be measured by a suitable qualified person at not more than one nominated critical location, and submitted to the Auckland Council, prior to the commencement of works. These baseline measurements will provide levels for current use and for comparison with future levels.~~

6. Construction Traffic

~~6.1 The CMP shall include a Temporary Traffic Management Plan (TTMP), for the project, which shall be prepared by a suitably qualified expert(s). The TTMP shall be submitted to and be approved by the Auckland Council prior to the commencement of works.~~

~~6.2 The TTMP shall be implemented and maintained throughout the entire construction period. The TTMP shall include details relating to:~~

- ~~a. Methods of mitigating the local and network wide effects of both construction of individual elements of the Project, and the use of staging to allow sections of the project to be opened to traffic while other sections are still under construction.~~
- ~~b. Methods to manage the effects if the delivery of construction material, plant and machinery.~~
- ~~c. The numbers, frequencies and timing of construction traffic movements.~~
- ~~d. Methods to manage the effects of traffic that is required to detour or be diverted during construction, in particular seeking to minimise effects on residential and commercial areas.~~
- ~~e. Contingencies for traffic diversion.~~
- ~~f. Consultation with Auckland Council with regard to the most appropriate means for providing access on Council roads within and adjacent to the designation.~~
- ~~g. Identification of any existing on-site parking and manoeuvring areas which are affected by the works. Then, as far as practicable, and in consultation with Auckland Council and the affected land owner, identify how the affected areas will be relocated or reinstated to achieve compliance with the Auckland Unitary Plan or to similar standard to that existing.~~
- ~~h. Where necessary, provision of alternative access arrangements as far as practicable, and in consultation with Auckland Council and the affected landowner.~~
- ~~i. Details on the maintenance of pedestrian access and thoroughfare to be maintained on all roads and footpaths adjacent to the construction works where practicable. Such access shall be safe and clearly identifiable. Specific measures shall also be provided to mitigate the effects of construction works on pedestrians and cyclists.~~
- ~~j. Consistency with the NZTA (Transit New Zealand) "Code of Practice for Temporary Traffic Management" (COPTTM).~~
- ~~k. Provision of pedestrian access/egress to properties adjacent to the works at all times.~~

7. Archaeological and Heritage

~~7.1 Subject to condition 7.2, if any archaeological sites, including human remains are exposed during site works then the following procedures shall apply:~~

- ~~a. Immediately after it becomes apparent that an archaeological or traditional site has been exposed, all site works in the immediate vicinity shall cease;~~
- ~~b. The Requiring Authority shall immediately secure the area so that any artefacts or remains are untouched; and~~
- ~~c. The Requiring Authority shall notify tangata whenua, Heritage New Zealand and the Auckland~~

~~Council (and in the case of human remains, the New Zealand Police) as soon as practicable that an archaeological site has been exposed so that appropriate action can be taken. Works shall not commence in the immediate vicinity of the archaeological site until any approval required from Heritage New Zealand is obtained.~~

~~7.2 Condition 7.1 shall not apply where the Requiring Authority holds all relevant approvals under the Heritage New Zealand Pouhere Taonga Act 2014, apart from the requirement to contact the New Zealand Police in the event of discovery of human remains.~~

8. Urban Design and Landscape Mitigation

~~8.1 Prior to the commencement of works on the project, the Requiring Authority shall submit to the Auckland Council and have approved in writing an “Urban Design and Landscape Mitigation Plan” (UDLMP).~~

~~This UDLMP shall be prepared by a suitably qualified expert(s) and shall take into account the following:~~

- ~~a. NZTA’s “Guidelines for Highway Landscaping” (September 2006); and~~
- ~~b. NZTA’s Bridging the Gap: NZTA Urban Design Guidelines (2013)~~

~~8.2 The UDLMP shall in particular provide for:~~

- ~~a. The integration of the permanent works into the surrounding landscape;~~
- ~~b. Mitigation of effects on properties in the vicinity of the alignment;~~
- ~~c. Pedestrian and cycle linkages proposed in respect of the project;~~
- ~~d. Retention or relocation of existing trees where practicable;~~
- ~~e. Replacement planting or mitigation for loss of trees that are protected by the general provisions of the District Plan; and~~
- ~~f. The outcomes of any consultation undertaken with the Auckland Council.~~

~~8.3 The UDLMP shall be prepared in general accordance with the “Landscape Mitigation Plans” prepared by Opus International Consultants Limited, referenced PA2847-SH1, dated June 2009, and shall include the following:~~

- ~~a. An Urban Design Framework that depicts the overall urban design concept, the design intent, layout and mitigation proposals, and~~
- ~~b. Landscape and Urban Design Details — these shall include:
 - ~~i. Identification of vegetation to be retained and removed;~~
 - ~~ii. Proposed planting, including plant species, mixes, spacing/densities, sizes (large specimen trees shall be used, of at least pb95 size at time of planting) and layout,~~
 - ~~iii. Planting programme — the staging of planting in relation to the construction programme; and~~
 - ~~vi. A maintenance programme providing specific measures as how the planting will be maintained following its establishment for 3 years thereafter for specimen trees and for 2 years thereafter for other planting.~~~~

~~8.4 The works as set out in the UDLMP shall be implemented as soon as practicable and works shall be completed no later than 12 months after the practical completion date of the Project.~~

Advice Notes

~~1. The Requiring Authority needs to obtain all other necessary consents and permits and comply with all relevant Council bylaws.~~

~~2. Under the Heritage New Zealand Pouhere Taonga Act 2014, an Authority is required from~~

~~Heritage New Zealand before any work commences which may destroy damage or modify the whole or any part of an archaeological site or sites.~~

~~3. Applications for resource consent to the Auckland Council will be sought for the following activities:~~

~~a. Earthworks; and~~

~~b. Stormwater discharge.~~

~~4. The Requiring Authority (NZTA) proposes to undertake the works authorised by these designation conditions as a joint project with the Auckland Transport which is the relevant Requiring Authority for the related local road improvements. Auckland Transport has a separate (but nearly identical) set of designation conditions authorising the works for which it is responsible.~~

Attachments

~~No attachments.~~

Attachment 4: NZTA Schedule (Clean)

Designation Schedule - New Zealand Transport Agency

Number	Purpose	Location
6700	Motorway	State Highway 1 from south of Quarry Road, Drury to Bombay Road, Bombay
6701	Motorway	State Highway 1 from Bombay Road to Mill Road, Bombay
6702	State Highway - declared limited access road	State Highway 1 from Mill Road to south of Beaver Road East (Waikato District Council boundary), Bombay
6703	Road	State Highway 1 at Great South Road on-ramp, Bombay
6704	State Highway - declared limited access road	State Highway 22 (Karaka Road and Paerata Road) from east of Woodlyn Drive, Karaka to Adams Drive, Pukekohe
6705	Land for road widening - 5m where indicated on Map 100, to a minimum width of 30m of road reserve	State Highway 22 (Karaka Road and Paerata Road) from east of Woodlyn Drive, Karaka to Adams Drive, Pukekohe
6706	Motorway purposes Auckland - Hamilton	State Highway 1 from north of Takanini interchange to south of Quarry Road, Drury
6707	State Highway 22	State Highway 22 (Karaka Road and Great South Road) from east of Woodlyn Road, Karaka to State Highway 1,
6708	South Western Motorway (State Highway 20)	State Highway 20 from (1) east of Great south Road, Manukau City Centre to Cavendish Drive interchange, Wiri and from (2) Massey Road to Walmsley Road, Mangere
6709	South Western Motorway (State Highway 20)	State Highway 20 from (1) Manukau Harbour Crossing to Tararata Creek, Mangere and from (2) Massey Road, Mangere to Cavendish Drive interchange, Wiri
6710	Manukau Harbour Crossing	Waterfront Road Reserve, Coronation Road, Rimu Road and Mahunga Drive, Mangere
6712	Airport Motorway (State Highway 20A)	State Highway 20A from Bader Drive to south of Kirkbride Road, Mangere
6713	George Bolt Memorial Drive	State Highway 20A (George Bolt Memorial Drive) from Kirkbride Road to Auckland International Airport,
6714	Southern Motorway (State Highway 1)	State Highway 1 from north of Highbrook Drive, Otara to south of Great South Road, Takanini
6715	Southern Motorway widening East Tamaki Road	State Highway 1 at East Tamaki Road interchange, Otara
6716	South Western Motorway - State Highway 20 (connection to State Highway 1)	State Highway 20 from Great South Road, Manukau City Centre to Cavendish Drive interchange, Wiri
6717	State Highway 20B Road purposes: the maintenance, operation and improvement of the State Highway (including road widening)	State Highway 20 (Puhinui Road) from Puhinui Road interchange to Orrs Road, Puhinui

6718	Motorway	State Highway 1 from (1) Auckland Harbour Bridge, Westhaven to Fanshawe Street, Freemans Bay and from (2) Grafton Road, Grafton to Tamaki River, Otahuhu, and State Highway 16 from (3) Newton Road, Eden Terrace to Whau River bridge, Avondale and State Highway 20 from (4) Hillborough Road, Hillsborough to Manukau Harbour Crossing, Onehunga
6719	Motorway - Shelley Beach Road priority lane	State Highway 1 at Shelly Beach Road, Westhaven
6720	Motorway - Newmarket Viaduct improvement project	State Highway 1 from Gillies Avenue to St Marks Road off-ramp, Newmarket
6721	Motorway - Victoria Park tunnel project	State Highway 1 from Victoria Park, Auckland Central to Shelley Beach Road off-ramp, Westhaven
6722	To alter designation A07-01, SH16, causeway and Rosebank Peninsula	State Highway 16 from the causeway to north of Patiki Road on-ramp, Avondale
6723	To alter designation A07-01, SH16, between Great North Road and St Lukes Interchange ...	State Highway 16 from Great North Road, Avondale to St Lukes Road, Western Springs
6724	The designation provides for the construction, and subsequent operation, maintenance and minor improvement of the motorway	State Highway 16 in the vicinity of (1) Patiki Road, Avondale and (2) Rosebank Road, Avondale
6725	Construction of a public road to provide access to properties at the northern end of Patiki Road	State Highway 16 on Patiki Road, Avondale
6726	For a new designation, SH16, SH20 and Great North underpass – NOR4. A new surface designation for ...	State Highway 20 from Great North Road (in the vicinity of Alverston Street) to the northern portal (vicinity of Great North Road interchange), Waterview
6727	12.2 metre height restriction affecting land within 76.2 meters of the centre line of the Newmarket Viaduct	Vicinity of Newmarket Viaduct (State Highway 1), Newmarket
6728	For a new designation, SH20 tunnels, Great North Road underpass to Alan Wood Reserve ...	State Highway 20 from Alan Wood Reserve, Mt Roskill to Great North Road, Waterview
6729	Proposed motorway; proposed motorway and railway; proposed road, Hayr Road to Richardson Road ...	State Highway 20 from Hillsborough Road, Hillborough to Maioro Street, Mt Roskill
6730	For new designation, SH20, southern tunnel portal to Maioro Street interchange	State Highway 20 from Maioro Street to Alan Wood Reserve, Mt Roskill
6731	The designation is for the following work: ...	State Highway 20 from Queenstown Road, Hillsborough to Ernie Pinches Street, Mt Roskill Hillsborough Road
6732	The designation is for the following work: ...	State Highway 20 from Queenstown Road, Hillborough to Maioro Street, Mt Roskill
6733	The designation is for the following work: ...	State Highway 20 in the vicinity of Earnie Pinches Street, My Roskill

6734	Otahuhu Southern Motorway	State Highway 1 at Otahuhu interchange, Otahuhu
6735	The designation is to include, and allow for, the control of this State Highway, including planning, design, supervision, construction and maintenance ...	State Highway 1 from Wellington Street to Victoria Park, Auckland Central
6736	The designation is to include, and allow for, the control of this State Highway, including planning, design, supervision, construction and maintenance ...	State Highway 1 and 16 from Grafton Road, Grafton to Wellington Street, Auckland Central and State Highway 16 from Parnell Rise to Newton Road, Auckland Central
6738	Alteration to designation NZTA1, SH16, between Whau River and Henderson Creek ...	State Highway 16 from Whau Creek to Henderson Creek, Te Atatu
6740	N/A	State Highway 16 from north end of Fred Taylor Drive to Brighams Creek, Whenuapai
6741	N/A	State Highways 16 from Westgate interchange, Westgate to Brigham Creek Road intersection, Whenuapai and State Highway 18 from Westgate interchange, Westgate to Greenhithe Bridge, Hobsonville
6742	Refer NOR-2010-1559	State Highway 16 from Henderson Creek, Henderson to Huruheru Road Bridge, Massey
6743	Refer NOR-2010-1136	State Highway 16 from west of Huruheru Road bridge, Massey to Westgate interchange, Westgate
6744	N/A	State Highway 16 south of Westgate interchange, Westgate
6747	Motorway administration and maintenance	28 Sulphur Beach Road, Northcote
6748	Auckland Harbour Bridge works depot and anchorage	9 Princes Street, Northcote Point
6749	Auckland Harbour Bridge works depot and anchorage	Queen Street (Pt Allotment 68 TTN of Woodside) , Northcote Point
6750	Auckland-Waiwera Motorway (State Highway 1), including planning, design, supervision, construction and maintenance ...	State Highway 1 from Auckland Harbour Bridge, Northcote to Greville Road interchange, Albany
6751	Proposed Motorway (Auckland/Waiwera Motorway State Highway 1), including planning, design, supervision, construction	State Highway 1 from Greville Road interchange, Albany to Lonely Track Road, Albany
6753	State Highway 18 - the control, management and improvement of the State Highway ...	State Highway 18 from Constellation Drive interchange (State Highway 1) to west of Paul Matthews Road, Rosedale
6756	State Highway 18 - the control, management and improvement of the State Highway ...	State Highway 18 (Upper Harbour Highway) from west of Paul Matthews Road, Rosedale to Upper Harbour Bridge, Greenhithe
6757	The North Shore Busway ...	North Shore Busway from south of Onewa Road interchange, Onewa to Constellation Drive interchange,
6758	Constellation Drive Station ...	Corner Constellation Drive interchange and State Highway 1, Rosedale

6759	Motorway	State Highway 1, Silverdale interchange, Silverdale
6760	Motorway	State Highway 1 from Lonely Track Road, Redvale to Silverdale interchange, Silverdale
6761	Motorway and limited access highway and associated interchange	State Highway 1 from Bankside Road, Silverdale to Tiffords Bridge, Puhoi
6762	Withdrawn	
6763	State Highway 1	State Highway 1 from Tiffords Bridge, Puhoi to Ross Road (Kaipara District Council boundary), Topuni
6764	Withdrawn	
6765	State Highway 1 / Wayby Valley Road / Wayby Station Road intersection	State Highway 1 intersection with Wayby Station Road and Wayby Valley Road, Wellsford
6766	State Highway 16	State Highway 16 from Brigham Creek, Hobsonville to State Highway 1, Wellsford
6768	Road widening	State Highway 16 (Main Road), Kumeu and Huapai
6769	The construction, operation and maintenance of a State highway (Ara Tūhono - Pūhoi to Wellsford Road of National Significance: Pūhoi to Warkworth Section)	State Highway 1, Puhoi to Warkworth
6770	Construction, operation and maintenance of a component of the State Highway 20A Airport Project	1 Ascot Road, Mangere
6771	Construction, operation and maintenance of a component of the State Highway 20A Airport Project	2 Ascot Road, Mangere
6772	Road widening	State Highway 16 from Brighams Creek Road, Whenuapai to Taupaki Road, Taupaki
6773	To construct, operate and maintain Section 2 (St Johns Road to Meadowbank Train Station) of the Glen Innes to Tamaki Drive proposed shared pedestrian and cycle path.	Pourewa Valley within the area bounded by St Johns Road (St Johns) to the east, Orakei Basin to the west, Whytehead Crescent, Edison Place and John Rymer Place and the Pourewa Creek (Kohimarama) to the north and North Island Main Trunk Line, Purewa Cemetery, Tahapa Crescent and Purewa Road (Meadowbank) to the south.
6774	Construction, operation and maintenance of a State highway, being the East West Link between Onehunga and Ōtāhuhu, and associated works.	Between Onehunga and Ōtāhuhu on the northern side of the Māngere Inlet
6775	The construction, operation and maintenance of the busway and ancillary works including approaches, ramp connections, ancillary safety and operational services (including communications), vegetation removal, stormwater treatment, temporary construction works including storage areas and office facilities, maintenance and access areas, mitigation and restoration, ancillary structures and activities associated with these works.	State Highway 1 – Northern Busway Extension. Adjacent to the east of State Highway 1 from Constellation Bus Station and connection across State Highway 1 to the Albany Bus Station

6776	Shared Use Path – for the construction, operation and maintenance of the Shared Use Path and ancillary works including approaches, ramp connections, ancillary safety and operational services (including communications), vegetation removal, stormwater treatment, temporary construction works including storage areas and office facilities, maintenance and access areas, mitigation and restoration, ancillary structures and activities associated with these works.	State Highway 1 and State Highway 18 Shared Use Path. Adjacent to the east of State Highway 1 from Constellation Bus Station to Oteha Road, adjacent to the north of State Highway 18 from Constellation Drive to Albany Highway, and intermediate linkages to the local network
6777	Weiti Crossing	East Coast Road, Redvale (crossing Weiti River) to corner Whangaparaoa Road and Cedar Road, Whangaparaoa
6778	Designation for the construction, operation and maintenance of a shared path and associated infrastructure.	State Highway 1 from north of Takanini Interchange to south of Quarry Road, Drury; from north of the Papakura Interchange through to Otūwairoa (Slippery Creek) Bridge; from north of Bremner Road to the Drury Interchange.
6779	Construction, operation and maintenance of a new state highway and associated activities between Warkworth and north of Te Hana	Between Warkworth and Te Hana

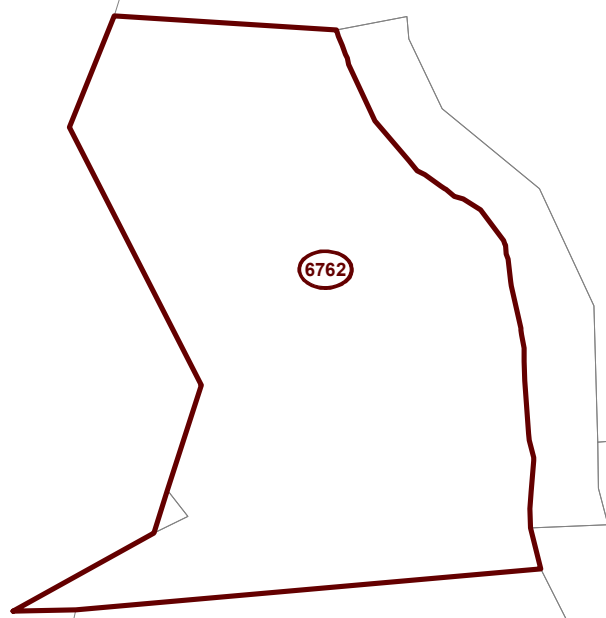

Attachment 5: Designation 6762 & 6764
GIS viewer map (to be removed).

BEFORE



AFTER

Legend

-  Designation
-  Parcel boundary

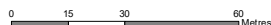

Whilst due care has been taken, Auckland Council gives no warranty as to the accuracy and completeness of any information on this map/plan and accepts no liability for any error, omission or use of the information.

Date: 31/07/2024

Removal of Designation 6762

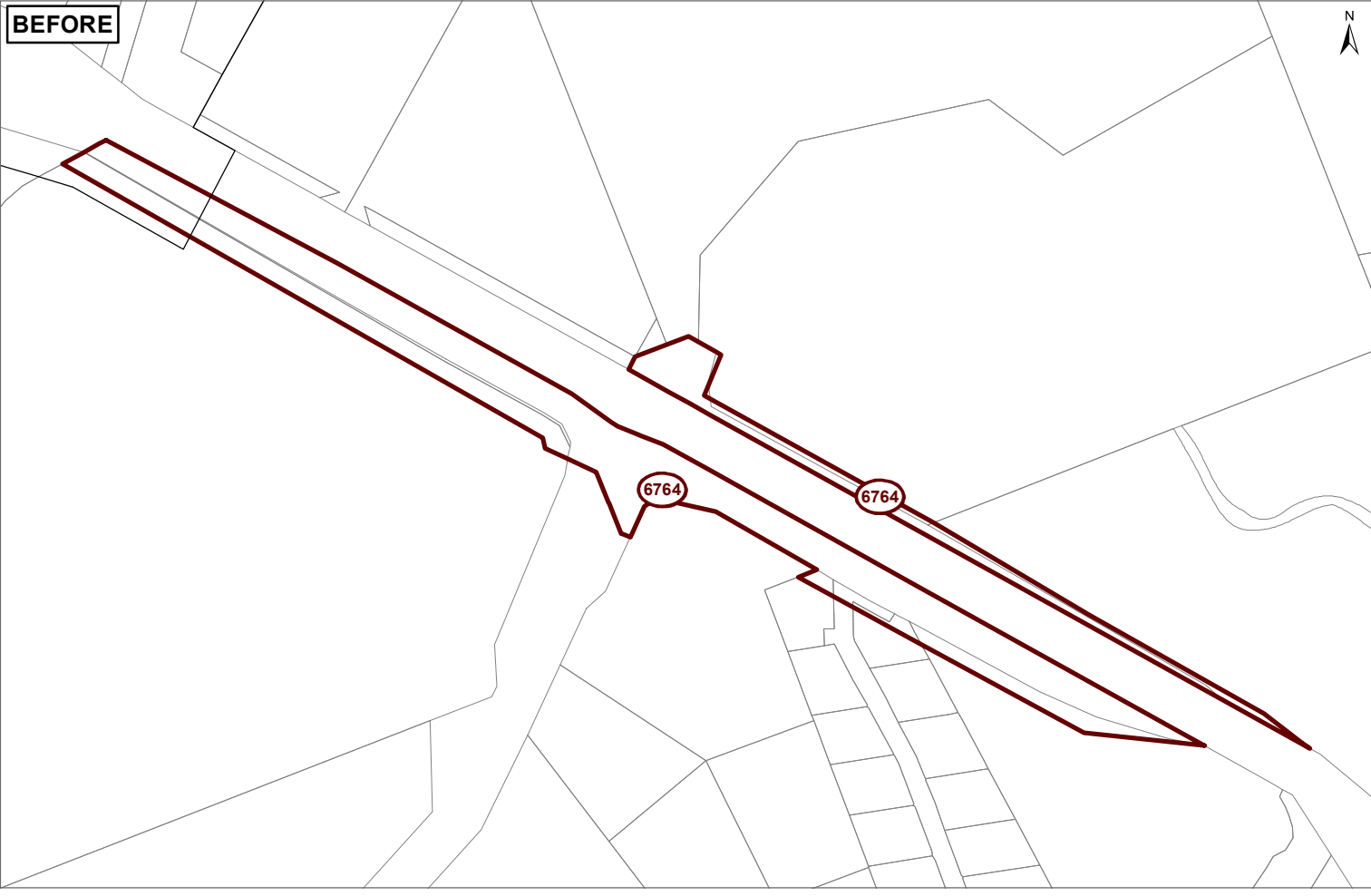

BEFORE



AFTER



Legend

-  Parcel boundary
-  Designations

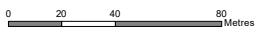

Whilst due care has been taken, Auckland Council gives no warranty as to the accuracy and completeness of any information on this map/plan and accepts no liability for any error, omission or use of the information.
Date: 31/07/2024

Removal of Designation 6764

Auckland Council
Te Kaunihera o Tāmaki Makaurau



Plans and Places